

- 1.0 PERFORMANCE: (sea level)
 1.1 FREQUENCY RANGE: DC-4 GHz
 1.2 VOLTAGE RATING: 50 Vrms
 1.3 NOMINAL IMPEDANCE: 50 OHMS
 1.4 DW: 1,500 Vrms @ 60 Hz
 1.5 TEMPERATURE RANGE: -65 TO +165°C

- 2.0 MATERIALS:
 2.1 BODY: SS-303
 2.2 DIELECTRIC: PTFE
 2.3 CONTACT: BeCu
 2.4 LOCK WASHER: PHOS. BRONZE
 2.5 HEX NUT: BRASS
 2.6 O-RINGS: Si RUBBER

3.0 FINISHES: (see table)

- 4.0 MECHANICAL
 4.1 INTERFACES PER MIL-STD-348
 4.2 PRESSURIZED TO 15 PSI

DWG NO. OL-0910-103-1		REV. C
PART NUMBER	BODY	CONTACT
0910-103-PJ	PASSIVATE	GOLD/Ni

PLATING PER SAN-TRON SPEC. 7.3.1-8

DO NOT SCALE DRAWING

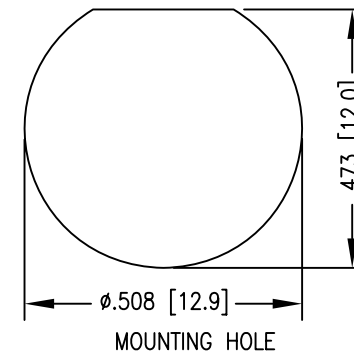
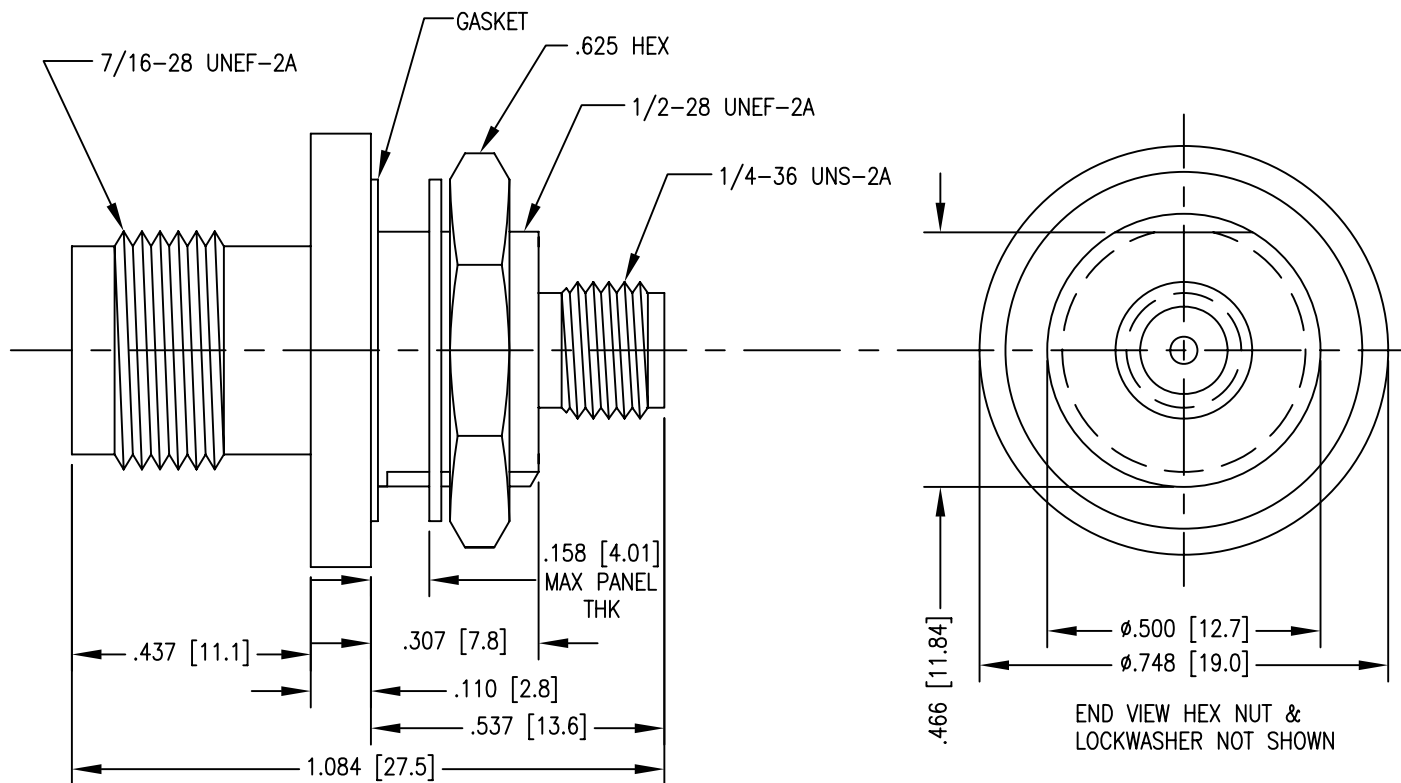

Rev.	Revisions	Disp.	Date	Dwn.	Appd.
C	UPDATED BODY MATERIAL FROM BRASS TO SS-303	NEW	2/4/09	JTH	FSH
B	INCREASED THREAD LENGTH FROM .269 TO .307 FOR PANEL, .687 HEX FLANGE CHANGED TO Ø.748 (19mm)	NEW	2/3/09	JTH	FSH
A	PRODUCTION RELEASE	NEW	2/2/09		

THIS DRAWING CONTAINS CONFIDENTIAL INFORMATION PROPRIETARY TO SAN-TRON, INC. IT MUST NOT BE REPRODUCED OR DISCLOSED TO OTHERS OR USED IN ANY OTHER WAY, IN WHOLE OR PART EXCEPT AS AUTHORIZED IN WRITING BY SAN-TRON, INC.

UNLESS OTHERWISE SPECIFIED:
 ALL DIMENSIONS ARE IN INCHES.
 ALL DIMENSIONS ARE AFTER PLATING.
 .XXX = ±.005 ALL MACHINED SURFACES 63√ MAX.
 .XX = ±.01 ANG. ±1/2° FRACTIONAL = ±1/64

Ⓢ.004 MAX. TIR ⊥ AXIS .001

THIRD ANGLE PROJECTION

DWN	FSH	1/29/09
CHKD	SJS	1/29/09
APPR	FSH	2/2/09

SAN-TRON, INC.
 4 NEWBURYPORT TPK. IPSWICH MA USA 01938
 TEL: 978-356-1585 FAX: 978-356-1573
 WWW.SANTRON.COM E MAIL: SANTRON@SANTRON.COM

San-Tron

TITLE: ADAPTER, SMA - TNC, PRESSURIZED

MATERIAL: FINISH: SEE TABLE- ALLOW FOR .0002/.0004 PLATING

CAGE CODE: 50896 DWG NO. OL-0910-103-1 REV. C

SCALE: X:X