

# DROP-IN CIRCULATORS / ISOLATORS

**Model CK - \_11825\_411 ISOLATOR**

**Shape and Dimensions**

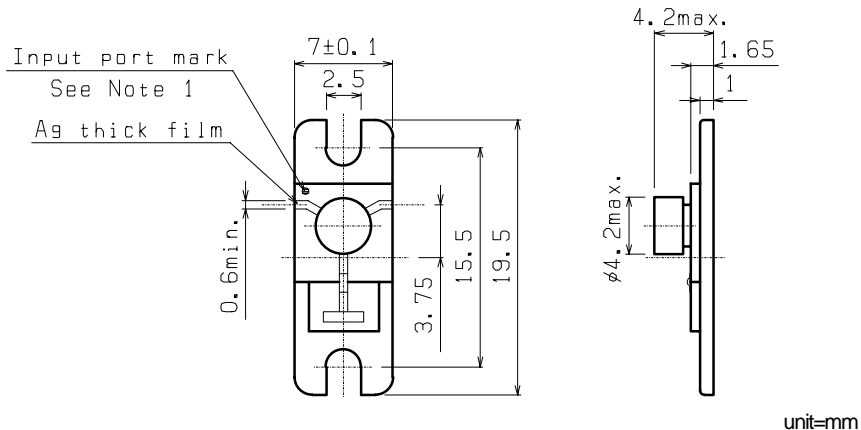

unit=mm

**Characteristics**

Frequency Range	10.5 – 13.0 GHz	Handling Power	5 W CW max.
Isolation	18 dB min.	Power Absorption	1 W CW max.
Insertion Loss	0.5 dB max.	Operating Temperature	-30 / +70 °C
Return Loss (Z <sub>0</sub> =50Ohm) (V.S.W.R.)	19 dB min. ( 1.25 max. )		

**Typical Performance Data**

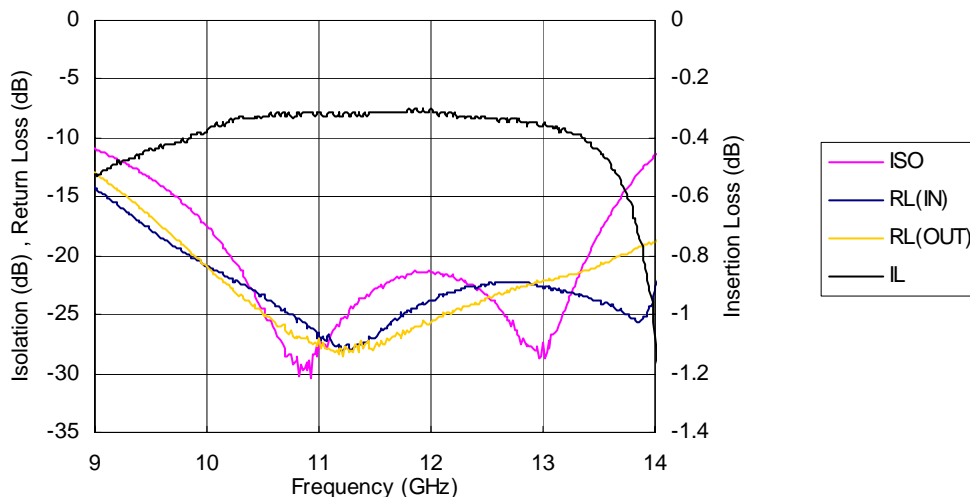

Note 1: Input port mark with white dot.(Ex. : Clockwise ; R)

Note 2: Circulate direction shall be designated by customer.

CK - R14520D411

Material of tab ( D: without tab / H: Cu( Ag gilt ) 2L, 0.6w, 0.03t / M: Au 2L, 0.6w, 0.02t )

Circulate direction ( R : Clockwise / L : Counter clockwise )

