

Waveguide Isolators

Part Number: KTWI500-10

Main Features:

- Broad Frequency Range: 39.2GHz - 59.6GHz
- High Isolation, Low Insertion Loss, Small Size
- Wide Operating Temperature: -40°C~+80°C
- Commercial, Military and Space Applications

Electrical Specifications at Room Temperature:

Part Number	Freq. Range (GHz)	Bandwidth Max. (MHz)	Insertion Loss Max. (dB)	Isolation Min. (dB)	VSWR Max.	Waveguide Type
KTWI500-10	39.2 - 59.6	1000	0.6	25	1.20	WR18
KTWI500-10	39.2 - 59.6	2000	0.6	23	1.25	WR18

Mechanical Dimensions (mm):

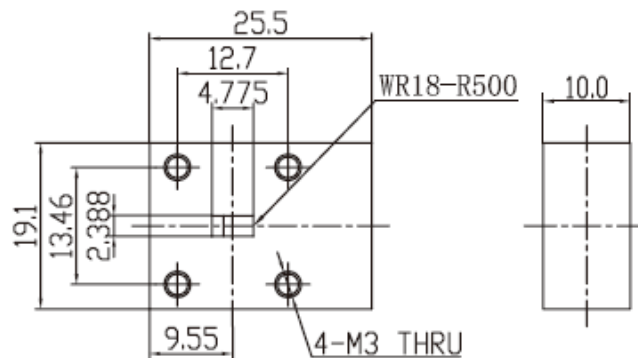

HOW TO ORDER

