

EDGE GUIDE ISOLATOR 3.5-12.8 GHZ SMA F'S

SFI3512

SPECIFICATIONS

ELECTRICAL

FREQUENCY: 3.5-12.8 GHZ
 IMPEDANCE: 50 OHMS
 VSWR: 1.5:1 MAX
 INSERTION LOSS: 2.2 DB MAX
 FORWARD POWER: 2W CW
 REVERSE POWER: 2W CW
 ISOLATION: 17 DB MIN

MECHANICAL

HOUSING: ALUMINUM
 CONNECTORS: SMA-F, STAINLESS STEEL

OPERATING TEMPERATURE: -55°C TO +65°C

CLOCKWISE ROTATION

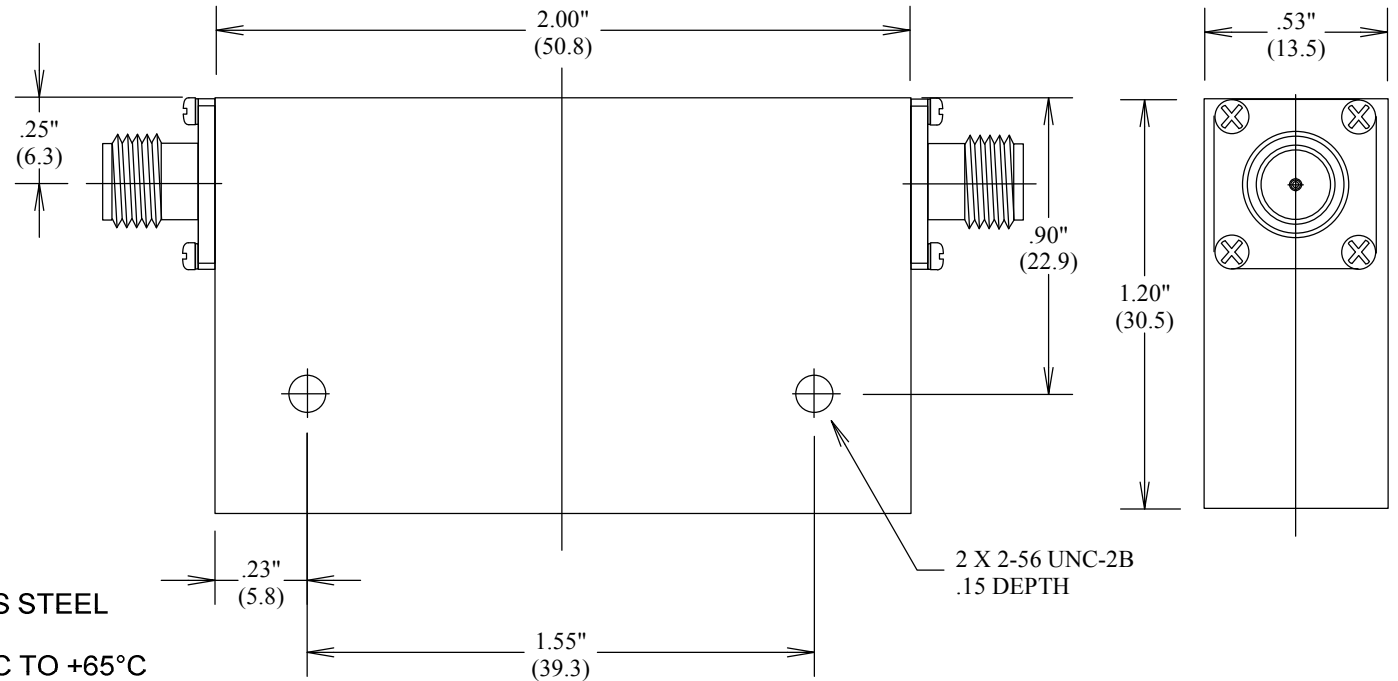

MEASUREMENTS BELOW ARE TYPICAL

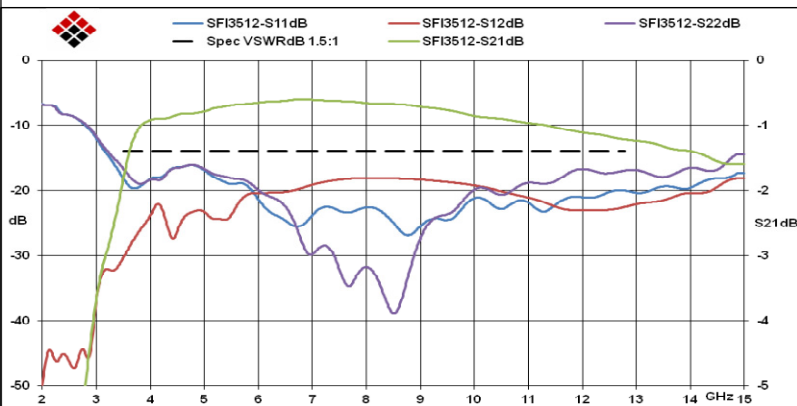

FAIRVIEW MICROWAVE INC.

ALLEN, TX 75013 WWW.FAIRVIEWMICROWAVE.COM

TITLE

EDGE GUIDE ISOLATOR 3.5-12.8 GHZ
 SMA F'S

SIZE

A

CAGE CODE

3FKR5

DWG NO

SFI3512

REV

A

SCALE

SHEET

ALL DIMENSIONS IN inches(mm) Typical