

**Key Features:**

- Center frequency range: 1.7~2.6GHz, bandwidth up to 400MHz
- Low VSWR, high power
- Size: 15.94x6.34x4.19 inches
- WR430 Waveguide, Cover flange type
- Cooling method: Air

**Electrical Specifications**

Part No.	Freq Range MHz	VSWR	CW Power, Watts	Pulse Power Watts	Temp. Range, °C
TW4301-0190-21	1.70-2.10	≤ 1.1:1	≥ 100	30 kWatts	-40 ~ +70
TW4301-0220-18	2.00-2.40	≤ 1.1:1	≥ 100	30 kWatts	-40 ~ +70

**Mechanical Structure:**

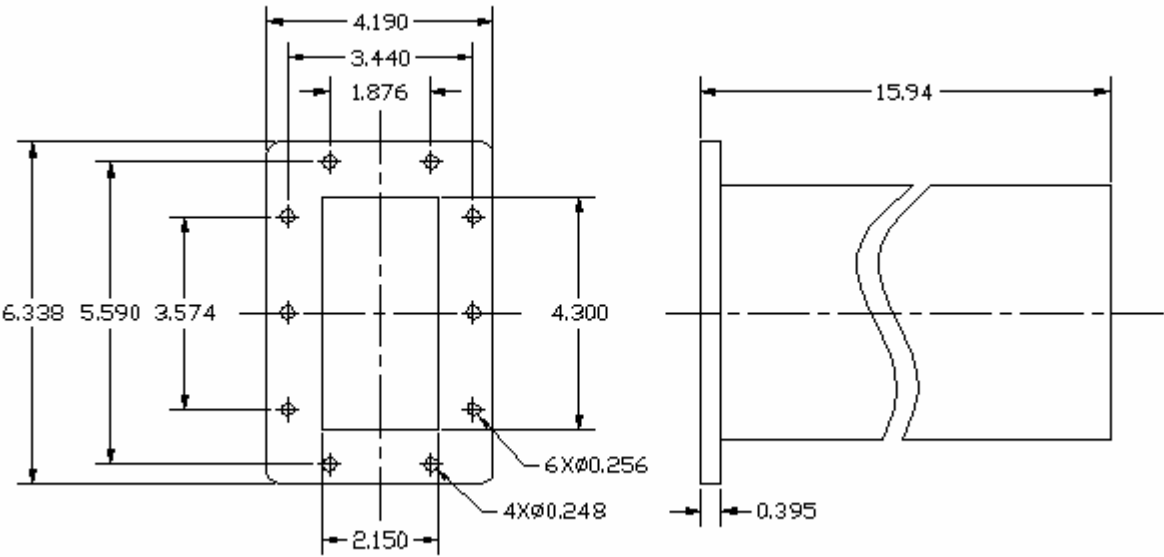

Note: All units in inches

**Ordering Information:**

