

IMPEDANCE MATCHING PADS

Type N (50 Ω) / Type F (75 Ω), DC - 3 GHz, 5.7 dB

SPECIFICATIONS:

Models: 9083-50/75, 9077-50/75, 9089-50/75, 9082-50/75

RoHS
Compliant

AEROFLEX
A passion for performance.

Electrical:

Frequency Range _____ DC - 3 GHz
 Attenuation _____ 5.7 ± 0.5 dB
 VSWR _____ 1.25:1 Max.
 Input Power _____ 2 Watts Avg @ +25°C
 Derated Linearly to 0.5 Watts @ +125°C
 Peak Power _____ 250 Watts Max.
 (5µSec Pulse, .05% Duty Cycle)

Mechanical:

Type N Connectors _____ Passivated Stainless Steel
 Mates with MILSTD-348
 Type F Connectors _____ Nickel Plated Brass
 Housings _____ Passivated Stainless Steel
 Center Contacts _____ Gold Plated Beryllium Copper

Model Number: **9083-50/75**
 Type N Male / Type F Male

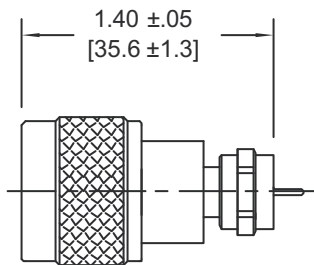

Model Number: **9077-50/75**
 Type N Male / Type F Female

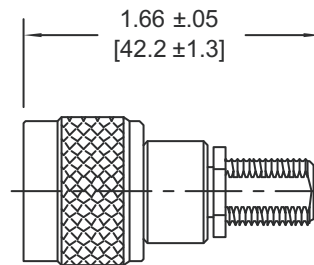

Model Number: **9082-50/75**
 Type N Female / Type F Male

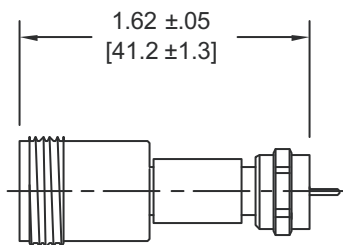

Model Number: **9089-50/75**
 Type N Female / Type F Female

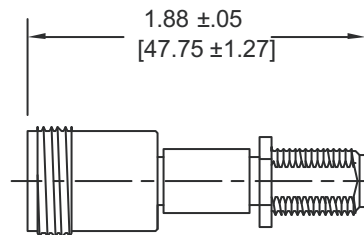

Note: Dimensions in Brackets are Expressed in Millimeters and are for Reference Only.

9083-50/75: REV E



Aeroflex / Inmet, Inc. • 300 Dino Drive, Ann Arbor, MI 48103 • U.S.A.
 888-244-6638 or 734-426-5553 • FAX: 734-426-5557
 www.aeroflex.com/inmet • inmet@aeroflex.com