

- 1.0 PERFORMANCE:  
 1.1 FREQUENCY RANGE DC-18 GHz  
 1.2 VSWR < 1.15  
 1.3 SYSTEM IMPEDANCE 50 OHMS  
 1.4 DWV: 1000 Vrms @ 60 Hz (SEA LEVEL)  
 1.5 VOLTAGE RATING: 335 Vrms (SEA LEVEL)  
 1.6 TEMP RANGE: -65 / +165 °C

- 2.0 MATERIALS  
 2.1 CONTACT: BERYLLIUM COPPER  
 2.2 OTHER METAL PARTS: BRASS  
 2.3 INSULATOR: TEFLON

- 3.0 FINISHES  
 3.1 CONTACT: SEE TABLE  
 3.2 BODY: SEE TABLE

- 4.0 MECHANICAL  
 4.1 INTERFACES PER MIL-STD-348  
 4.2 CONTACT RETENTION: 6 LBS MIN.  
 4.3 DURABILITY: 100 CYCLES

DWG NO. OL-1210-02-1		REV. A
PLATING VARIATIONS		
PART NUMBER	BODY	CONTACT
1210-02-NH	NICKEL	GOLD/Ni
1210-02-FH	Au FUSION	GOLD/Ni

PLATING PER SAN-TRON SPEC. 7.3.1-8

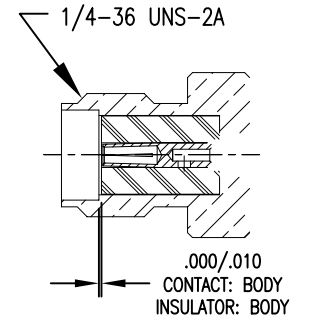
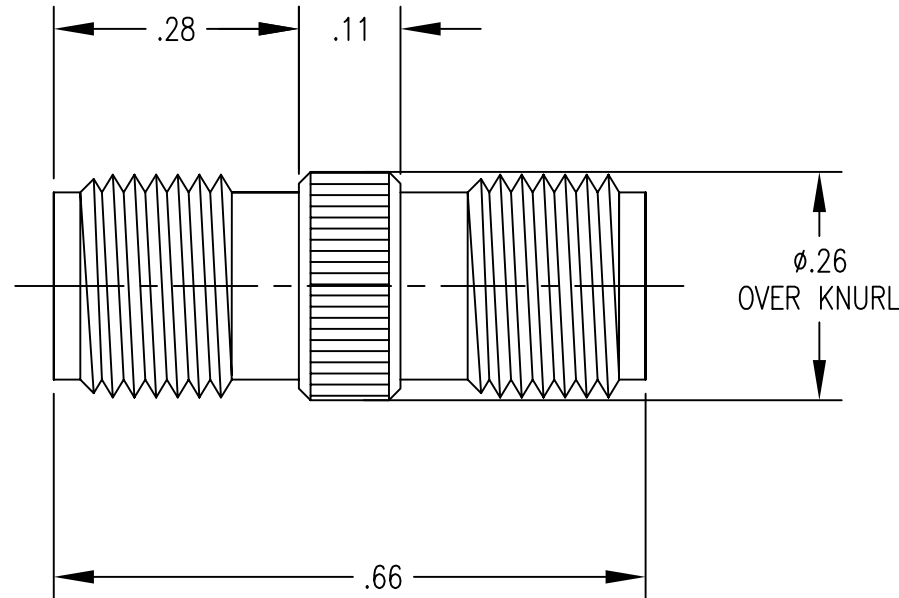

DO NOT SCALE DRAWING

				THIS DRAWING CONTAINS CONFIDENTIAL INFORMATION PROPRIETARY TO SAN-TRON INC. IT MUST NOT BE REPRODUCED OR DISCLOSED TO OTHERS OR USED IN ANY OTHER WAY, IN WHOLE OR PART EXCEPT AS AUTHORIZED IN WRITING BY SAN-TRON INCORPORATED. UNLESS OTHERWISE SPECIFIED: ALL DIMENSIONS ARE IN INCHES. ALL DIMENSIONS ARE AFTER PLATING. .XXX = ±.005 ALL MACHINED SURFACES $63\sqrt{\text{MAX}}$ . .XX = ±.01 ANG. ±1/2° FRACTIONAL = ±1/64 .004 MAX. TIR.      ⊥ AXIS .001						<b>SAN-TRON, INC.</b> 4 NEWBURYPORT TPK. IPSWICH MA USA 01938 TEL: 978 - 356 -1585 FAX: 978 - 356 -1573 WWW. santron.com E MAIL: santron@santron.com			
				TITLE ADAPTER, STRAIGHT SMA (F) TO SMA (F)									
MATERIAL: SEE NOTES				FINISH: SEE NOTES									
DWN LAP 11/1/04 CHKD SJS 11/2/04 APPR FSH 11/1/04				CAGE CODE: 50896				DWG NO. OL-1210-02-1		REV. A			
SCALE X:X													
Rev. A ORIGINAL				NEW 11/1/04									
Revisions				Dis. Date Dwn. Appd.									
Ref.: REMOVE ALL BURRS AND SHARP EDGES .005 MAX.				INTERPRET PER ASME Y14.5M-1994									

