

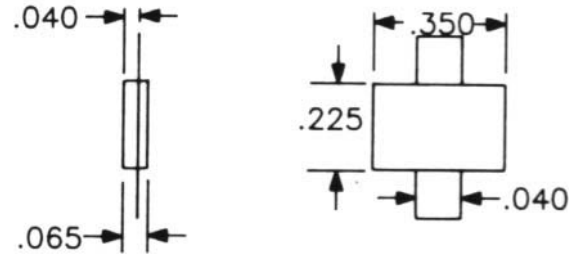

## HIGH POWER BRAZED ATTENUATOR

### 2L100300



| Electrical Specifications |                                      | Material Specifications  |                          | General Specifications      |                                |
|---------------------------|--------------------------------------|--------------------------|--------------------------|-----------------------------|--------------------------------|
| <b>RFT P/N</b>            | 2L100300                             | <b>Substrate</b>         | BeO                      | <b>Mechanical Tolerance</b> | ±.010"                         |
| <b>Power (Watt)</b>       | 100                                  | <b>Backside</b>          | Gold                     | <b>Tolerance (dB)</b>       | DC – 1 GHz: ± .5<br>1-2GHz ± 1 |
| <b>Attenuation (dB)</b>   | 30                                   | <b>Tab</b>               | Nickel with Gold plating | <b>Power Handling</b>       | 100@ 100°C<br>0 W @ 250 °C     |
| <b>Frequency (GHz)</b>    | 2                                    | <b>Cover</b>             | Alumina                  | <b>Construction</b>         | Brazed                         |
| <b>VSWR</b>               | DC – 1 GHz: 1.10:1<br>1-2 GHz:1.25:1 | <b>Resistive Element</b> | NiChrome                 | <b>RoHS Compliance</b>      | Yes                            |

All dimensions are in inches. Minimum lead length 0.125". Other attenuation and tolerance values available.

2245 Fortune Drive, San Jose, CA 95131  
Phone: (408) 433-1941 Fax: (408) 433-1943

Revised:2009-07-17