

Key Features:

- Center frequency range: 2.2~3.3GHz, bandwidth up to 200MHz
- Low VSWR, high power
- Size: 18.00x6.70x6.10 inches
- WR340 Waveguide, Cover flange type
- Cooling method: Air
- Weight ~33 lbs (~15 kg)

Electrical Specifications

Part No.	Freq Range MHz	VSWR	CW Power, Watts	Pulse Power Watts	Temp. Range, °C
TW3404-0240-08	2.30-2.50	≤ 1.1:1	≥ 1500	50 kWatts	-40 ~ +70
TW4304-0290-07	2.80-3.00	≤ 1.1:1	≥ 1500	50 kWatts	-40 ~ +70

Mechanical Structure:

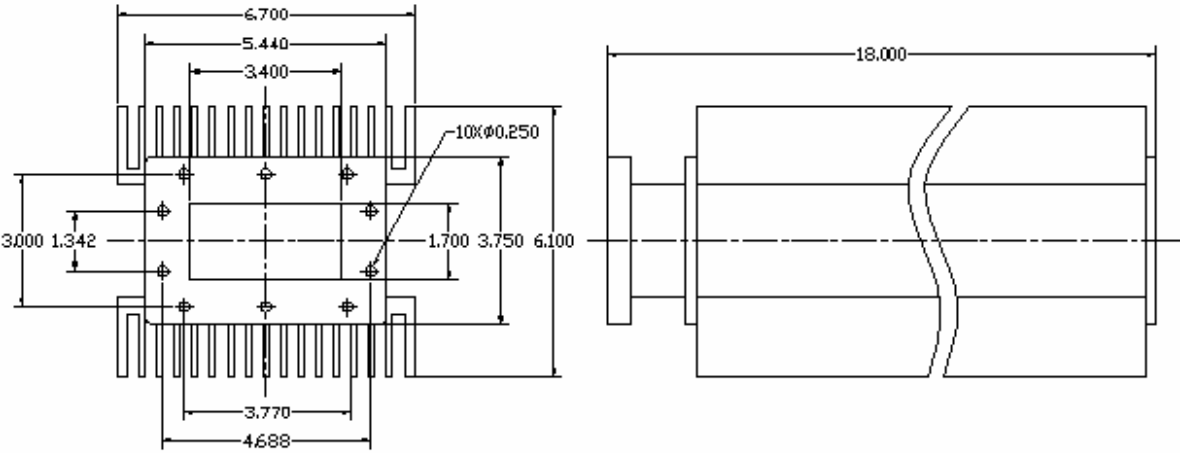

Note: All units in inches

Ordering Information:

