

1.0 PERFORMANCE

- 1.1 FREQUENCY RANGE: DC-8GHz
- 1.2 RL < (-36dB, 1GHz), (-25dB, 4GHz)
(-20dB, 8GHz)
- 1.3 NOMINAL IMPEDANCE: 50 OHMS
- 1.4 DWV: 1000 V RMS @ 60 Hz (sea level)
- 1.5 TEMPERATURE RANGE: -55C TO +155°C
- 1.6 ELECTRICAL LENGTH: 225 psec TYP.
- 1.7 PIM < -165dBc (PLATING CODES -AS & -US)

2.0 MATERIALS

- 2.1 DIELECTRIC: PTFE
- 2.2 CONTACT: BRASS
- 2.3 LOCKING RING: PHOSPHOR BRONZE
- 2.4 OTHER METAL PARTS: BRASS
- 2.5 GASKET: SILICONE RUBBER
- 3.0 FINISHES: SEE TABLE
- 4.0 MECHANICAL
- 4.1 INTERFACE IN ACCORDANCE WITH PER MIL-STD-348
AND IEC 169-4
- 4.2 SOLID OUTER CONTACT
- 4.3 DURABILITY: 500 CYCLES

DWG NO. OL-0910-44-1		REV. G
PART NUMBER	BODY	CONTACT
0910-44-AS	ALBALOY	SILVER
0910-44-NH	NICKEL	Au/Cu
0910-44-US	ALBALOY	SILVER

PLATING PER SAN-TRON SPEC. 7.3.1-8

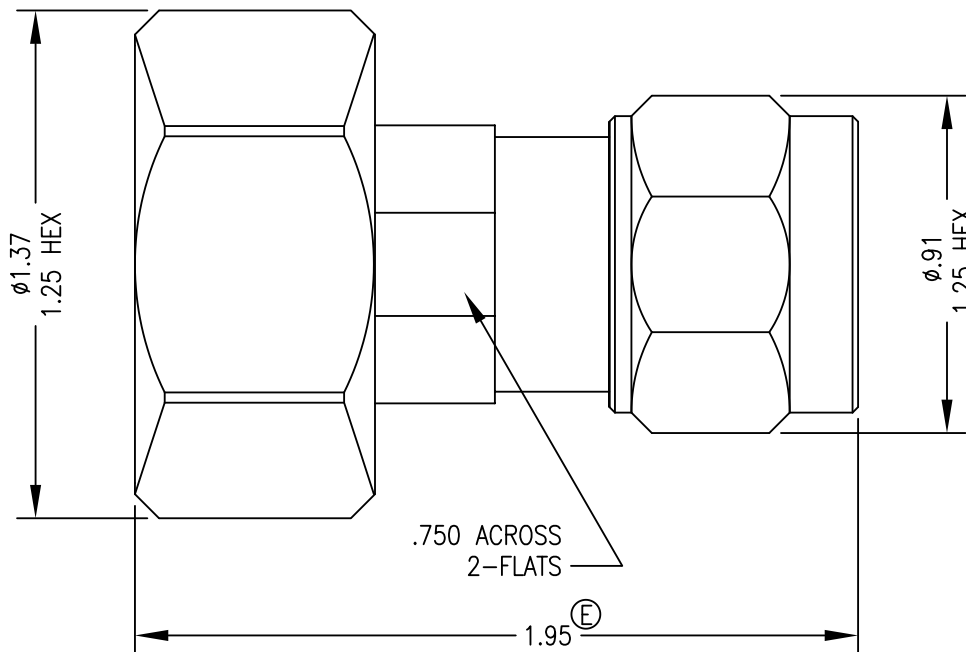

DO NOT SCALE DRAWING

G	UPDATE PERFORMANCE NOTES	MIX	10/5/11	FSH	FSH
F	ADD NOTE 1.9 & 4.2	MIX	2/14/11	FSH	FSH
E	CHG OAL FM 1.69 TO 1.95; ADD NOTE 1.8	SCRP	12/13/10	PRS	FSH
D	PRODUCTION RELEASE	NEW	5/22/08	JTH	*
1	PRELIMINARY: DO NOT MFG	NEW	5/22/08		
Rev.	Revisions	Disp.	Date	Dwn.	Appd.
	Ref.: SK-	REMOVE ALL BURRS AND SHARP EDGES .005 MAX.	INTERPRET PER ASME Y14.5M-1994		

THIS DRAWING CONTAINS CONFIDENTIAL INFORMATION PROPRIETARY TO SAN-TRON, INC. IT MUST NOT BE REPRODUCED OR DISCLOSED TO OTHERS OR USED IN ANY OTHER WAY, IN WHOLE OR PART EXCEPT AS AUTHORIZED IN WRITING BY SAN-TRON, INC.

UNLESS OTHERWISE SPECIFIED:
ALL DIMENSIONS ARE IN INCHES.
ALL DIMENSIONS ARE AFTER PLATING.
.XXX= ±.005 ALL MACHINED SURFACES 32/ MAX.
.XX= ±.01 ANG.±1/2' FRACTIONAL= ±1/64

Ⓞ .004 MAX. TIR. ⊥ AXIS .001

THIRD ANGLE PROJECTION

DWN	JTH	5/22/08
CHKD	**	//
APPR	**	//

SAN-TRON, INC.
4 NEWBURYPORT TPK. IPSWICH MA USA 01938
TEL: 978 - 356 -1585 FAX: 978 - 356 -1573
WWW.santron.com E MAIL: santron@santron.com

San-Tron

TITLE
ADAPTER, STRAIGHT, 7/16 (M) TO N (M)

MATERIAL: SEE NOTES FINISH: SEE TABLE

CAGE CODE: 50896 DWG NO. OL-0910-44-1 REV. G

SCALE X:X