

Coaxial Isolators

Part Number: KTCI401C-100

Main Features:

- Frequency Range: 3.5GHz - 6.0GHz
- Small Size, High Isolation, Low Insertion Loss, High Power Handling
- Wide Operating Temperature: -40°C~+75°C
- Commercial, Military and Space Applications

Electrical Specifications at Room Temperature:

Part Number	Freq. Range (GHz)	Bandwidth Max. (MHz)	Insertion Loss Max. (dB)	Isolation Min. (dB)	VSWR Max.	Reverse Power (W)	Connector Type
KTCI401C-100	3.5 - 6.0	300	0.3	25	1.20	100	SMA/N
KTCI401C-100	3.5 - 6.0	600	0.4	23	1.20	100	SMA/N

Mechanical Dimensions (mm):

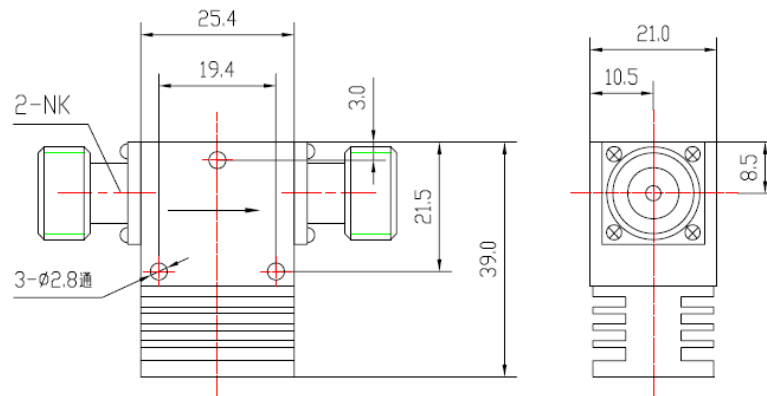

HOW TO ORDER

