

SMP F/F ADAPTER w EMI RINGS

SM2611

SPECIFICATIONS

ELECTRICAL:

FREQUENCY: 0-40 GHZ
VSWR 1.20:1 MAX @ 26.5GHZ
IMPEDANCE: 50 OHMS
OP. TEMP RANGE: -55° to +125°C

MECHANICAL:

MATERIAL BODY: BeCu
CENTER CONTACTS: BeCU
PLATING: Au PER MIL-G-45204
INSULATOR: TEFLON
INTERFACE: SMP DESC 94007

SMP-F
DESC 94007

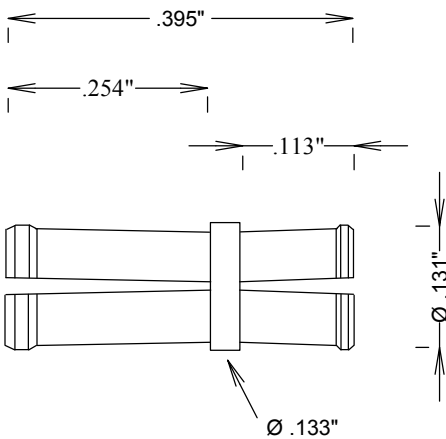

					FAIRVIEW MICROWAVE INC.	
					ALLEN, TX 75013 WWW.FAIRVIEWMICROWAVE.COM	
					TITLE	
					SMP F/F ADAPTER .395" OAL	
SIZE		CAGE CODE	DWG NO		REV	
A		3FKR5	SM2614		--	
SCALE			SHEET			