

DWG NO. OL-3110-01-1		REV. A
PART NUMBER 3110-01-AG	BODY ALBALOY	CONTACT GOLD/Cu

PLATING PER SAN-TRON SPEC. 7.3.1-8

- 1.0 PERFORMANCE (sea level)
- 1.1 FREQUENCY RANGE: DC-6 GHz
- 1.2 VOLTAGE RATING: 335Vrms
- 1.3 NOMINAL IMPEDANCE: 50 OHMS
- 1.4 DWV: 750 Vrms, 60 Hz
- 1.5 TEMPERATURE RANGE: -65 / +165°C

- 2.0 MATERIALS
- 2.1 SOCKET CONTACT: BeCu
- 2.2 DIELECTRIC: PTFE
- 2.3 OUTER CONTACT: BRONZE
- 2.4 ALL OTHER METAL PARTS: BRASS
- 3.0 FINISHES: SEE TABLE

- 4.0 MECHANICAL
- 4.1 DURABILITY 100 CYCLES

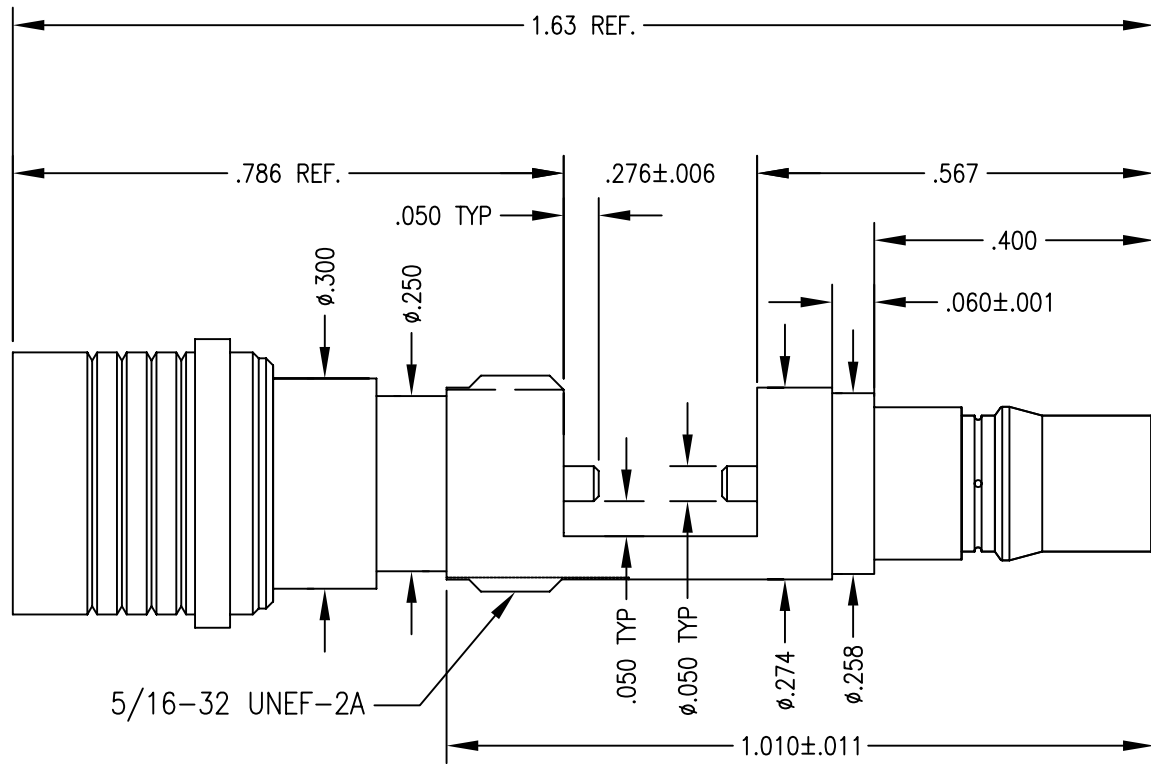

DO NOT SCALE DRAWING

Rev.	Revisions	Disp.	Date	Dwn.	Appd.
A	RELEASE		5/13/08	JTH	FSH
2	PRELIMINARY: DO NOT MFG		4/23/08		
Ref.:	SK-	REMOVE ALL BURRS AND SHARP EDGES .005 MAX.	INTERPRET PER ASME Y14.5M-1994		

THIS DRAWING CONTAINS CONFIDENTIAL INFORMATION PROPRIETARY TO SAN-TRON, INC. IT MUST NOT BE REPRODUCED OR DISCLOSED TO OTHERS OR USED IN ANY OTHER WAY, IN WHOLE OR PART EXCEPT AS AUTHORIZED IN WRITING BY SAN-TRON, INC.

UNLESS OTHERWISE SPECIFIED:
ALL DIMENSIONS ARE IN INCHES.
ALL DIMENSIONS ARE AFTER PLATING.
.XXX = ±.005 ALL MACHINED SURFACES $\frac{32}{\sqrt{\text{MAX.}}}$
.XX = ±.01 ANG. ±1/2° FRACTIONAL = ±1/64
◎.004 MAX. TIR. ⊥ AXIS .001

THIRD ANGLE PROJECTION

DWN	JTH	4/7/08
CHKD	SJS	5/13/08
APPR	FSH	4/7/08



SAN-TRON, INC.
4 NEWBURYPORT TPK. IPSWICH MA USA 01938
TEL: 978 - 356 -1585 FAX: 978 - 356 -1573
WWW.santron.com E MAIL: santron@santron.com

TITLE
QMA, ATTENUATOR HOUSING

MATERIAL:
SEE NOTES

FINISH:
SEE TABLE

CAGE CODE: 50896 DWG NO. OL-3110-01-1 REV. A

SCALE X:X