

GENERAL INFORMATION:

Full Waveguide Frequency Range
 VSWR 1.25 Typ.
 Units Sealed To Hold 10 PSI
 Body Material Aluminum, Copper-Brass Per Order
 Multiple Flange Available Upon Request, See Flange Types
 Type SC Female Precision Connectors
 Finishing Is Corrosion Resistant 316 Stainless Steel Epoxy Coating

ORDERING INFORMATION:

Materials: -A = Aluminum, -B = Copper/Brass
 Flange Type: -1 = CPRF, -2 = CPRG, -6 = Cover, -7 = Choke
 Example Part Number: WC-650C-A-1
 WC = W/G To SC Connector, -650C = W/G Size, -A = Aluminum, -1 = Flange Type

REVISIONS				
ZONE	REV	DESCRIPTION	DATE	APPROVED

STANDARD MODEL NO.	FREQUENCY RANGE (GHz)	W/G SIZE	DIM. -A-	DIM. -B-	DIM. -C-
WC-650C-A-1	1.12-1.17	WR650	2.64	5.00	2.40
WC-430C-A-1	1.70-2.60	WR430	2.09	4.00	2.30
WC-340C-A-1	2.20-3.30	WR340	1.87	3.50	2.29
WC-284C-A-1	2.60-3.95	WR284	1.69	2.50	1.51
WC-229C-A-1	3.30-4.90	WR229	1.57	2.25	1.35
WC-187C-A-1	3.95-5.85	WR187	1.44	2.60	1.90
WC-159C-A-1	4.90-7.05	WR159	1.40	2.33	1.70
WC-137C-A-1	5.85-8.20	WR137	1.31	2.00	1.47
WC-112C-A-1	5.85-8.20	WR112	1.25	1.65	1.18

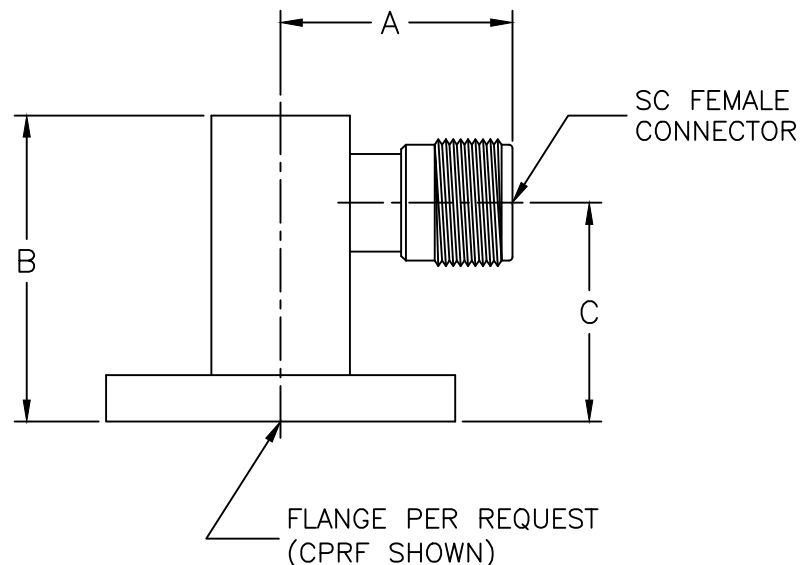

F = FLANGE TYPES

- 1 = CPRG
- 2 = CPRF
- 3 = CMR STANDARD
- 4 = CMR THRU
- 5 = CMR TAP
- 6 = UG-COVER
- 7 = UG-CHOKE
- 8 = UG-COVER/GROOVE
- 9 = PDR
- 10 = UDR

MATERIAL:		MICROWAVE COMMUNICATIONS LABORATORIES INC. 7255 30TH AVE. N. SAINT PETERSBURG, FL 33710 TEL: (727) 344-6254 FAX: (727) 381-6116 http://WWW.MCLI.COM	SCALE:	N/A
			SHEET:	N/A
UNLESS OTHERWISE SPECIFIED: TOLERANCES IN (INCHES) OR [mm] (MILLIMETERS) FRACTIONS: ± 1/64 DECIMALS: ± 0.02 ± 0.015 ANGLE: ± 1/2°		DRAWING TITLE: WAVEGUIDE TO SC ADAPTERS		
DRAWN: Paiboon Luexhamhan		PART NO. WC-C SERIES		
DATE: 05-24-2011		CAGE CODE:	SIZE: A	REV: N/A
APPROVED: T. Nguyen		OD2L5	DWG NO. 85695	
DATE: 05-24-2011		DO NOT SCALE THE DRAWING		

PROPRIETARY NOTICE:
 THE INFORMATION IN THIS DRAWING IS PROPRIETARY
 AND SHALL NOT BE USED OR DISCLOSED WITHOUT WRITTEN
 PERMISSION FROM MICROWAVE COMMUNICATIONS
 LABORATORIES INC. (MCLI)

THIRD ANGLE PROJECTION