

INTEGRATED FLAT PANEL ANTENNA

FPA19-6.8V/1415



ELECTRICAL

FREQUENCY:	6.4 - 7.3 GHz
GAIN:	20 dBi Typ.
POLARISATION:	Linear (Vertical)
BEAMWIDTH:	14.5° (Az) x 14.5° (El) Approx.
CROSS POLAR:	>20 dB Typ.
VSWR:	1.5:1
POWER RATING:	25 W
FRONT TO BACK:	>45 dB

MECHANICAL

STANDARD FINISH:	As built
MASS:	160g / 0.35lbs
TEMPERATURE:	-20° to +50°C
WIND LOADING:	N/A

MOUNTING OPTIONS

KITS AVAILABLE:	N/A
See Separate Data Sheets	

GA: 1415-1 Issued: 070907
 DIMENSIONS: mm [inches]

SIDE VIEW

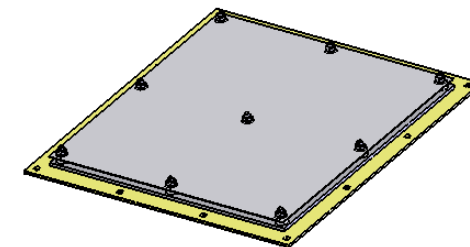
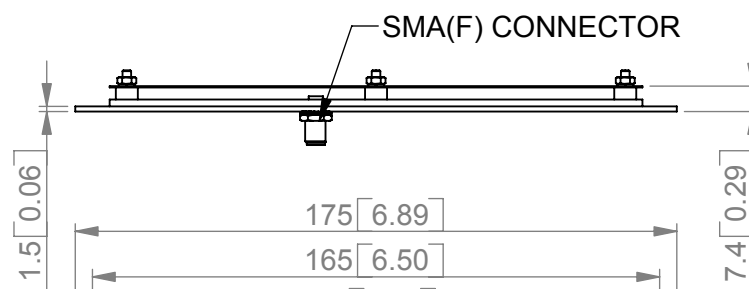

ISOMETRIC VIEW

BASE VIEW

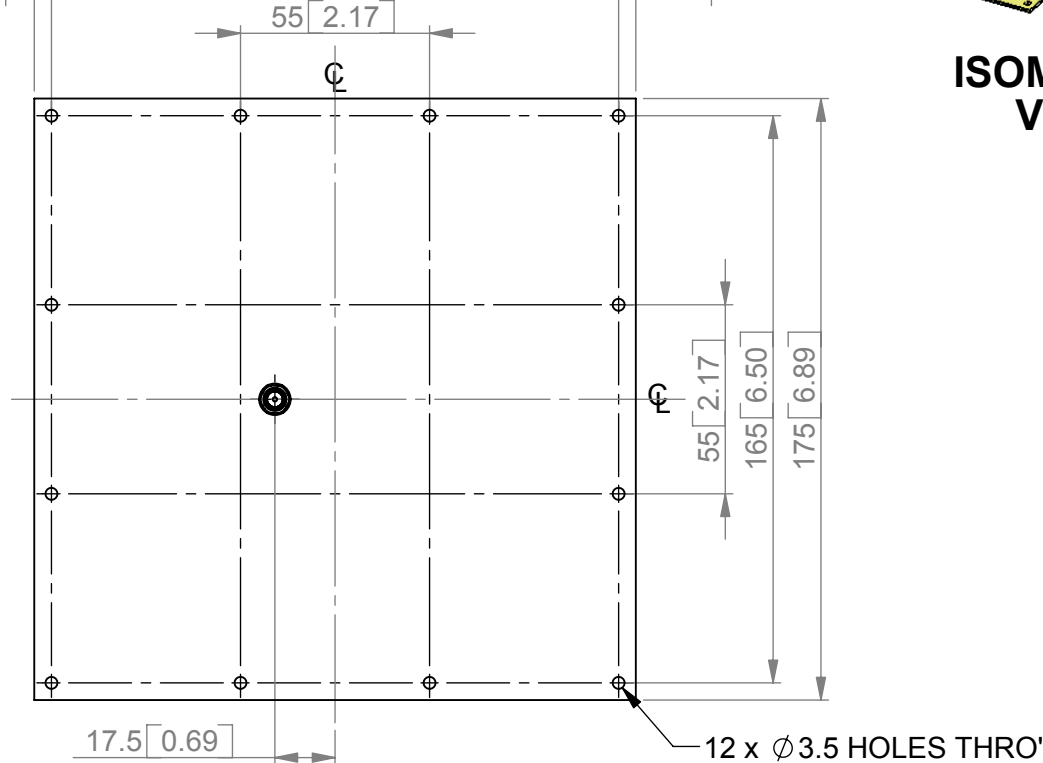

FPA19-6.8V/1415

European Antennas Ltd. has a policy of continuous development and therefore stress that the data contained on this sheet should be used for guidance only.

European Antennas Ltd. is part of the Cobham Antennas Division



Certificate No 9268

European Antennas Ltd
 Lambda House, Cheveley
 Newmarket, Suffolk, CB8 9RG, UK
 Tel: +44 (0)1638 731888
 sales@european-antennas.co.uk
www.european-antennas.co.uk