

1.0 PERFORMANCE: (sea level)
 1.1 FREQUENCY RANGE: DC-18 GHz
 1.2 VOLTAGE RATING: 50 Vrms
 1.3 NOMINAL IMPEDANCE: 50 OHMS
 1.4 DWV: 1,500 Vrms @ 60 Hz
 1.5 TEMPERATURE RANGE: -65 TO +165°C

2.0 MATERIALS: RoHS
 2.1 DIELECTRIC: PTFE
 2.2 LOCKING RING: BRONZE
 2.3 ALL OTHER METALS: SS-303
 2.4 GASKET: Si RUBBER
 2.5 CENTER CONTACT: BeCu
 3.0 FINISHES: (see table)

4.0 MECHANICAL
 4.1 INTERFACES PER MIL-STD-348

DWG NO. OL-0910-110-1		REV. A
PART NUMBER 0910-110-PH	BODY PASSIVATE	CONTACT GOLD/Ni

PLATING PER SAN-TRON SPEC. 7.3.1-8

DO NOT SCALE DRAWING

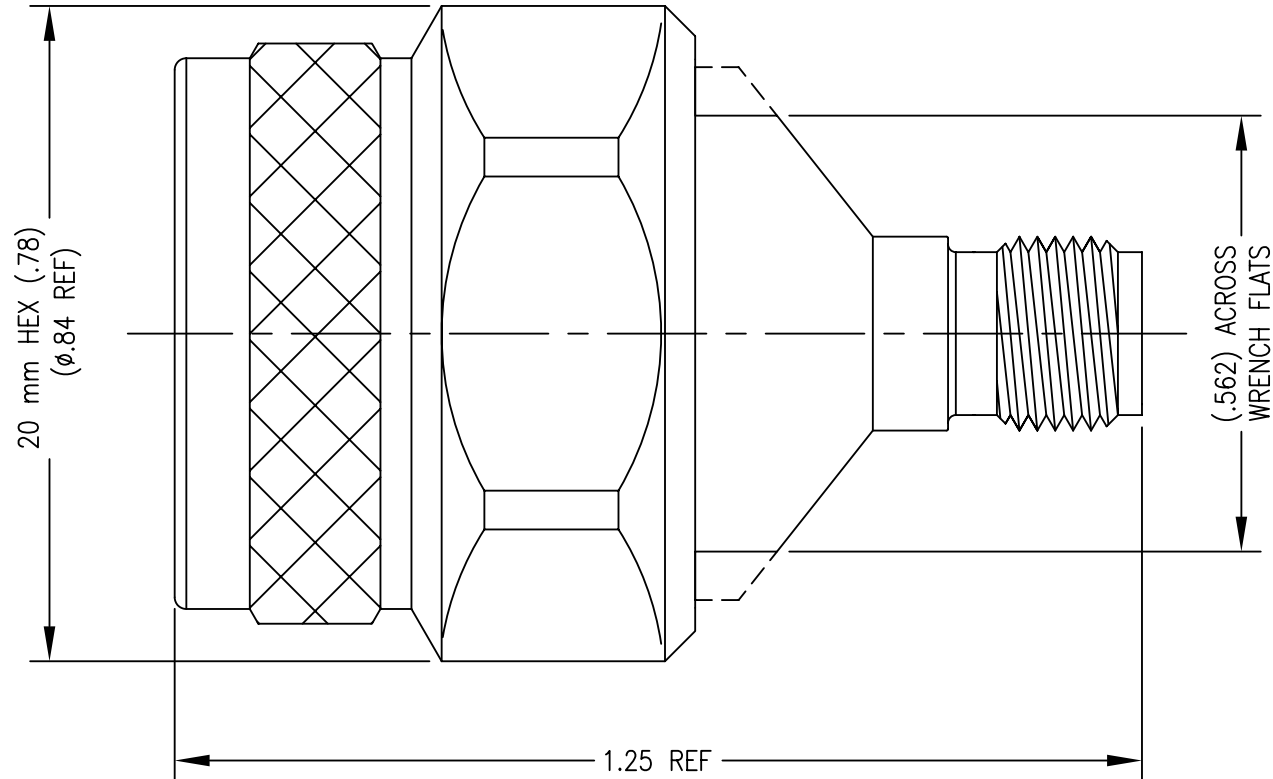

Rev.	Revisions	Disp.	Date	Dwn.	Appd.
A	ISSUE	NEW	1/8/10		
Ref.:	REMOVE ALL BURRS AND SHARP EDGES .005 MAX.	INTERPRET PER	ASME Y14.5M-1994		
SK-					

THIS DRAWING CONTAINS CONFIDENTIAL INFORMATION PROPRIETARY TO SAN-TRON, INC. IT MUST NOT BE REPRODUCED OR DISCLOSED TO OTHERS OR USED IN ANY OTHER WAY, IN WHOLE OR PART EXCEPT AS AUTHORIZED IN WRITING BY SAN-TRON, INC.

UNLESS OTHERWISE SPECIFIED:
 ALL DIMENSIONS ARE IN INCHES.
 ALL DIMENSIONS ARE AFTER PLATING.
 .XXX = ±.005 ALL MACHINED SURFACES ⁶³/ MAX.
 .XX = ±.01 ANG. ±1/2° FRACTIONAL = ±1/64
 ◎.004 MAX. TIR. ⊥ AXIS .001

THIRD ANGLE PROJECTION

DWN	FSH	1/7/10
CHKD	SJS	1/7/10
APPR	FSH	1/8/10

SAN-TRON, INC.
 4 NEWBURYPORT TPK. IPSWICH MA USA 01938
 TEL: 978 - 356 -1585 FAX: 978 - 356 -1573
 WWW.SANTRON.COM E MAIL: santron@santron.com

San-Tron

TITLE: ADAPTER N (M) / SMA (F)

MATERIAL: FINISH: SEE TABLE

CAGE CODE: 50896 DWG NO. OL-0910-110-1 REV. A

SCALE: X:X