

SMA F/F BULKHEAD ADAPTER 18GHZ w ORING

SM4913

SPECIFICATIONS

ELECTRICAL

50 OHMS
VSWR 1.2:1 MAX @ 18 GHZ
FREQUENCY: 0-18 GHZ

MECHANICAL

500 CYCLES MIN
7-9 IN-LBS COUPLING NUT MATING
TORQUE

OPERATING TEMPERATURE;
-55°C TO +110°C

MATERIALS

BODY:
SM4913 PASSIVATED STAINLESS STEEL
CONTACTS: BeCu
CONTACT PLATING: Au PER MIL-G-45204
INSULATOR: TEFLON
ORING: SILICONE RUBBER

INTERFACE: MIL-STD-348B

ROHS COMPLIANT

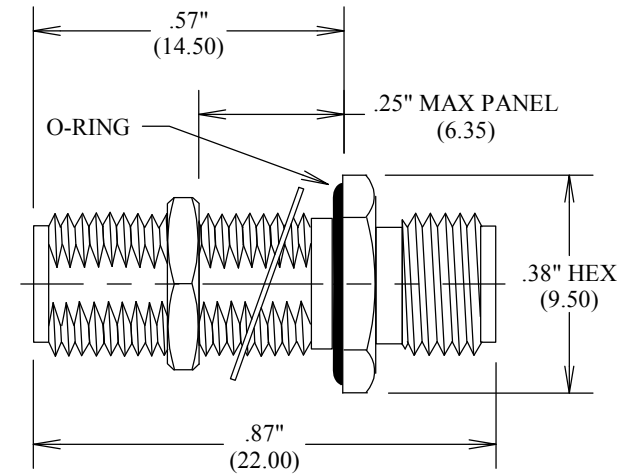

RECOMMENDED PANEL CUTOUT

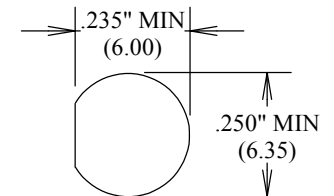

LOCKWASHER, ORING, GASKET SUPPLIED

SM4913 PASSIVATED

MEASUREMENTS BELOW ARE TYPICAL

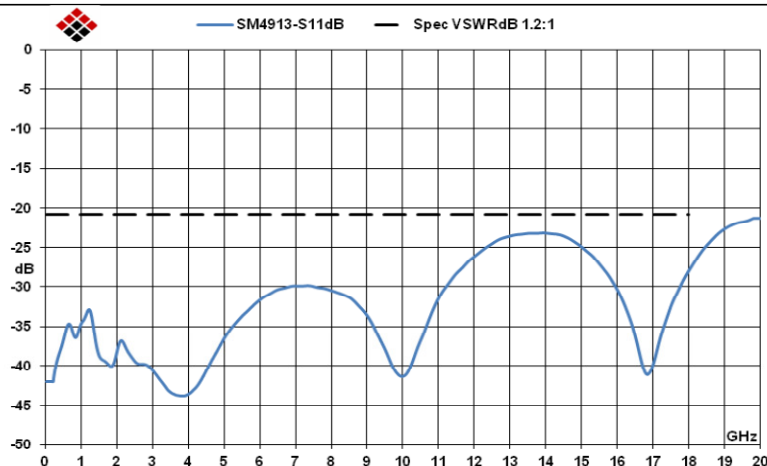

ALL DIMENSIONS IN inches(MM) Typical

FAIRVIEW MICROWAVE INC.

ALLEN, TX 75013 WWW.FAIRVIEWMICROWAVE.COM

TITLE

SMA F/F BULKHEAD ADAPTER
18GHZ w ORING

SIZE

A

CAGE CODE

3FKR5

DWG NO

SM4913

REV

A

SCALE

SHEET