

SPECIFICATIONS

ELECTRICAL

FREQUENCY RANGE _____ DC TO 18 GHz
 VSWR (MAX) _____ 1.05+.015(f)
 POWER _____ 10 WATTS (AVG)
 0.5 KILOWATTS (PEAK)
 DERATED LINERLY FROM 100% AT +25° C TO 10 AT +125° C
 (PEAK) 5µ S PULSE W, 0.50% DUTY CYCLE

IMPEDANCE _____ 50 OHMS

MECHANICAL

OPERATING TEMP RANGE -55 TO +125°
 WEIGHT MAX. _____ 1.8oz.

MATERIAL

OUTER CONDUCTOR: STAINLESS STEEL NON MAGNETIC,
 PASSIVATED FINISH.
 CENTER CONDUCTOR: BERYLLIUM COPPER, GOLD PLATED FINISH.
 DIELECTRIC: TEFLON
 HEAT SINK: ALUMINIUM ALLOY, BLACK ANNOIDIZED FINISH.

MATERIALS & FINISHES TYPICALLY PER MIL-PRF-39012

**PRODUCTION
RELEASE**

NOTE:
THIS DRAWING INCORPORATES
THIRD ANGLE PROJECTION.
INTERPRET IAW ANSI Y14.5-1995

REVISIONS

REV	DESCRIPTION	DATE	APPROVED
-1	Corrected Part Number	11/7/11	A. Gagne

TYPE N PLUG
INTERFACE PER
MIL-STD-348

OF HEAT SINK FINS
MAY VARY WITH LOTS

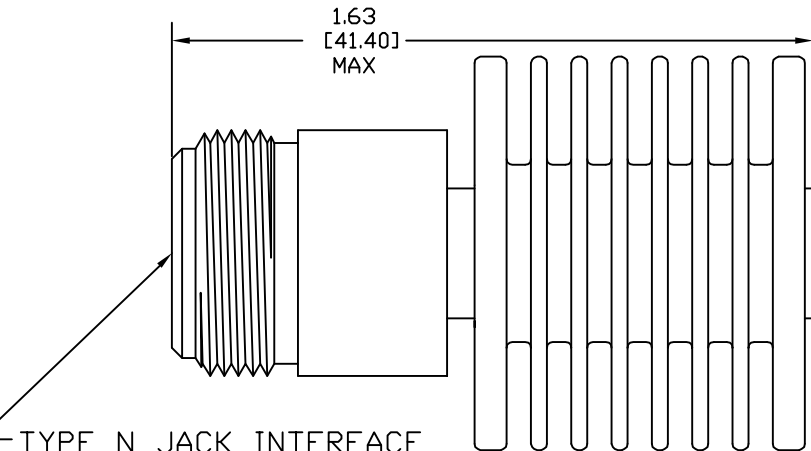
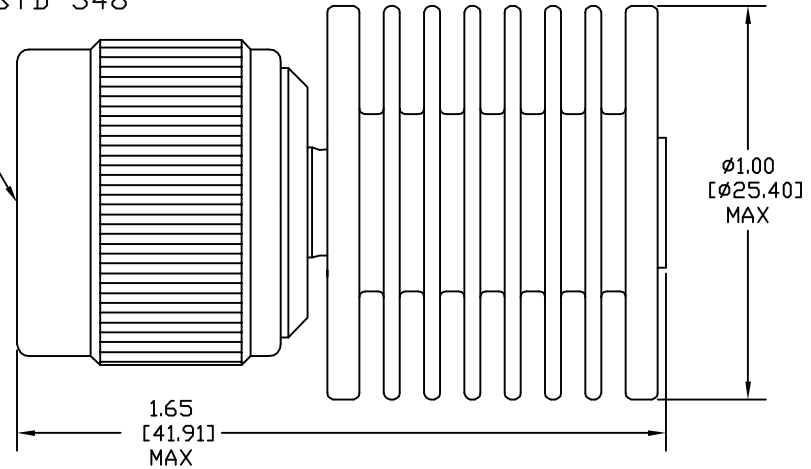

TYPE N JACK INTERFACE
PER MIL-STD-348
FEMALE CONNECTOR WHEN PREFIX
CHANGED FROM 3001- TO 3002-

DRAWING PRACTICES PER ANSI Y-14.5 MIL-STD-100 & 1000	UNLESS OTHERWISE SPECIFIED DIMENSIONS IN DECIMALS INCH MM	DRAWN T. MAIN 09/07/2010	DATE
DIMENSIONS ARE IN INCHES AND APPLY BEFORE/AFTER PROCESSING	.XX .075 [1.9]	CHECKED	DATE
SURFACE ROUGHNESS	.XXX .050 [1.3]	ENG. D. SAUNDERS 09/10/2010	DATE
FINISH	.XXX .030 [0.76]	THESE DRAWINGS AND SPECIFICATIONS ARE THE PROPERTY OF XMA CORP. / OMN SPECTRA AND SHALL NOT BE REPRODUCED COPIED, REPRODUCED, IN WHOLE OR IN PART, AS A BASIS FOR THE DESIGN, MANUFACTURE OR SALE OF OTHER ITEMS WITHOUT THE EXPRESS WRITTEN PERMISSION OF XMA CORP., CUSTOMERS AND VENDORS MAY COPY FOR INTERNAL REVIEW USE AS WEDED	
SEE NOTES	UNLESS OTHERWISE NOTED DIA5 CONCENTRIC <.003 T.I.R.	SIZE C	CAGE CODE 3HT76
MATERIAL SEE NOTES		DWG NO.	3001-6132-80

SCALE	4:1	PLATE OFF CD, REF. BENCH	XXX	SHEET 1 OF 1
-------	-----	-----------------------------	-----	--------------

WWW.XMACorp.com Sales@XMACorp.com
XMA <small>Powered by:</small> Omni
Spectra ®
XMA Corp. 150 Dow St. Manchester, NH 03045 (603) 222-2256 fax 222-2259

TITLE			
10 WATT TERMINATION TYPE N CONNECTOR			
SIZE	CAGE CODE	DWG NO.	
C	3HT76	3001-6132-80	
SCALE	4:1	PLATE OFF CD, REF. BENCH	XXX
SHEET 1 OF 1			