

3.5-3.5mm M/F FLANGE ADAPTER

SM3321

SPECIFICATIONS

ELECTRICAL

FREQUENCY: 0-34 GHZ
IMPEDANCE: 50 OHMS
VSWR: 1.25:1 MAX

MECHANICAL

500 CYCLES MIN
4.0 IN-OUNCES MIN CONTACT TORQUE
8-10 IN-LBS COUPLING NUT MATING TORQUE
DURABILITY: 500 CYCLES MIN.
TEMPERATURE RANGE: -55 TO +100 DEG C

MATERIALS

BODY PASS STAINLESS STEEL
CONTACTS BeCu
CONTACT PLATING: Au MIL-G-45204
INTERFACE: 348
ROHS COMPLIANT

MEASUREMENTS BELOW ARE TYPICAL

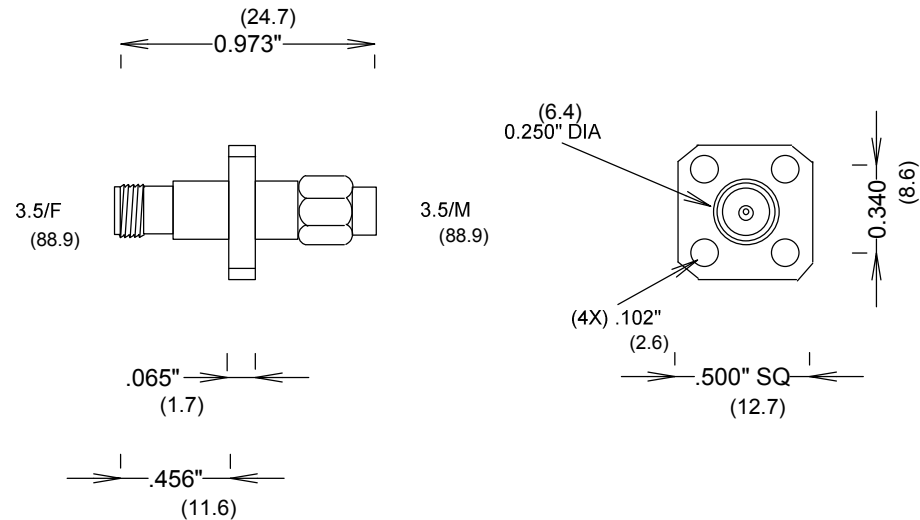
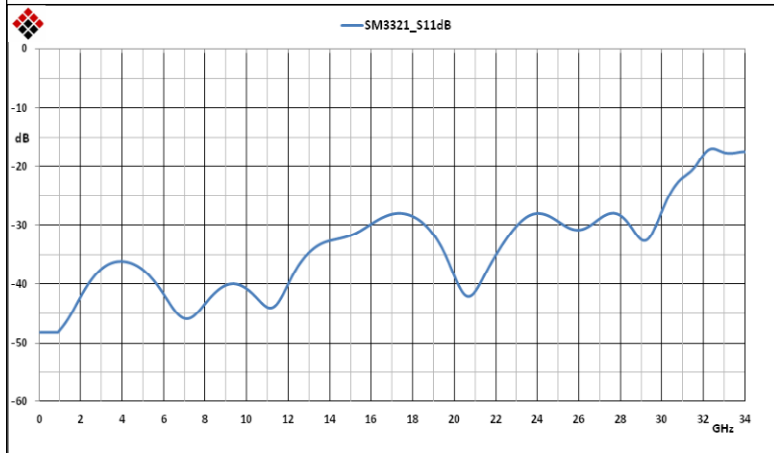

ALL DIMENSIONS IN inches(MM) Typical

FAIRVIEW MICROWAVE INC.

ALLEN, TX 75013 WWW.FAIRVIEWMICROWAVE.COM

TITLE

3.5-3.5mm M/F FLANGE ADAPTER

SIZE

A

CAGE CODE

3FKR5

DWG NO

SM3321

REV

A

SCALE

SHEET