

Coaxial

Voltage Controlled Oscillator

ZX95-310A+

Wide Band 160 to 360 MHz

Features

- very wide band frequency
- low phase noise
- low pulling
- low pushing
- protected by US patent 6,790,049



CASE STYLE: GB956

Applications

- R & D
- lab
- instrumentation
- wireline broadband access
- digital TV

Connectors	Model	Price	Qty.
SMA	ZX95-310A-S+	\$ 49.95 ea.	(1-9)

+RoHS Compliant
The +Suffix identifies RoHS Compliance. See our web site for RoHS Compliance methodologies and qualifications

Electrical Specifications

MODEL NO.	FREQ. (MHz)		POWER OUTPUT (dBm)	PHASE NOISE dBc/Hz SSB at offset frequencies, kHz				TUNING				NON HARMONIC SPURIOUS (dBc)	HARMONICS (dBc)		PULLING pk-pk @ 12 dB (MHz)	PUSHING (MHz/V)	DC OPERATING POWER		
	Min.	Max.		Typ.	1	10	100	1000	VOLTAGE RANGE (V)	SENSI- TIVITY (MHz/V)	PORT CAP (pF)		3 dB MODULATION BANDWIDTH (MHz)	Typ.			Typ.	Max.	Typ.
ZX95-310A+	160	360	+7.5	-81	-103	-125	-145	0.5	18.0	9 - 18	290	0.035	-90	-26	-18	0.2	0.4	10	22

Maximum Ratings

Operating Temperature	-55°C to 85°C
Storage Temperature	-55°C to 100°C
Absolute Max. Supply Voltage (Vcc)	12V
Absolute Max. Tuning Voltage (Vtune)	20V
All specifications	50 ohm system

Permanent damage may occur if any of these limits are exceeded.

Outline Drawing

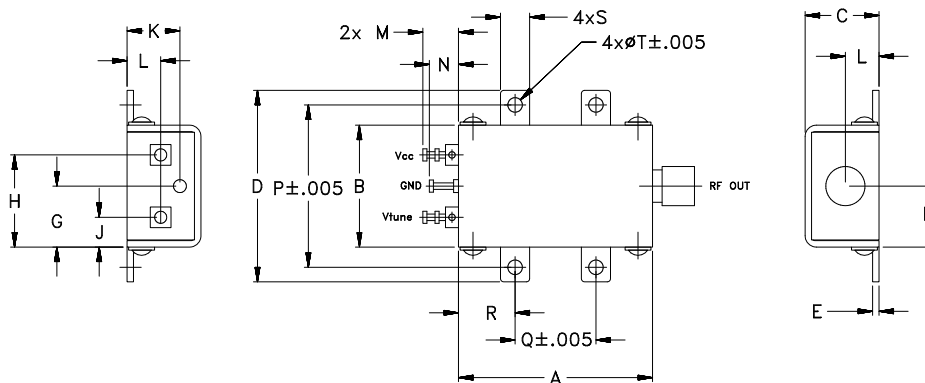

Outline Dimensions (inch/mm)

A	B	C	D	E	F	G	H	J	K	L	M	N	P	Q	R	S	T	wt.
1.20	.75	.46	1.18	.04	.38	.38	.57	.18	.33	.21	.22	.18	1.00	.50	.35	.18	.106	grams
30.48	19.05	11.68	29.97	1.02	9.65	9.65	14.48	4.57	8.38	5.33	5.59	4.57	25.40	12.70	8.89	4.57	2.69	35.0

Notes

- Performance and quality attributes and conditions not expressly stated in this specification document are intended to be excluded and do not form a part of this specification document.
- Electrical specifications and performance data contained in this specification document are based on Mini-Circuits' applicable established test performance criteria and measurement instructions.
- The parts covered by this specification document are subject to Mini-Circuits standard limited warranty and terms and conditions (collectively, "Standard Terms"); Purchasers of this part are entitled to the rights and benefits contained therein. For a full statement of the Standard Terms and the exclusive rights and remedies thereunder, please visit Mini-Circuits' website at www.minicircuits.com/MCLStore/terms.jsp



www.minicircuits.com P.O. Box 350166, Brooklyn, NY 11235-0003 (718) 934-4500 sales@minicircuits.com

REV. B
M148277
EDR-11133MEF1
ZX95-310A+
RAV
140917
Page 1 of 2

Performance Data & Curves*

ZX95-310A+

V TUNE	TUNE SENS (MHz/V)	FREQUENCY (MHz)			POWER OUTPUT (dBm)			Icc (mA)	HARMONICS (dBc)			FREQ. PUSH (MHz/V)	FREQ. PULL (MHz)	PHASE NOISE (dBc/Hz) at offsets				FREQ OFFSET (KHz)	PHASE NOISE at 260 MHz (dBc/Hz)
		-55°C	+25°C	+85°C	-55°C	+25°C	+85°C		F2	F3	F4			1kHz	10kHz	100kHz	1MHz		
0.00	17.42	146.5	144.1	142.5	5.84	5.88	5.41	16.55	-19.3	-35.4	-38.3	0.05	0.04	-78.45	-100.0	-122.8	-143.2	1.0	-81.15
0.50	16.13	154.9	152.8	151.6	6.50	7.06	6.87	16.72	-22.7	-39.2	-40.3	0.37	0.10	-79.89	-101.5	-124.7	-145.5	2.0	-87.20
1.00	14.28	162.8	160.9	159.7	6.71	7.41	7.28	16.70	-28.4	-45.4	-40.9	0.23	0.05	-81.19	-102.8	-125.4	-146.1	3.5	-92.68
2.00	14.08	177.0	174.9	173.7	6.95	7.76	7.66	16.59	-36.6	-46.3	-39.8	0.15	0.08	-80.72	-103.7	-126.0	-146.4	6.0	-97.63
3.00	14.28	191.1	188.8	187.4	7.06	7.93	7.83	16.45	-29.7	-43.8	-39.9	0.02	0.06	-81.98	-103.5	-126.9	-147.5	8.5	-101.29
4.00	14.46	205.6	203.5	202.0	7.01	7.91	7.89	16.32	-27.1	-41.4	-39.7	0.13	0.06	-83.07	-103.2	-124.8	-144.9	10.0	-102.91
5.00	15.73	220.5	218.2	216.9	7.08	7.92	7.83	16.09	-24.9	-39.0	-37.5	0.35	0.01	-81.13	-102.9	-125.1	-145.3	20.8	-110.29
6.00	16.69	236.3	233.9	232.6	7.08	7.80	7.69	15.87	-24.0	-39.3	-36.6	0.37	0.06	-81.20	-103.1	-124.4	-144.6	35.5	-115.59
7.00	15.58	253.0	250.5	248.9	6.94	7.72	7.70	15.72	-24.4	-39.7	-37.4	0.47	0.06	-81.31	-102.5	-124.7	-144.8	60.7	-121.00
8.00	17.50	268.8	266.5	265.2	6.76	7.66	7.71	15.48	-24.8	-36.4	-37.0	0.84	0.00	-79.71	-101.8	-124.1	-144.2	86.7	-124.38
9.00	15.02	286.3	283.5	281.5	6.83	7.78	7.78	15.32	-23.4	-37.6	-36.0	0.51	0.14	-82.26	-103.0	-124.7	-144.8	100.0	-125.58
10.00	16.35	300.6	297.9	296.3	6.56	7.32	7.23	15.07	-24.6	-37.5	-37.7	0.63	0.20	-80.39	-102.3	-125.3	-145.6	148.1	-129.43
11.00	14.81	316.7	314.0	312.4	6.21	7.02	7.13	14.89	-25.4	-37.4	-34.5	0.59	0.09	-81.37	-102.3	-124.5	-144.6	177.0	-130.73
12.00	12.60	331.0	328.3	326.6	6.11	6.98	7.15	14.76	-25.0	-37.8	-34.1	0.30	0.23	-80.09	-102.7	-124.5	-144.6	211.6	-132.59
13.00	11.56	343.2	340.4	338.6	6.16	6.94	7.00	14.63	-24.8	-37.2	-34.8	0.26	0.59	-81.22	-102.8	-125.2	-145.3	302.4	-135.58
14.00	11.41	355.1	352.1	350.4	6.00	6.71	6.80	14.53	-25.6	-37.9	-34.4	0.67	0.36	-80.69	-102.4	-125.3	-145.6	361.5	-137.07
15.00	9.97	366.2	363.1	361.5	5.96	6.68	6.80	14.46	-25.1	-39.2	-32.9	0.48	0.29	-81.69	-103.1	-125.3	-145.5	507.5	-139.91
16.00	8.71	375.8	372.8	371.1	5.85	6.61	6.76	14.41	-24.8	-41.1	-31.7	0.30	0.28	-80.05	-103.5	-125.2	-145.3	606.7	-141.46
17.00	7.62	384.1	381.2	379.6	5.71	6.50	6.66	14.37	-25.1	-43.9	-30.9	0.15	0.27	-82.87	-103.9	-124.9	-144.8	851.6	-144.31
18.00	6.69	391.3	388.6	387.0	5.55	6.34	6.50	14.33	-25.5	-45.0	-30.4	0.04	0.25	-82.59	-104.0	-124.4	-144.3	1000.0	-145.85

*at 25°C unless mentioned otherwise

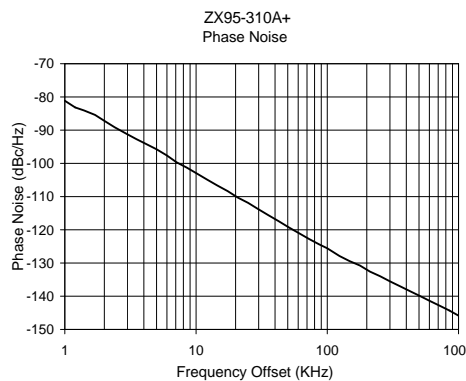
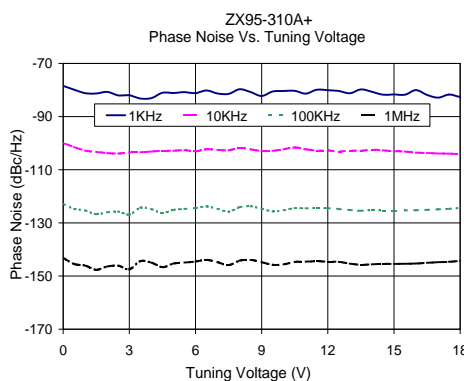
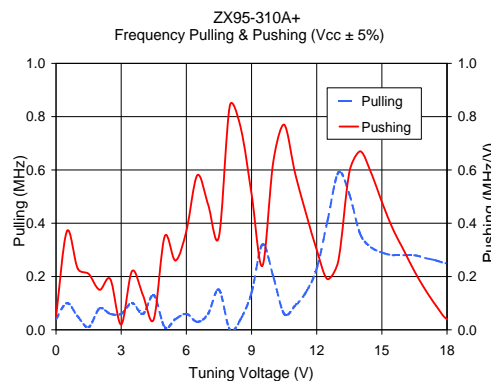
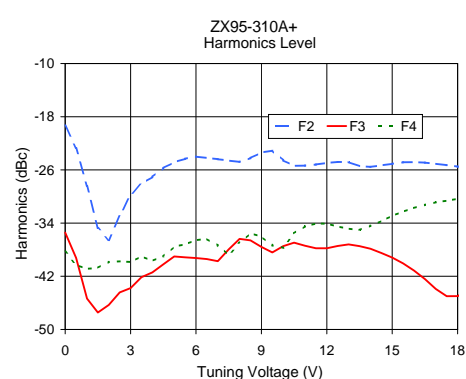
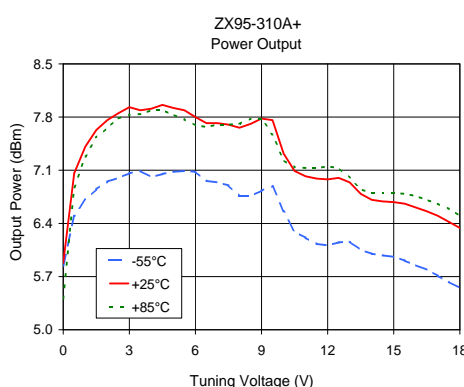
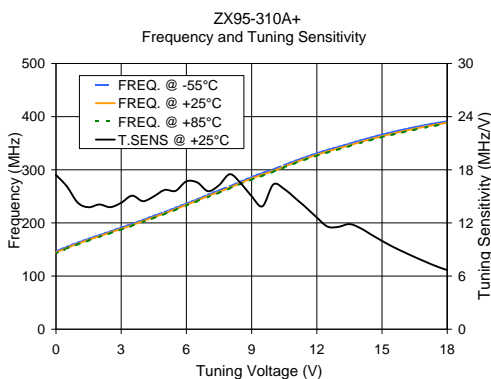

Notes

- A. Performance and quality attributes and conditions not expressly stated in this specification document are intended to be excluded and do not form a part of this specification document.
- B. Electrical specifications and performance data contained in this specification document are based on Mini-Circuit's applicable established test performance criteria and measurement instructions.
- C. The parts covered by this specification document are subject to Mini-Circuits standard limited warranty and terms and conditions (collectively, "Standard Terms"); Purchasers of this part are entitled to the rights and benefits contained therein. For a full statement of the Standard Terms and the exclusive rights and remedies thereunder, please visit Mini-Circuits' website at www.minicircuits.com/MCLStore/terms.jsp

