

WAVEGUIDE WRD187 CIRCULATOR DUAL DIRECTIONAL COUPLER -RWGDCP187SA

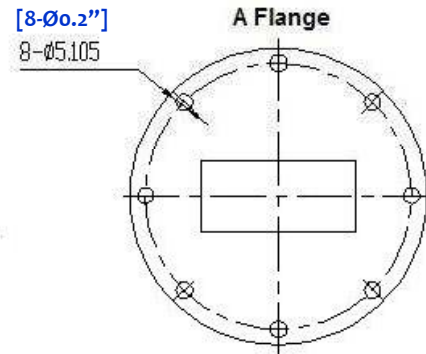
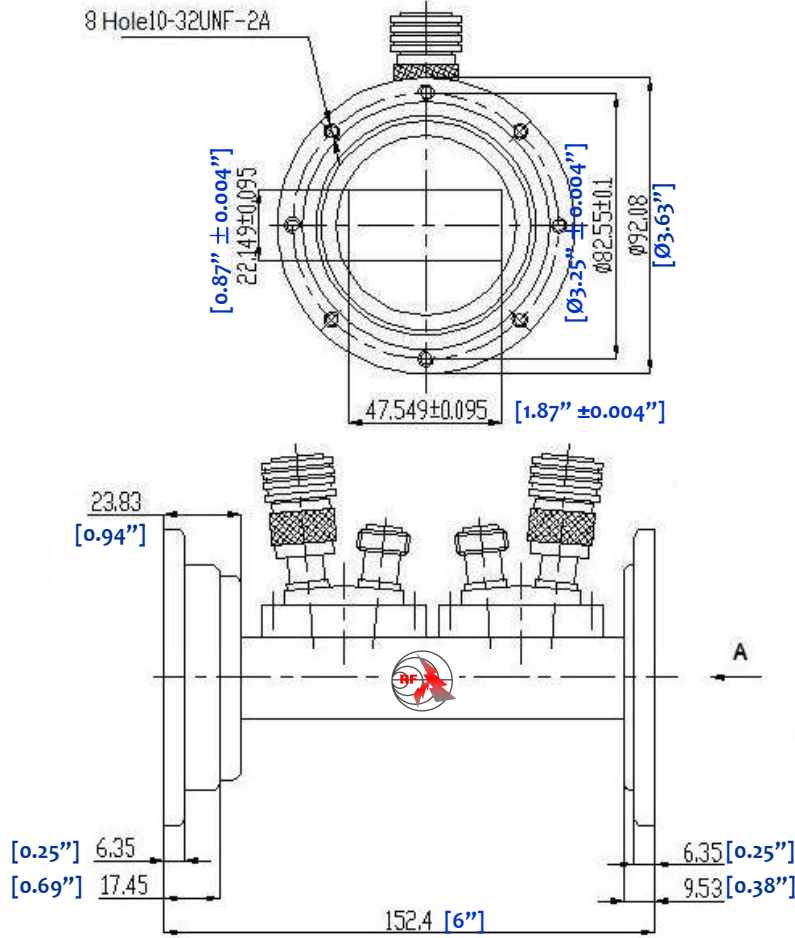

| 3.0 Electrical Specifications | | |
|-------------------------------|-----------------|------------|
| 3.1 | Frequency Range | 5.4-5.8GHz |
| 3.2 | Coupling | 30dB |
| 3.3 | Directivity | 20dB |
| 3.4 | VSWR | 1.05 |
| 3.5 | Insertion Loss | 0.20dB |
| 3.6 | Average Power | 1000W |

| 1.0 Mechanical Specifications | | |
|-------------------------------|----------------------|---|
| 1.1 | Waveguide type | Rectangular WRD187 |
| 1.2 | Flange type | CPRG, CPRF, COVER, CHOKE available |
| 1.3 | Flange Holes | Through |
| 1.4 | Basis-material | Alloyed Cuprum |
| 1.5 | Internal Body Finish | Plated chromate or conversion |
| 1.6 | External Body Finish | Body painted with gray/black epoxy enamel |

| 2.0 Environment specifications | | |
|--------------------------------|-----------------|-----------------------------------|
| 2.1 | Operation Temp. | -40°C~+85°C |
| 2.2 | Storage Temp. | -60°C~+125°C |
| 2.3 | Altitude | 45000 ft |
| 2.4 | Vibration | 10g rms (15 degree 2KHz) |
| 2.5 | Humidity | 100% RH at 35c, 95%RH at 40 deg c |
| 2.6 | Shock | 20G for 11msc |

| PAGE | OF | DATE |
|---|----|--------------------------|
| | | Jul 9 th 2008 |
| <small>PROPRIETARY INFORMATION THE INFORMATION CONTAINED IN THIS DOCUMENT IS THE PROPERTY OF RF-LAMBDA EXCEPT AS SPECIFICALLY AUTHORIZED IN WRITING BY RF-LAMBDA. THE HOLDER OF THIS DOCUMENT SHALL KEEP ALL INFORMATION CONTAINED HEREIN CONFIDENTIAL AND SHALL PROTECT SAME IN THE WHOLE OR IN PART FROM DISCLOSURE AND DISSEMINATION OF ALL THIRD PARTIES AND SHALL USE SAME FOR OPERATING AND MAINTENANCE PURPOSES ONLY</small> | | DESIGN |
| | | RFPC |
| | | RF-LAMBDA |
| | | RFPC |
| | | CAD MODEL REVISION |
| | | 1-4 |
| | | ASSEMBLY REVISION |
| | | VS20-3 |
| | | ASSEMBLY NAME |
| | | RFLVR04 |
| | | DRAWING NUMBER |
| | | D02-5 |
| www.rflambda.com | | |
| RF-LAMBDA | | SIZE LT |
| | | SHEETS 1 OF 1 |



RWGDCP187SA
WAVEGUIDE
COUPLER