

SPECIFICATIONS

ELECTRICAL

FREQUENCY RANGE _____ DC TO 12.4 GHz
 VSWR (MAX) _____ 1.05+.015(f)
 POWER _____ 10 WATTS (AVG)
 0.5 KILOWATTS (PEAK)
 DERATED LINERLY FROM 100% AT +25° C TO 10 AT +125° C
 (PEAK) 5µ S PULSE W, 0.50% DUTY CYCLE

IMPEDANCE _____ 50 OHMS

MECHANICAL

OPERATING TEMP RANGE -55 TO +125°
 WEIGHT MAX. _____ 1.8oz.

MATERIAL

OUTER CONDUCTOR: STAINLESS STEEL NON MAGNETIC,
 PASSIVATED FINISH.
 CENTER CONDUCTOR: BERYLLIUM COPPER, GOLD PLATED FINISH.
 DIELECTRIC: TEFLON
 HEAT SINK: ALUMINIUM ALLOY, BLACK ANNOIDIZED FINISH.

MATERIALS & FINISHES TYPICALLY PER MIL-PRF-39012

**PRODUCTION
RELEASE**

NOTE:
THIS DRAWING INCORPORATES
THIRD ANGLE PROJECTION
INTERPRET IN ACCORDANCE WITH
ANSI Y14.5-1992

REVISIONS

REV	DESCRIPTION	DATE	APPROVED
-1	Corrected Part Number	11/7/11	A. Gagne

TYPE N PLUG
INTERFACE PER
MIL-STD-348

OF HEAT SINK FINES
MAY VARY WITH LOTS

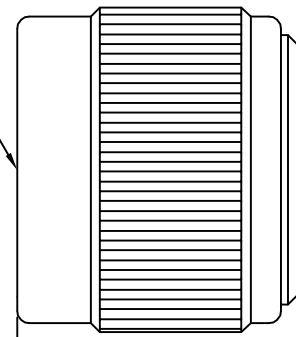

1.65
[41.91]
MAX

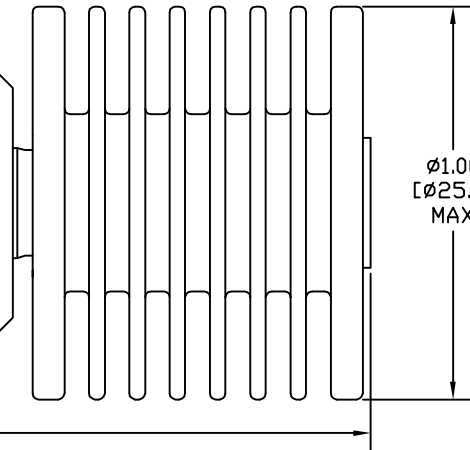

Ø1.00
[Ø25.40]
MAX

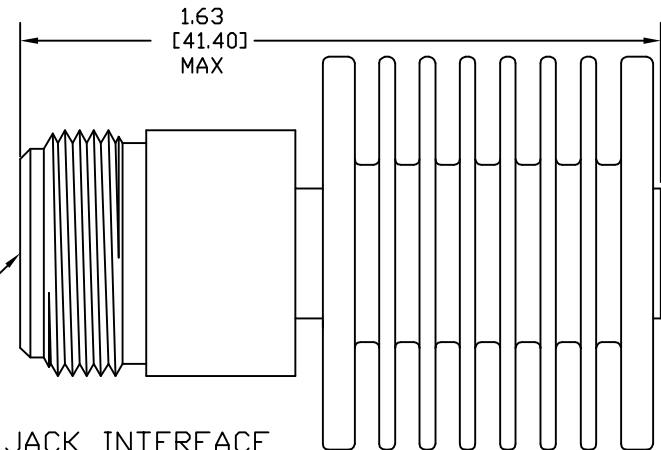

1.63
[41.40]
MAX

TYPE N JACK INTERFACE
PER MIL-STD-348
FEMALE CONNECTOR WHEN PREFIX
CHANGED FROM 3001- TO 3002-

DRIVING PRACTICES PER ANSI Y14.5 MIL-STD-100 & 1000	UNLESS OTHERWISE SPECIFIED TOLERANCES IN:	DRAWN T. MAIN	DATE 09/07/2010
DIMENSIONS ARE IN INCHES AND APPLY BEFORE/ AFTER PROCESSING	DIGITS DECIMALS INCH MM	CHECKED	DATE
SURFACE ROUGHNESS	.xx .075 [1.9] .xxx .050 [1.3] .xxxx .030 [0.76]	ENG. D. SAUNDERS	DATE 09/10/2010
FINISH:	UNLESS OTHERWISE NOTED DIAS CONCENTRIC <.003 T.I.R.	THESE DRAWINGS AND SPECIFICATIONS ARE THE PROPERTY OF XMA CORP. / OMNIA SPECTRA AND SHALL NOT BE REPRODUCED, COPIED, NOR USED, IN WHOLE OR IN PART, AS A BASIS FOR THE DESIGN, MANUFACTURE OR SALE OF OTHER ITEMS WITHOUT THE EXPRESS WRITTEN PERMISSION OF XMA CORP., CUSTOMERS AND VENDORS MAY COPY FOR INTERNAL REVIEW USE AS WEDED	
SEE NOTES			
MATERIAL:			
SEE NOTES			

UNLESS OTHERWISE SPECIFIED TOLERANCES IN:	DRAWN T. MAIN	DATE 09/07/2010
DIGITS DECIMALS INCH MM	CHECKED	DATE
.xx .075 [1.9] .xxx .050 [1.3] .xxxx .030 [0.76]	ENG. D. SAUNDERS	DATE 09/10/2010
UNLESS OTHERWISE NOTED DIAS CONCENTRIC <.003 T.I.R.	THESE DRAWINGS AND SPECIFICATIONS ARE THE PROPERTY OF XMA CORP. / OMNIA SPECTRA AND SHALL NOT BE REPRODUCED, COPIED, NOR USED, IN WHOLE OR IN PART, AS A BASIS FOR THE DESIGN, MANUFACTURE OR SALE OF OTHER ITEMS WITHOUT THE EXPRESS WRITTEN PERMISSION OF XMA CORP., CUSTOMERS AND VENDORS MAY COPY FOR INTERNAL REVIEW USE AS WEDED	

UNLESS OTHERWISE SPECIFIED TOLERANCES IN:	DRAWN T. MAIN	DATE 09/07/2010
DIGITS DECIMALS INCH MM	CHECKED	DATE
.xx .075 [1.9] .xxx .050 [1.3] .xxxx .030 [0.76]	ENG. D. SAUNDERS	DATE 09/10/2010
UNLESS OTHERWISE NOTED DIAS CONCENTRIC <.003 T.I.R.	THESE DRAWINGS AND SPECIFICATIONS ARE THE PROPERTY OF XMA CORP. / OMNIA SPECTRA AND SHALL NOT BE REPRODUCED, COPIED, NOR USED, IN WHOLE OR IN PART, AS A BASIS FOR THE DESIGN, MANUFACTURE OR SALE OF OTHER ITEMS WITHOUT THE EXPRESS WRITTEN PERMISSION OF XMA CORP., CUSTOMERS AND VENDORS MAY COPY FOR INTERNAL REVIEW USE AS WEDED	

WWW.XMACorp.com Sales@XMACorp.com

XMA Powered by: **Omni**
Spectra®

XMA Corp. 150 Dow St. Manchester, NH 03045 (603) 222-2256 fax 222-2259

TITLE
**10 WATT TERMINATION
TYPE N CONNECTOR**

SIZE C	CAGE CODE 3HT76	DWG NO. 3001-6131-80
SCALE 4:1	PLATING AREA SQUARE INCHES	XXX SHEET 1 OF 1