

N-M CRIMP RG9, RG214, RG393

SC9105

SPECIFICATIONS

ELECTRICAL:

FREQUENCY: 0-12 GHZ
VSWR 1.3:1 MAX
IMPEDANCE: 50 OHMS

MECHANICAL:

MATERIAL BODY: NICKLE PLATED BRASSS
CENTER CONTACT: BRASS
CONTACT PLATING: Si QQ-S-365
INSULATOR: TEFLON
INTERFACE: MIL-STD-348B
ROHS COMPLIANT
OP. TEMP RANGE: -55°C- +155°C

ASSEMBLY INSTRUCTIONS:

TRIM CABLE AS SHOWN;
SOLDER CONTACT ONTO CENTER CONDUCTOR,
CHECK THAT BACK OF CONTACT IS FLUSH WITH DIELECTRIC;
FLARE BRAID SLIGHTLY BY ROTATING;
INSERT CABLE/CONTACT INTO REAR OF BODY;
ALL BRAID WIRES OUTSIDE OF CRIMP TAIL;
PUSH CABLE IN UNTIL CABLE DIELECTRIC BOTTOMS IN CONN;
TRIM EXCESS BRAID WIRES;
SLIDE SLEEVE FORWARD, CRIMP

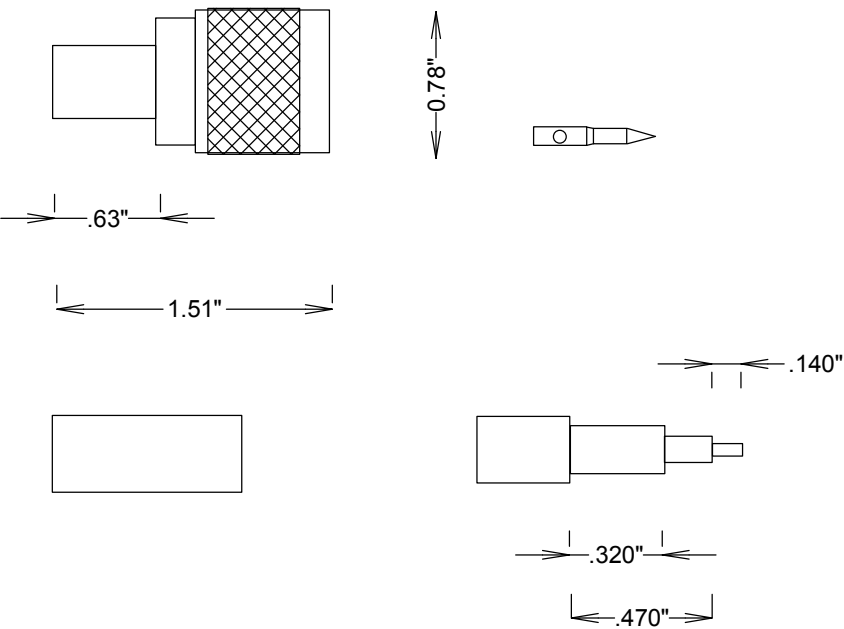

STRIPPING DIMENSIONS

FAIRVIEW MICROWAVE INC.				
ALLEN, TX 75013 WWW.FAIRVIEWMICROWAVE.COM				
TITLE				
N-M CRIMP RG9, RG214, RG393				
SIZE	CAGE CODE	DWG NO	REV	
A	3FKR5	SC9105		
SCALE				SHEET