

KR Electronics, Inc.

General Description

KR Electronics part number 3017 is a 455 MHz bandpass filter. The filter has a minimum 3 dB bandwidth of 30 MHz. Other center frequencies and bandwidths available. Please consult the factory.

Features

- 455 MHz Bandpass
- Minimum 3 dB Bandwidth 30 MHz
- 50 Ω Source and Load
- Surface Mount
- Also available with SMA Connectors

Typical Performance

Overall Response
(10 dB/div)

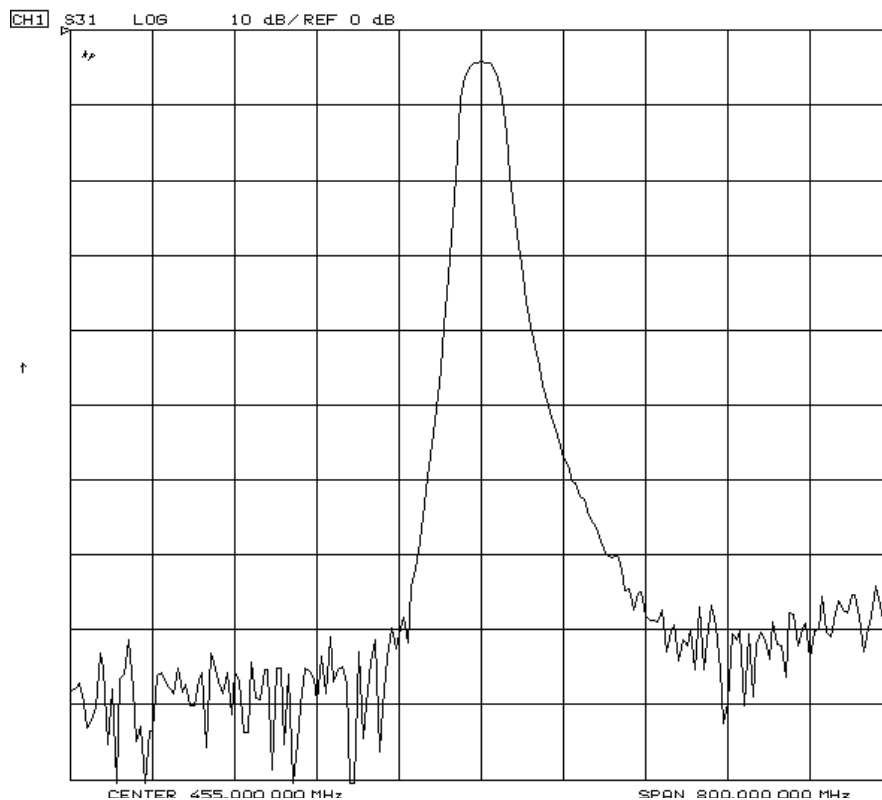

KR Electronics, Inc.
91 Avenel Street
Avenel, NJ 07001

Web www.krfilters.com
Email sales@krfilters.com
Phone (732) 636-1900
Fax (732) 636-1982

Typical Performance

Passband Amplitude & Group Delay (1 dB/div & 10 nsec/div)

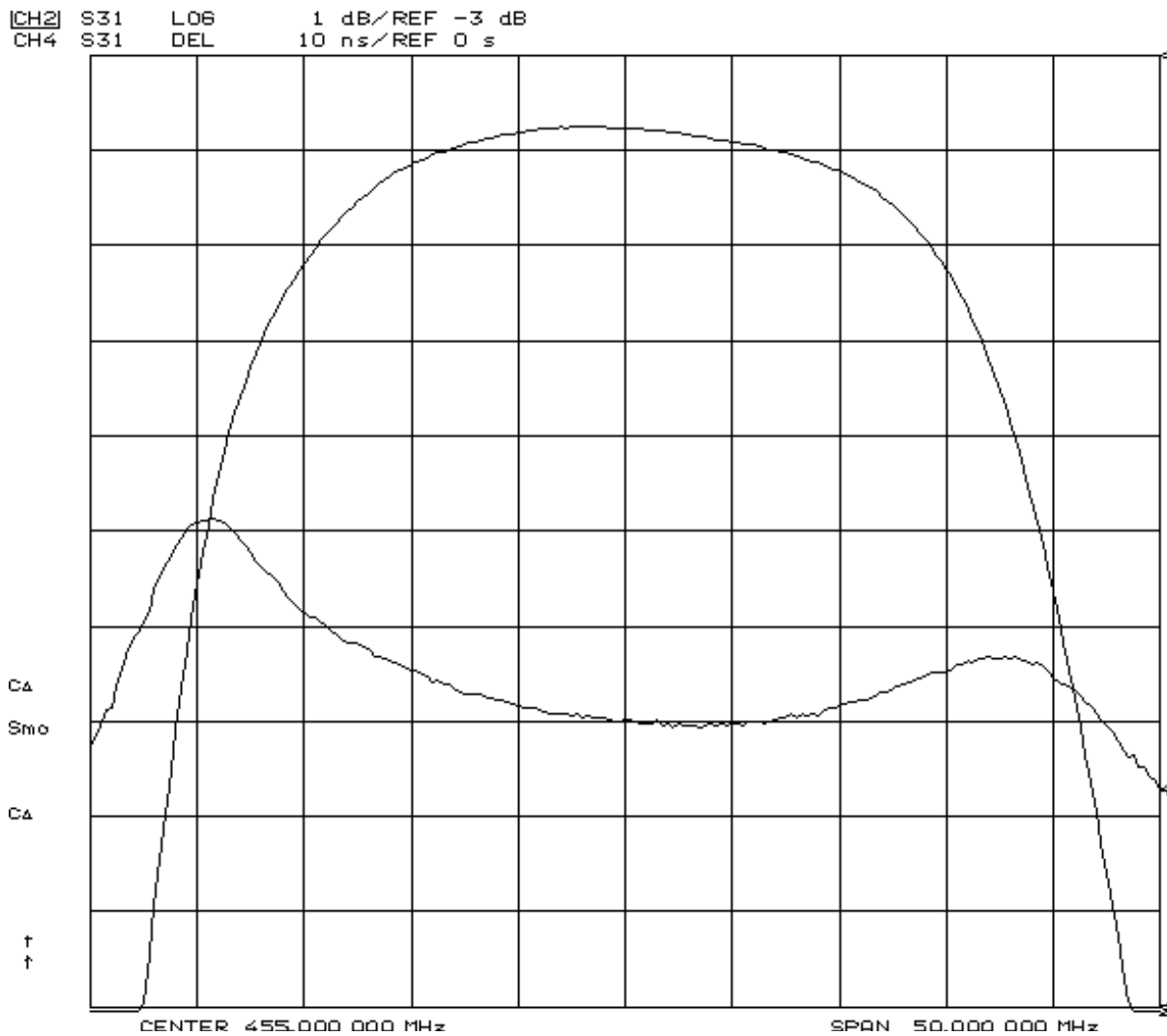

KR Electronics 3017

Specifications

Parameter	Specification
Filter type	Bandpass
Center Frequency	455 MHz
Insertion Loss	4 dB typical
3 dB Bandwidth	30 MHz min
20 dB Bandwidth	59 MHz typical
40 dB Bandwidth	94 MHz typical
60 dB Bandwidth	160 MHz typical
Source and Load	50 Ω

Physical Dimensions

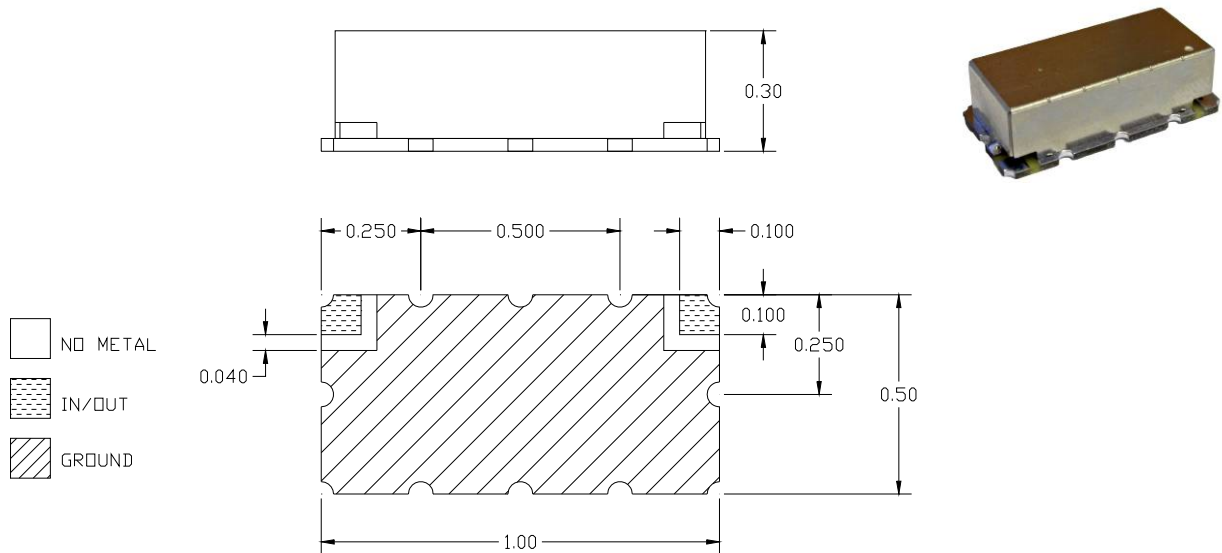

Notes:

1. Surface mount package
2. Dimensions in inches
3. Max reflow temperature 209° C for 10 sec
4. If boards are cleaned after installation units must be completely dried

KR Electronics, Inc.
91 Avenel Street
Avenel, NJ 07001

Web www.krfilters.com
Email sales@krfilters.com
Phone (732) 636-1900
Fax (732) 636-1982