

Drop-in Circulator

ELECTRICAL SPECIFICATION

Product Model:	VDC-1919-2
Frequency Range (MHz):	1930-1990
Isolation ( dB ) min:	23 Room Temp (+25°C±10), 20 Over Temp (-30°C~+85°C)
Insertion Loss ( dB ) max:	0.25 Room Temp (+25°C±10), 0.30 Over Temp (-30°C~+85°C)
VSWR max:	1.15 Room Temp (+25°C±10), 1.20 Over Temp (-30°C~+85°C)
Impedance (Ω):	50
Forward & Reverse Power (W):	250
Operating Temp. Range (°C):	-30~+85
Storage Temperature (°C):	-45~+100

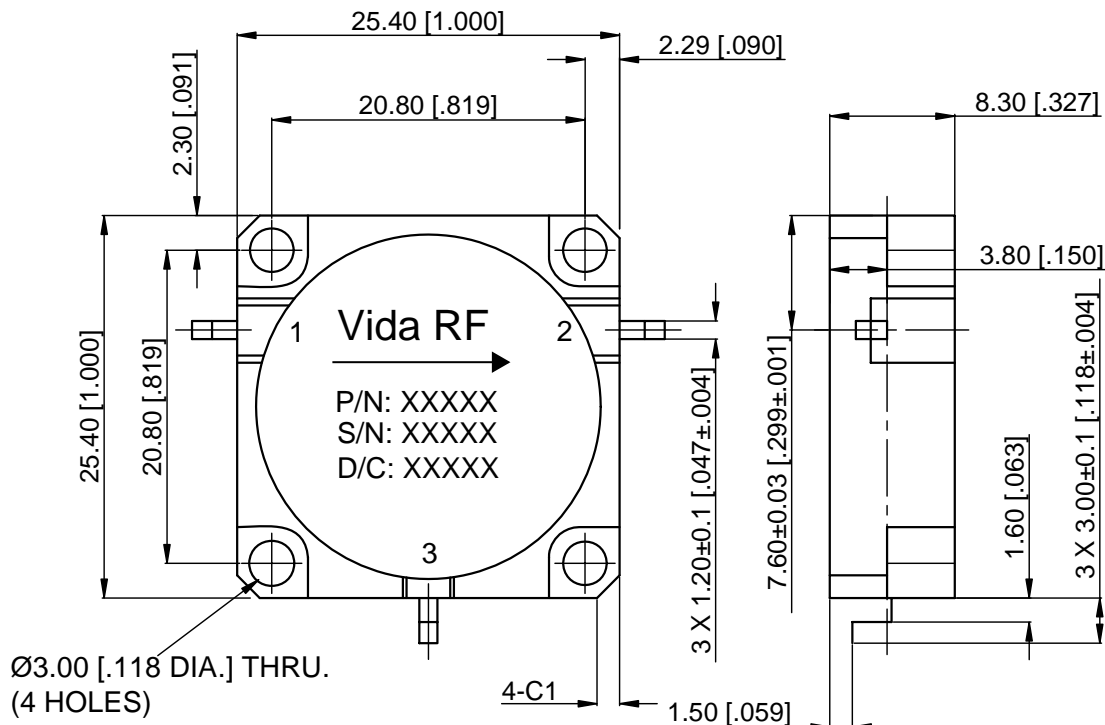

Drawn:	T. P	08/29/12	Title: <b>Drop-in Circulator</b>		
Checked:	D. R	08/29/12			
Approved:	S. K	08/29/12			
Description	Ecn.No	Date	Rev		



Tel:877-777-8432  
www.vidaRF.com

Unless otherwise specified dimensions are in millimeters, dimensions in [ ] are in inches for customer reference only.  
Unless Otherwise Specified tolerance are:

- .XX ±0.13 [.005"]
- .X ±0.20 [.008"]
- X ±0.50 [.019"]
- .X° ±1°
- X° ±2°

Cage Code  
**6KQ83**

Part No:  
**VDC-1919-2**

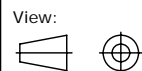

Size:	Scale:	Sheet:	Rev:
A4	2:1	1/1	A