

## Waveguide Isolators

Part Number: KTWI100-28

### Main Features:

- Broad Frequency Range: 8.2GHz -12.5GHz
- High Isolation, Low Insertion Loss, Small Size
- Wide Operating Temperature: -40°C~+80°C
- Commercial, Military and Space Applications

### Electrical Specifications at Room Temperature:

| Part Number | Freq. Range (GHz) | Bandwidth Max. (MHz) | Insertion Loss Max. (dB) | Isolation Min. (dB) | VSWR Max. | Waveguide Type |
|-------------|-------------------|----------------------|--------------------------|---------------------|-----------|----------------|
| KTWI100-28  | 8.2 - 12.5        | 1000                 | 0.3                      | 23                  | 1.20      | WR90           |
| KTWI100-28  | 8.2 - 12.5        | 2000                 | 0.4                      | 20                  | 1.25      | WR90           |

### Mechanical Dimensions (mm):

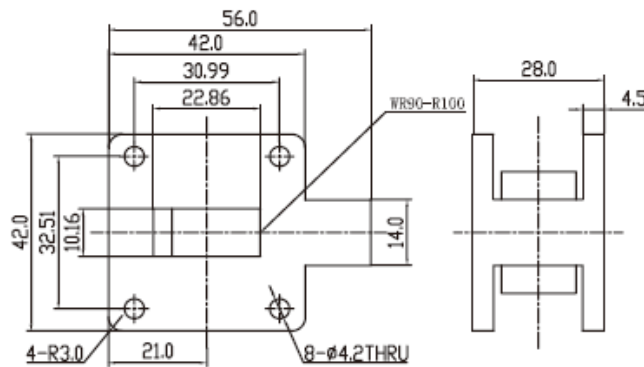

### HOW TO ORDER

