

REV.	DESCRIPTION	DATE	APPROVED
NC	INITIAL RELEASE		

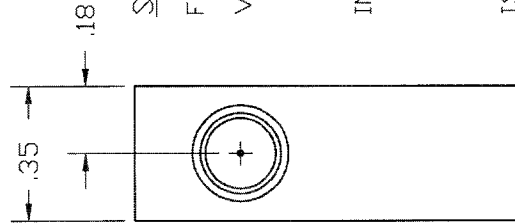
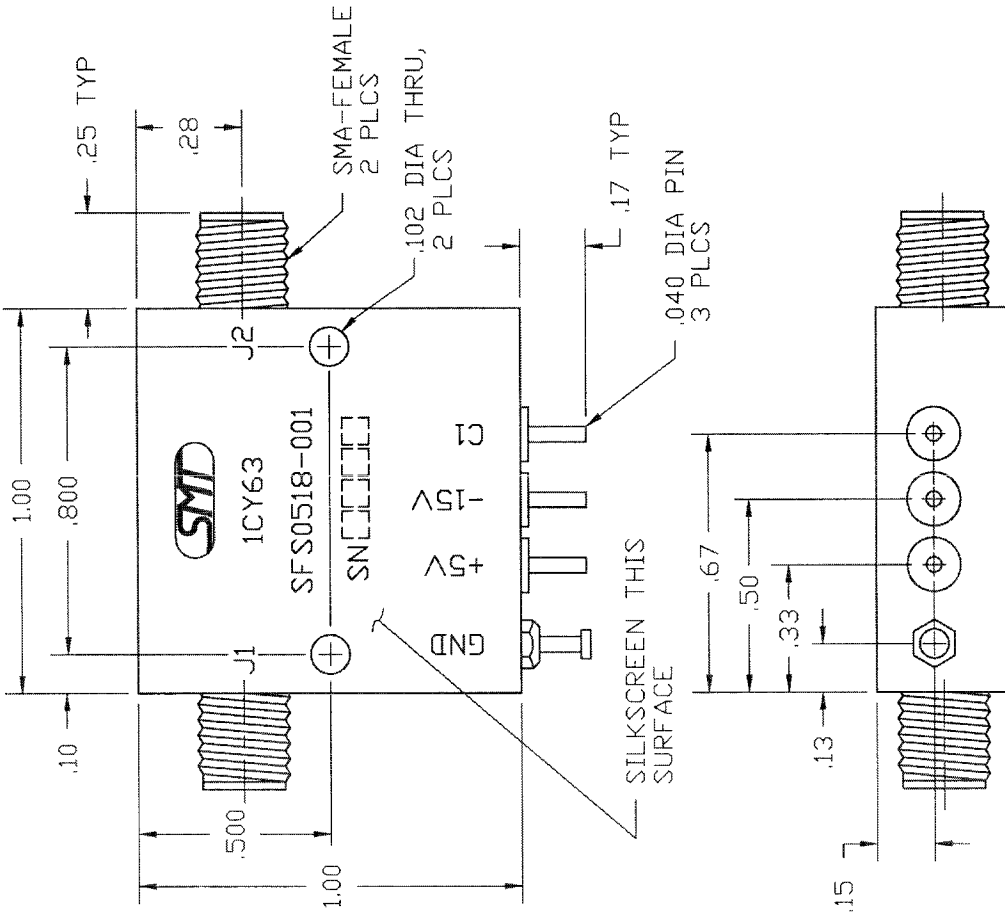

SPECIFICATIONS

FREQUENCY: 0.5 TO 18.0 GHz

VSWR: 0.5-4.0 GHz ----- 1.5:1 MAX
4.0-8.0 GHz ----- 1.6:1 MAX
8.0-18.0 GHz ----- 1.8:1 MAX

INSERTION LOSS: 0.5-4.0 GHz ----- 1.1 dB MAX
4.0-8.0 GHz ----- 1.4 dB MAX
8.0-12.0 GHz ----- 1.6 dB MAX
12.0-18.0 GHz ----- 2.0 dB MAX

ISOLATION: 0.5-18.0 GHz ----- 60 dB MIN

SWITCHING SPEED: 25 nSEC MAX
(50% TTL to 10/90% RF)

TEMPERATURE:
OPERATING: -55° TO +100°C
STORAGE: -65° TO +125°C

POWER SUPPLY:
+5V @ 50 mA MAX
-15V @ 50 mA MAX

CONTROL AT C1:
TTL LOW - INSERTION LOSS
TTL HIGH - ISOLATION

FRACTIONS DECIMALS ANGLES ± .XX± .02 ± XXX± .00		APPROVALS		DATE	
MATERIAL		DRAWN WILSON			
FINISH		CHECKED			
		ISSUED			
NEXT ASSY USED ON		SIZE FSCM NO.		DWG. NO.	
SFS0518-001		B		1CY63	
APPLICATION		SCALE		REV.	
				605-0160-001	
				OUTLINE FOR SFS0518-001	
				SIERRA MICROWAVE TECHNOLOGY	