



**SMD INDUCTOR DR349-1 SERIES**
**Features**

- Low Profile Surface Mount Design
- Suitable for Reflow soldering
- Inductance Range from 10nH to 220μH
- Operating Temp. -40°C to +85°C
- Tinned Leads with Leaded Solder is Available (note 4)

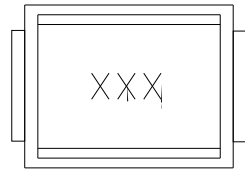

**ELECTRICAL SPECIFICATIONS AT 25°C**

PART NO.	INDUCTANCE (μH)		DCR (Ω) MAX.	MAX. RATED CURRENT(mA)
DR349-1-100	0.010±20%	@100MHz	0.13	450
DR349-1-150	0.015±20%	@100MHz	0.16	450
DR349-1-220	0.022±20%	@100MHz	0.20	450
DR349-1-330	0.033±20%	@100MHz	0.24	450
DR349-1-470	0.047±20%	@100MHz	0.30	450
DR349-1-680	0.068±20%	@100MHz	0.36	450
DR349-1-101	0.10±20%	@25.2MHz	0.44	450
DR349-1-121	0.12±20%	@25.2MHz	0.22	450
DR349-1-151	0.15±20%	@25.2MHz	0.25	450
DR349-1-181	0.18±20%	@25.2MHz	0.28	450
DR349-1-221	0.22±20%	@25.2MHz	0.32	450
DR349-1-271	0.27±20%	@25.2MHz	0.36	450
DR349-1-331	0.33±20%	@25.2MHz	0.40	450
DR349-1-391	0.39±20%	@25.2MHz	0.45	450
DR349-1-471	0.47±20%	@25.2MHz	0.50	450
DR349-1-561	0.56±20%	@25.2MHz	0.55	450
DR349-1-681	0.68±20%	@25.2MHz	0.60	450
DR349-1-821	0.82±20%	@25.2MHz	0.65	450
DR349-1-102	1.0±10%	@7.96MHz	0.70	400
DR349-1-122	1.2±10%	@7.96MHz	0.75	390
DR349-1-152	1.5±10%	@7.96MHz	0.85	370
DR349-1-182	1.8±10%	@7.96MHz	0.90	350
DR349-1-222	2.2±10%	@7.96MHz	1.0	320
DR349-1-272	2.7±10%	@7.96MHz	1.1	290
DR349-1-332	3.3±10%	@7.96MHz	1.2	260
DR349-1-392	3.9±10%	@7.96MHz	1.3	250
DR349-1-472	4.7±10%	@7.96MHz	1.5	220
DR349-1-562	5.6±10%	@7.96MHz	1.6	200
DR349-1-682	6.8±10%	@7.96MHz	1.8	180
DR349-1-822	8.2±10%	@7.96MHz	2.0	170
DR349-1-103	10±10%	@2.52MHz	2.1	150
DR349-1-123	12±10%	@2.52MHz	2.5	140
DR349-1-153	15±10%	@2.52MHz	2.8	130
DR349-1-183	18±10%	@2.52MHz	3.3	120
DR349-1-223	22±10%	@2.52MHz	3.7	110
DR349-1-273	27±10%	@2.52MHz	5.0	80
DR349-1-333	33±10%	@2.52MHz	5.6	70
DR349-1-393	39±10%	@2.52MHz	6.4	65
DR349-1-473	47±10%	@2.52MHz	7.0	60
DR349-1-563	56±10%	@2.52MHz	8.0	55
DR349-1-683	68±10%	@2.52MHz	9.0	50
DR349-1-823	82±10%	@2.52MHz	10	45
DR349-1-104	100±10%	@0.796MHz	10	40
DR349-1-124	120±10%	@0.796MHz	11	70
DR349-1-154	150±10%	@0.796MHz	15	65
DR349-1-184	180±10%	@0.796MHz	17	60
DR349-1-224	220±10%	@0.796MHz	21	50

**MECHANICAL OUTLINES**

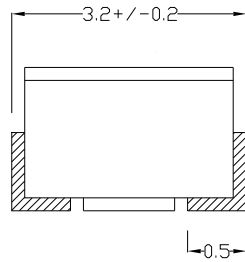

TOP VIEW



FRONT VIEW

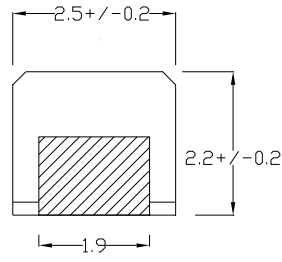

SIDE VIEW

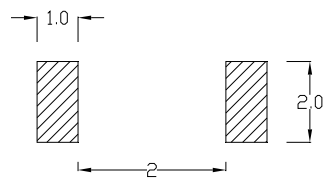

PCB SOLDER PAD LAYOUT (REF.)

**NOTES:**

1. All dimensions are shown in millimeters "mm".
2. General tolerance  $\pm 0.1$ mm unless otherwise specified.
3. Tape and reel quantity, 2000 pcs/reel
4. For non-RoHS parts replace DR prefix with 42- (e.g. DR349-1 becomes 42-349-1).
5. Terminal finish is compliant to RoHS requirements. Solder in accordance with J-STD-020D.