

- 1.0 PERFORMANCE
 1.1 FREQUENCY RANGE: DC-4GHz
 1.2 VOLTAGE RANGE: 500V RMS (sea level)
 1.3 NOMINAL IMPEDANCE: 50 OHMS
 1.4 DWV: 1500V RMS @ 60Hz (sea level)
 1.5 TEMPERATURE RANGE: -65°C TO +165°C
 2.0 MATERIALS
 2.1 DIELECTRIC: PTFE

- 2.2 CENTER CONTACT: BeCu
 2.3 LOCKWASHER: PHOS. BRONZE
 2.4 ALL OTHER METAL PARTS: BRASS
 2.5 GASKET: SI RUBBER
 3.0 FINISHES: SEE TABLE
 4.0 MECHANICAL
 4.1 INTERFACE IN ACCORDANCE WITH MIL-STD-348

DWG NO. OL-0910-70-1		REV. B
PART NUMBER	BODY	CONTACT
0910-70	NICKEL	SILVER

PLATING PER SAN-TRON SPEC. 7.3.1-8

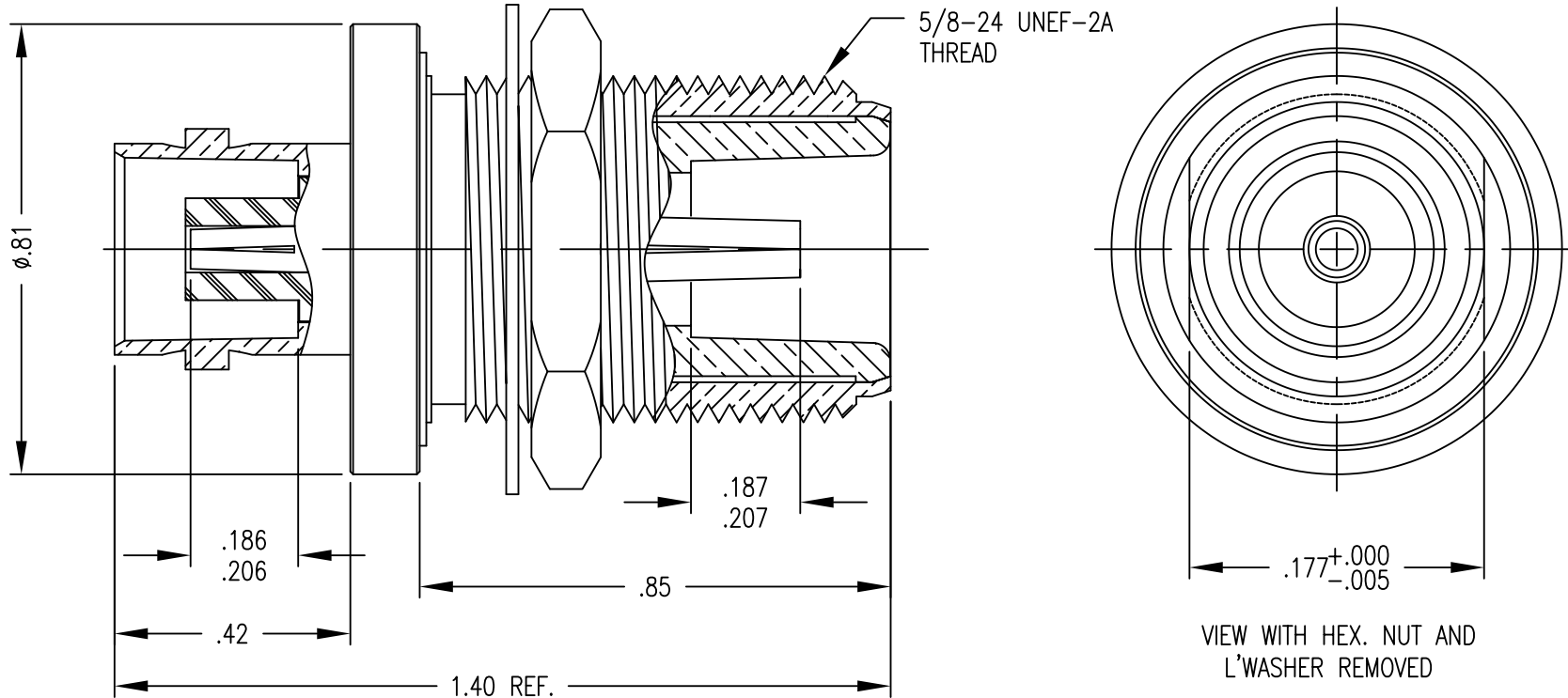

DO NOT SCALE DRAWING

Rev.	Revisions	Disp.	Date	Dwn.	Appd.
B	UPDATED TITLE BLOCK, PLATING TABLE & OL NOTES	NEW	3/30/10	JTH	JTH
A	ORIGINAL	NEW	10/07/02		
Ref.:	REMOVE ALL BURRS AND SHARP EDGES .005 MAX.	INTERPRET PER ASME Y14.5M-1994			
SK-					

THIS DRAWING CONTAINS CONFIDENTIAL INFORMATION PROPRIETARY TO SAN-TRON, INC. IT MUST NOT BE REPRODUCED OR DISCLOSED TO OTHERS OR USED IN ANY OTHER WAY, IN WHOLE OR PART EXCEPT AS AUTHORIZED IN WRITING BY SAN-TRON, INC.

UNLESS OTHERWISE SPECIFIED:
 ALL DIMENSIONS ARE IN INCHES.
 ALL DIMENSIONS ARE AFTER PLATING.
 .XXX= ±.005 ALL MACHINED SURFACES 64/ MAX.
 .XX= ±.01 ANG.±1/2' FRACTIONAL= ±1/64
 ◎.004 MAX. TIR. ⊥ AXIS .001

DWN LAP 10/07/02
 CHKD
 APPR

THIRD ANGLE PROJECTION

SAN-TRON, INC.
 4 NEWBURYPORT TPK. IPSWICH MA USA 01938
 TEL: 978 - 356 -1585 FAX: 978 - 356 -1573
 WWW. santron.com E MAIL: santron@santron.com

San-Tron

TITLE ADAPTER, BNC (F) TO N (F), STRAIGHT, BULKHEAD

MATERIAL: SEE NOTES FINISH: SEE TABLE

CAGE CODE: 50896 DWG NO. OL-0910-70-1 REV. B
 SCALE X:X