

**Key Features:**

- Frequency range: 9.0~11.0GHz
- WR-90 waveguide
- Power handling >60Watts CW, 60kW pulse
- Customer specify center frequency and bandwidth

**Electrical Specifications**

Part No.	Freq Range MHz	Insertion Loss, dB	Reverse Isolation, dB	VSWR	CW Power, Watts	Pulse Power, kWatts	Temp. Range, °C
F3672-0940-06	9100~9700	0.4 Max	≥ 20	≤1.2	≥ 60	≥ 60	-45 ~ +65
F3672-0960-05	9350~9850	0.4 Max	≥ 20	≤1.2	≥ 60	≥ 60	-45 ~ +65

**Mechanical Structure:**

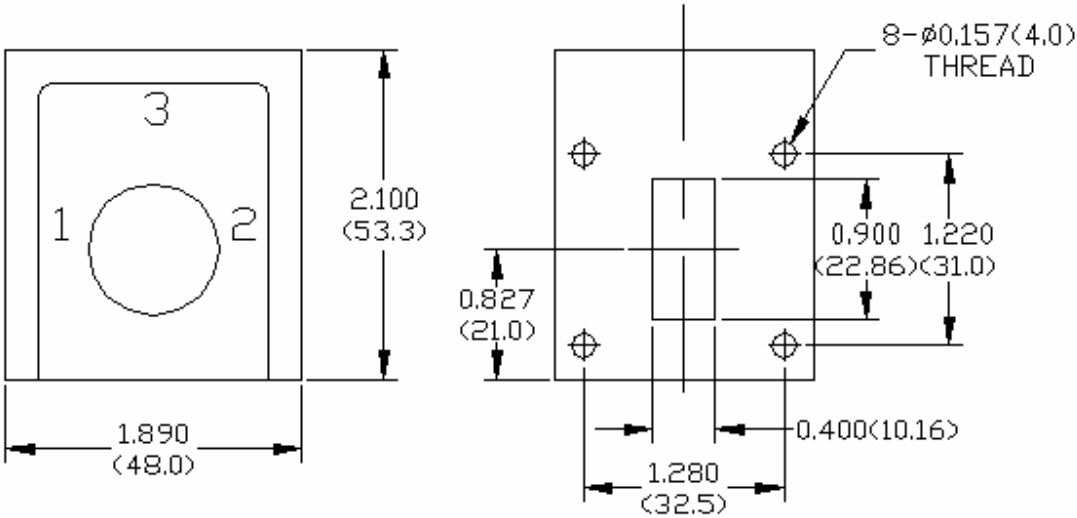

All units in inch (mm)

**Ordering Information:**

