

REV -	AUTH RL	DATE 03/30/07	INITIAL RELEASE
REV A	AUTH BF	DATE 4-2-09	34.12 WAS 33.40, ADDED 1.12 NECK
REV B	AUTH M.R.	DATE 12/11/09	MOUNT LOCATION CORRECTED, WAS 13.42

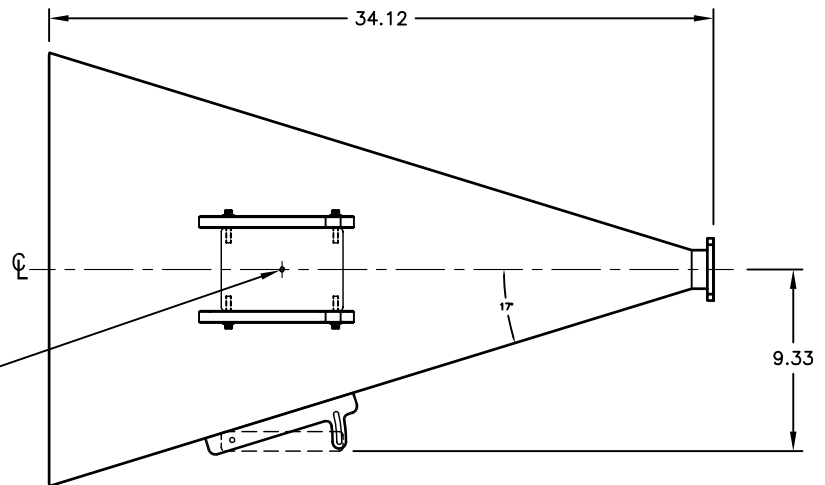
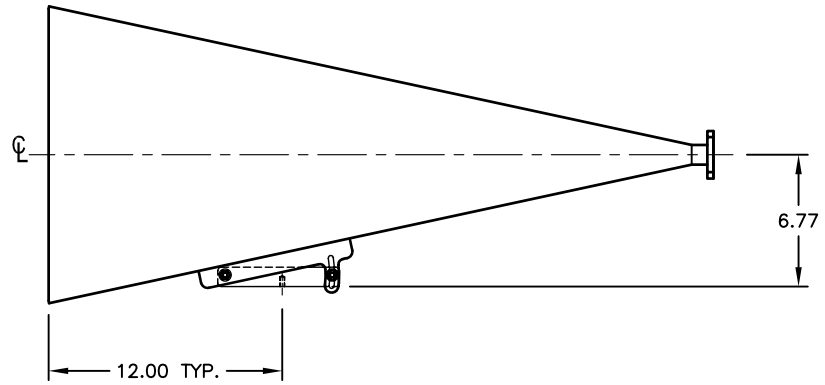
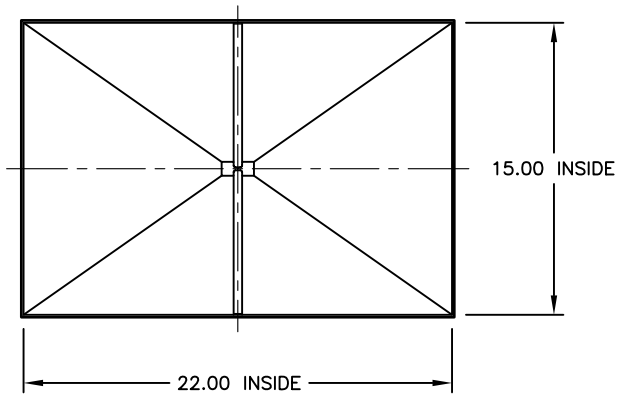

1/4-20 x 1 PLC.  
(1 MOUNTING BLOCK PER ASSY.)

**MODEL SPECIFICATIONS**

**MECHANICAL**

MODEL NUMBER: 250-442-XX  
 MATERIAL: 6061/T-6 ALUM.  
 FINISH: UNIQUE CORROSION RESISTANT  
 316 STAINLESS STEEL EPOXY COATING  
 FLANGE: C2 (ALL TAPPED). SEE ATM WEBSITE  
 FOR MORE POSSIBLE OPTIONS

**ELECTRICAL**

FREQ. RANGE: 2.5 - 7.5 GHz  
 GAIN: 18-20 dB (LOW TO HIGH FREQ.)  
 VSWR: 1.60 MAX.

THIRD ANGLE PROJECTION:		APPROVALS	DATE	<b>ADVANCED TECHNICAL MATERIALS, INC.</b> TEL: (631) 289-0363 FAX: (631) 289-0358 www.atmmicrowave.com		<small>THE INFORMATION IN THIS DRAWING IS PROPRIETARY AND SHALL NOT BE USED OR DISCLOSED WITHOUT THE PRIOR WRITTEN CONSENT OF ATM, INC. DO NOT SCALE DWG.</small>	
UNLESS OTHERWISE NOTED, DIMENSIONS ARE IN INCHES, TOLERANCES ARE: FRACTIONS: ±1/64 ANGLES: ±1/2°				DRAWN RL	03/30/07	<b>OUTLINE, WRD250</b> <b>HORN ANTENNA, 18-20dB</b>	
				CHKD.			
BASIC DIMENSION	DECIMALS 2 PLACE 3 PLACE		APRVD.	MATERIAL ALUM. TREATMENT IRIDITE FINISH ATM STD. GRAY		SIZE A	REVISION B
UNDER 6"	±.02	±.005		CAGE CODE 0R8N4	ATM DWG # 8054		
6" - 12"	±.03	±.010		SCALE NONE	MODEL # 250-442-XX		
OVER 12"	±.06	±.015					SHEET 1/1