

SMA F/F BRASS BULKHEAD ADAPTER 18GHZ

SM4934

SPECIFICATIONS

ELECTRICAL

50 OHMS
VSWR 1.20:1 MAX @ 18 GHZ
FREQUENCY: 0-18 GHZ

MECHANICAL

100 CYCLES MIN
5 IN-LBS COUPLING NUT MATING
TORQUE

MATERIALS

BODY: AU PLATED BRASS
CONTACTS: BeCu
PLATING CONTACTS: Au PER MIL-G-45204
PLATING BODY: Au 3μ"
INSULATOR: TEFLON
INTERFACE: MIL-STD-348B

OPERATING TEMPERATURE; -40 to 100°C
ROHS COMPLIANT

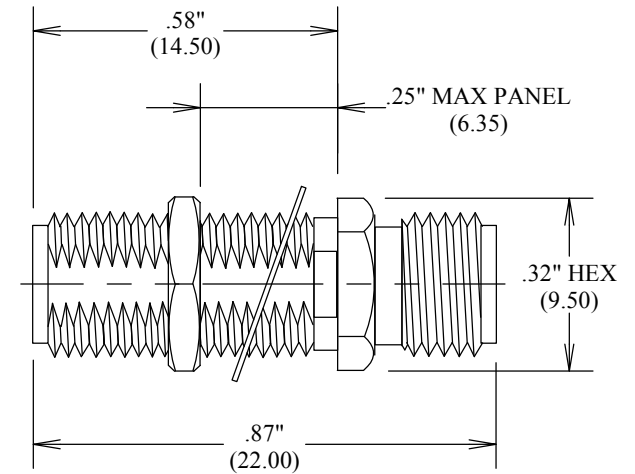

RECOMMENDED PANEL CUTOUT

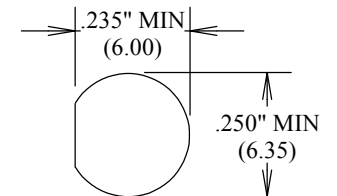

LOCKWASHER & GASKET SUPPLIED

MEASUREMENTS BELOW ARE TYPICAL

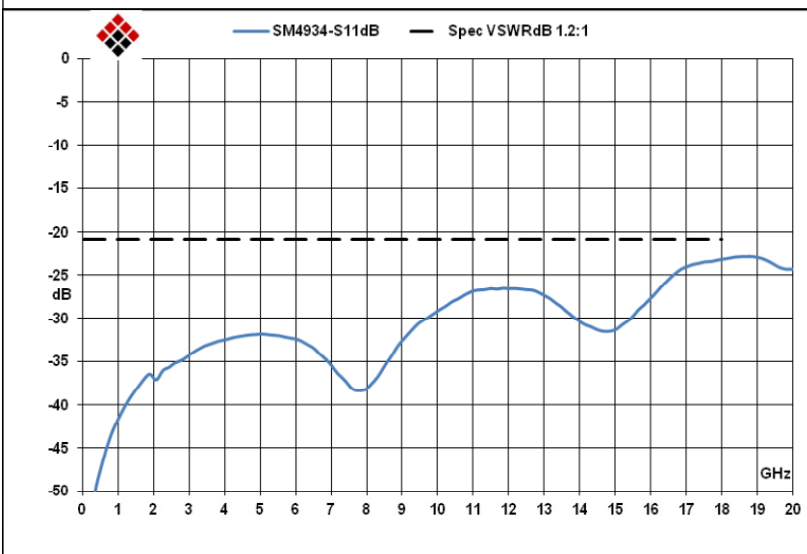

ALL DIMENSIONS IN inches(MM) Typical

FAIRVIEW MICROWAVE INC.

ALLEN, TX 75013 WWW.FAIRVIEWMICROWAVE.COM

TITLE

**SMA F/F BRASS BULKHEAD ADAPTER
18GHZ**

SIZE

A

CAGE CODE

3FKR5

DWG NO

SM4934

REV

A

SCALE

SHEET