

5

4

3

2

1

**PRODUCTION
RELEASE**

REVISIONS	
LTR	DESCRIPTION
A	ADDED DIFF FREQ'S TO SINGLE DWG
DATE	
8/18/08	
APPROVED	
T. KUHN	

ELECTRICAL
FREQUENCY RANGE _____ DC-6, 12.4 AND 18GHZ

VSWR

DC - 6GHz	_____	1.25:1 MAX
6 - 12.4GHz	_____	1.35:1 MAX
12.4 - 18GHz	_____	1.45:1 MAX

INPUT POWER _____ 50 WATTS AVG. @ 25°C
DERATED LINEARLY TO 10 WATTS @ 125°C

PEAK POWER _____ 500 WATTS
100µSec PULSE, 40% DUTY CYCLED

IMPEDANCE _____ 50 OHMS

OPERATING TEMP RANGE _____ -65°C TO +125°C

MECHANICAL

SMA CONNECTOR	_____	PASSIVATED STAINLESS STEEL
CONDUCTORS	_____	GOLD PLATED BERYLLIUM COPPER
HOUSING	_____	BLACK ANODIZED ALUMINUM

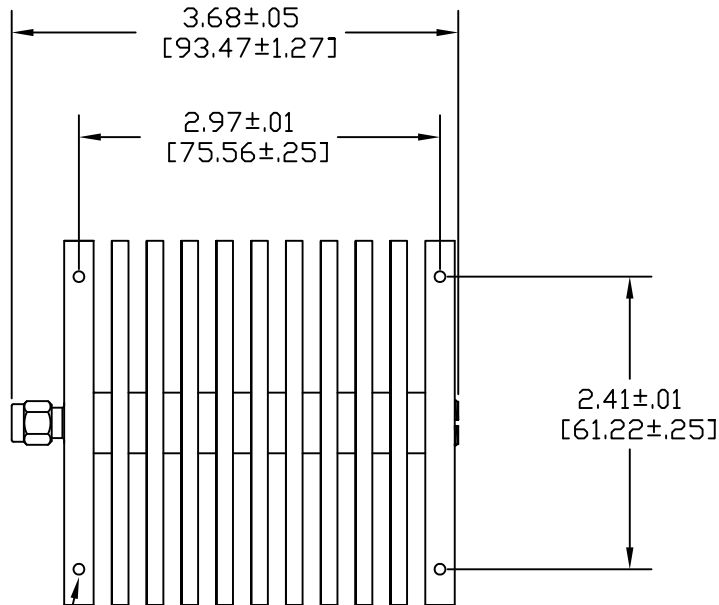
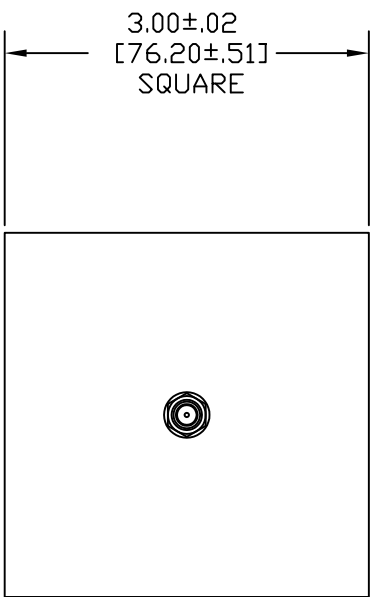

8X 4-40 UNC-2B TAP
X .250 [DP.]

D
C
B
A

D
C
B
A

DRAWING PRACTICES PER ANSI-Y-14.5 MIL-STD-100 & 1000	
DIMENSIONS ARE IN INCHES AND APPLY BEFORE/AFTER PROCESSING	
SURFACE ROUGHNESS	63 ✓
FINISH	SEE NOTES
MATERIAL	SEE NOTES

UNLESS OTHERWISE SPECIFIED	
TOLERANCES IN:	
DECIMALS	INCH MM
.X"	.03" [.76]
.XX"	.010" [.25]
.XXX"	.005 [.127]
.XXXX"	.0005" [.013]
ANGLES ±0°30'	
REMOVE ALL BURRS/SHARP W/ BREAK / R OF .003" TO .0005" UNLESS OTHERWISE NOTED DIAS CONCENTRIC <.003 T.I.R.	

DRAWN	DATE
T. KUHN	2/13/07
CHECKED	DATE
T. KUHN	2/13/07
ENG.	DATE
T. KUHN	2/13/07
THESE DRAWINGS AND SPECIFICATIONS ARE THE PROPERTY OF XMA CORP. OR OMNI SPECTRA AND SHALL NOT BE REPRODUCED, COPIED NOR USED - IN WHOLE OR IN PART - AS A BASIS FOR THE MANUFACTURE OR SALE OF OTHER ITEMS WITHOUT THE EXPRESS WRITTEN PERMISSION OF XMA CORP.	

XMA Omni Spectra™	
150 Dow Street, Manchester, NH 03101	
P:603-222-2256 F:603-222-2259	
TITLE	
OUTLINE DRAWING	
50 W TERM, SMA MALE	
SIZE	CAGE CODE
B	3HT76
DRAWING NUMBER	
2001-7550-XX	
SCALE	PLATED AREA
1:1	XXX
SHEET 1 OF 1	

5

4

3

2

1

BCSI