

SMP F/F ADAPTER .569" OAL

SM2618

SPECIFICATIONS

ELECTRICAL:

FREQUENCY: 0-40 GHZ
VSWR 1.20:1 MAX @ 26.5GHZ
IMPEDANCE: 50 OHMS
OP. TEMP RANGE: -55° to +125°C

MECHANICAL:

MATERIAL BODY: BeCu
CENTER CONTACTS: BeCu
PLATING: Au PER MIL-G-45204
INSULATOR: TEFLON
INTERFACE: SMP DESC 94007

SMP-F
DESC 94007

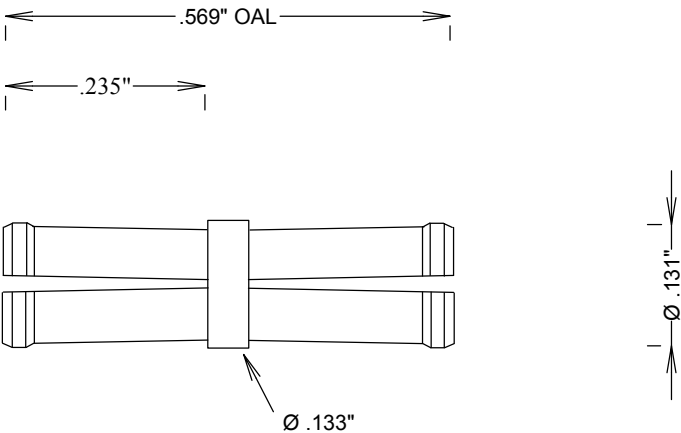

FAIRVIEW MICROWAVE INC.
ALLEN, TX 75013 WWW.FAIRVIEWMICROWAVE.COM

TITLE
SMP F/F ADAPTER .569" OAL

SIZE	CAGE CODE	DWG NO	REV
A	3FKR5	SM2618	--
SCALE	SHEET		