

# SMP-MALE PCB FULL DETENTE

SC5351

## SPECIFICATIONS

### ELECTRICAL:

FREQUENCY: 0-18 GHZ  
IMPEDANCE: 50 OHMS  
OP. TEMP RANGE: -55C- +155C

### MECHANICAL:

MATERIAL BODY: BeCu  
CENTER CONTACT: BeCu  
PLATING: Au MIL-G-45204  
INSULATOR: TEFLON  
INTERFACE: DESC 94007

FULL DETENTE  
FORCE TO ENGAGE: 15 LBS MAX  
FORCE TO DISENGAGE: 5 LBS MIN

ROHS COMPLIANT

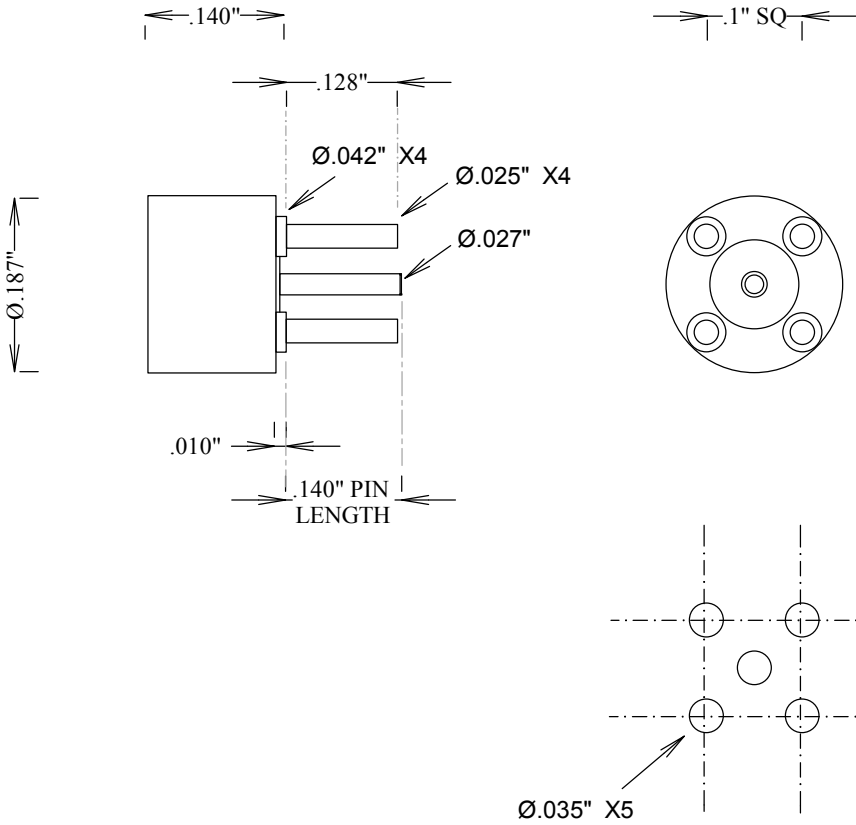

**FAIRVIEW MICROWAVE INC.**

ALLEN, TX 75013 WWW.FAIRVIEWMICROWAVE.COM

TITLE

**SMP-MALE PCB FULL DETENTE**

SIZE	CAGE CODE	DWG NO	REV
<b>A</b>	<b>3FKR5</b>	<b>SC5351</b>	<b>A</b>
SCALE	SHEET		