

7/16 FEMALE - 7/16 FEMALE LOW PIM ADAPTER

SM3382

SPECIFICATIONS

ELECTRICAL

FREQUENCY: 0-6 GHz
IMPEDANCE: 50 OHMS
VSWR: 1.06 MAX 3GHz 1.15:1 6GHz
PIMD 3RD: >165 dBc
USING 2 CW TONES@ 20W/TONE

MECHANICAL

MATERIALS 7/16 BODY:
SILVER PLATED BRASS
MATERIALS COUPLING NUT:
TRIMETAL PLATED BRASS
MATERIALS CONTACTS:
SI PLATED BeCu
DURABILITY: 500 CYCLES MIN
OTHER SPECIFICATIONS PER DIN 47223
OPERATING TEMP: -55°C TO +120°C
ROHS COMPLIANT

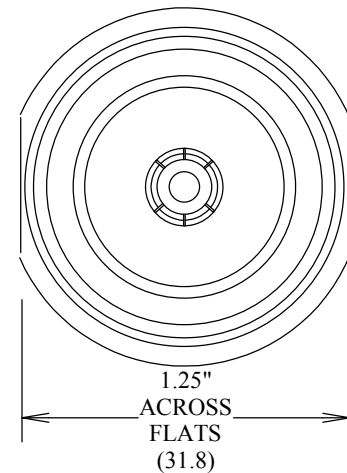
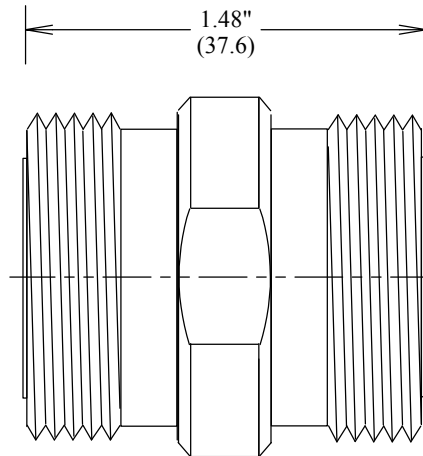

MEASUREMENTS BELOW ARE TYPICAL

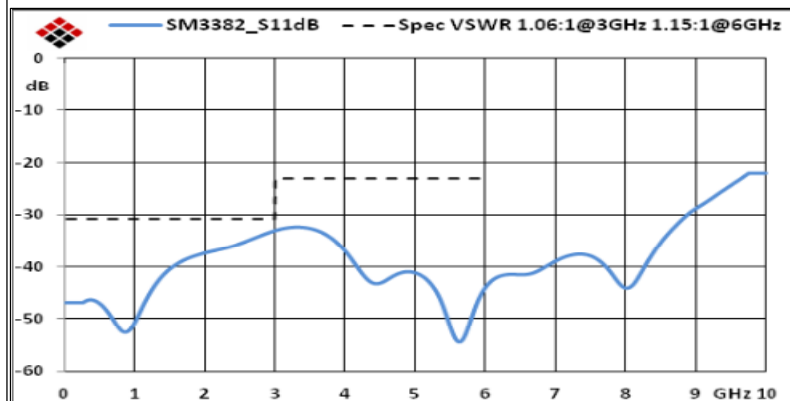

ALL DIMENSIONS IN inches(MM) Typical

FAIRVIEW MICROWAVE INC.

ALLEN, TX 75013 WWW.FAIRVIEWMICROWAVE.COM

TITLE

**7/16 FEMALE - 7/16 FEMALE
LOW PIM ADAPTER**

SIZE

A

CAGE CODE

3FKR5

DWG NO

SM3382

REV

A

SCALE

SHEET