

SMA/M SEMFLEX LA290 18 GHZ CONNECTOR

SC7218

SPECIFICATIONS

ELECTRICAL

FREQUENCY: 0-18 GHZ
 IMPEDANCE: 50 OHMS

MECHANICAL

MATERIALS BODY: PASSIVATED STAINLESS STEEL
 MATERIALS CONTACTS: BeCu
 CONTACT PLATING: Au PER MIL-G-45204
 DIELECTRIC: PFTE
 SOLDER FERRULE: BRASS PER ASTM-B16
 LOCK RING: BeCu PER ASTM-B197
 TEMPERATURE RANGE: -55° to +120°C
 INTERFACE: MIL-STD-348

ROHS COMPLIANT

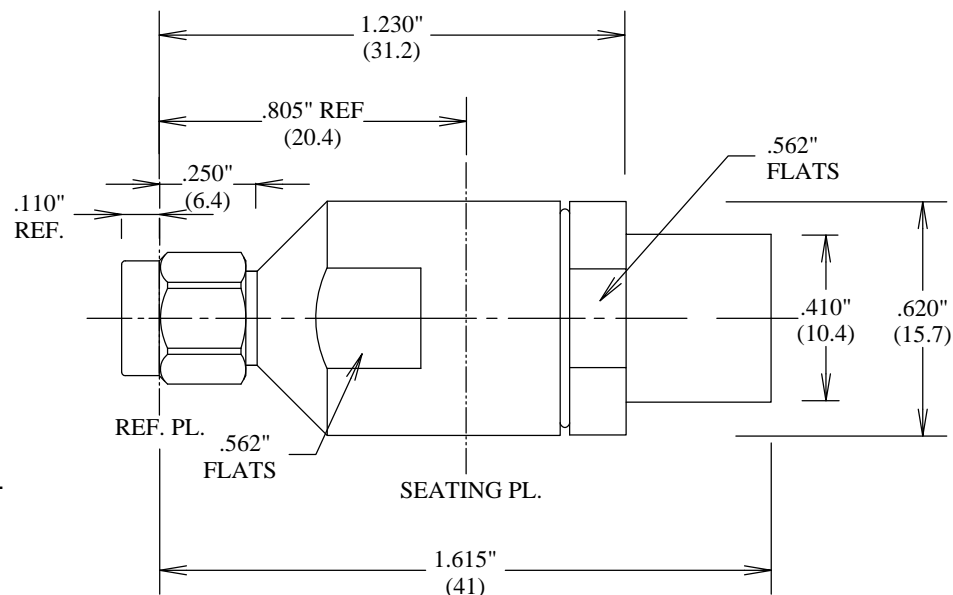

FAIRVIEW MICROWAVE INC.

ALLEN, TX 75013 WWW.FAIRVIEWMICROWAVE.COM

TITLE

**SMA/M SEMFLEX LA290
 18 GHZ CONNECTOR**

| | | | |
|----------|-----------|--------|-----|
| SIZE | CAGE CODE | DWG NO | REV |
| A | 3FKR5 | SC7218 | -- |

ALL DIMENSIONS IN inches(MM) Typical

| | |
|-------|-------|
| SCALE | SHEET |
|-------|-------|