

Key Features:

- Frequency range: 26.5~40.0GHz, bandwidth up to 3.5GHz
- WR-28 waveguide
- Power handling >10Watts CW forward
- Customer specify center frequency and bandwidth

Electrical Specifications

Part No.	Freq Range MHz	Insertion Loss, dB	Reverse Isolation, dB	VSWR	Forward Power, Watts	Temp. Range, °C
F3836-3325-09	31.80~34.70	0.5 Max	≥ 18	≤1.3	≥ 10	-10 ~ +50
F3836-3450-03	34.0~35.0	0.5 Max	≥ 20	≤1.2	≥ 10	-10 ~ +50
F3836-3500-10	33.25~36.75	0.5 Max	≥ 18	≤1.3	≥ 10	-10 ~ +50

Mechanical Structure:

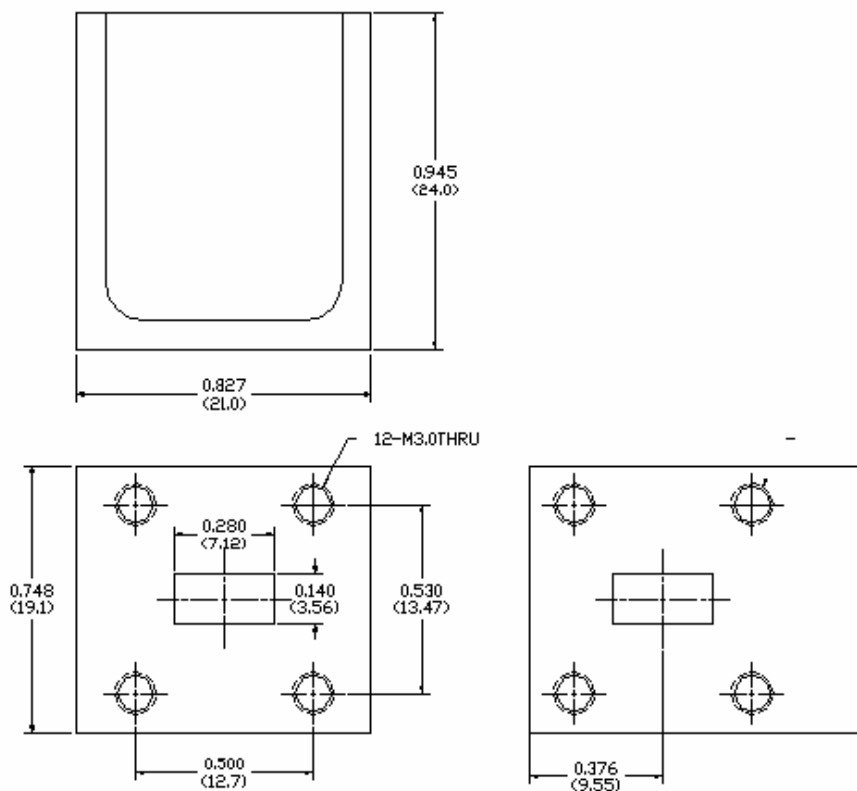

All units in inches

Ordering Information:

