

- 1.0 PERFORMANCE
 1.1 FREQUENCY RANGE: DC-18 GHz
 1.2 VSWR < {(1.10, 3GHz), (1.20, 7GHz), (1.30, 12.4GHz)}
 (1.50 18GHz)
 1.4 NOMINAL IMPEDANCE: 50 OHMS
 1.5 DW: 1500V RMS @ 60Hz (sea level)
 1.6 TEMPERATURE RANGE: -65°C TO +165°C
- 2.0 MATERIALS
 2.1 DIELECTRIC: PTFE, ASTM-D-1710
 2.2 CENTER CONTACT: BERYLLIUM COPPER, ASTM-B-196

- 2.3 GASKET: SILICON RUBBER, ZZ-R-765, GR. 50, RED
 2.4 LOCKWASHER: PHOSPHOR BRONZE, ASTM-B-159, ALLOY 510
 2.5 ALL OTHER METAL PARTS: BRASS, ASTM-B-16
 3.0 FINISHES: SEE TABLE
 3.1 SUFFIX -SGA: ALBALOY HARDWARE
 4.0 MECHANICAL
 4.1 INTERFACE IN ACCORDANCE WITH MIL-STD-348

DWG NO. OL-0910-20-1 REV. D

PART NUMBER	BODY	CONTACT
0910-20	NICKEL	GOLD/Cu
0910-20-KG	BLACK CHROME	GOLD/Cu
0910-20-SGA	SILVER	GOLD/Cu
0910-20-SS	SILVER	SILVER

PLATING PER SAN-TRON SPEC. 7.3.1-8

DO NOT SCALE DRAWING

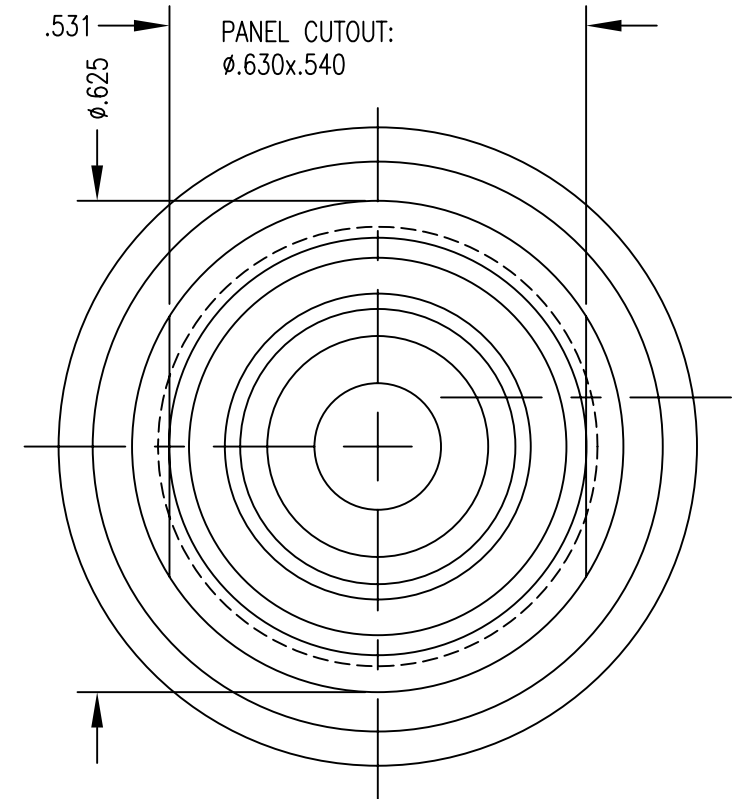
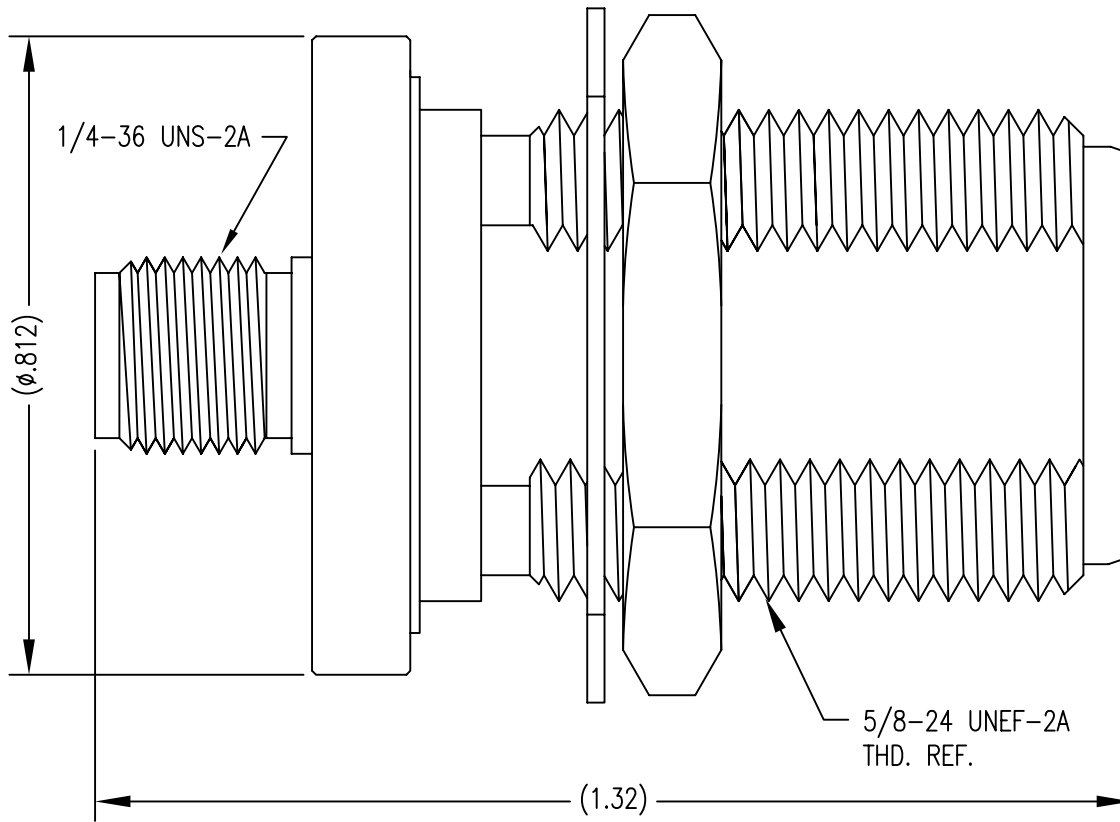

VIEW WITH NUT AND LOCKWASHER REMOVED

Rev.	Revisions	Disp.	Date	Dwn.	Appd.
D	WAS DMV 2500V	MIX	2-01-11	RJG	FSH
C	ADD PLATING -SS / ADD PANEL CUT DIMS	MIX	1-31-11	FSH	FSH
B	FREQ WAS 12.4 GHz & ADD PLATING CODE -SG	MIX	11/5/08	FSH	FSH
A	REDRAWN- REMOVED "SPIN OVER " NOTE	FIFO	3/31/03	LAP	FSH
A	ORIGINAL	NEW	03/16/98		

RECOM. STOCK SIZE	FT/M PCS	Ref. SK	REMOVE ALL BURRS AND SHARP EDGES .005 MAX.	INTERPRET PER ASME Y14.5M-1994
-------------------	----------	---------	--	--------------------------------

THIS DRAWING CONTAINS CONFIDENTIAL INFORMATION PROPRIETARY TO SAN-TRON INC. IT MUST NOT BE REPRODUCED OR DISCLOSED TO OTHERS OR USED IN ANY OTHER WAY, IN WHOLE OR PART EXCEPT AS AUTHORIZED IN WRITING BY SAN-TRON INCORPORATED.

UNLESS OTHERWISE SPECIFIED:
 ALL DIMENSIONS ARE IN INCHES.
 ALL DIMENSIONS ARE AFTER PLATING.
 .XXX= \pm .005 ALL MACHINED SURFACES \sqrt{R} MAX.
 .XX= \pm .01 ANG. \pm 1/2" FRACTIONAL= \pm 1/64
 (M) .004 MAX. TIR (L) AXIS .001

THIRD ANGLE PROJECTION

DWN	MM	03/16/98
CHKD	SJS	03/17/98
APPR	FSH	03/17/98

SAN-TRON, INC.
 4 NEWBURYPORT TPK. IPSWICH MA USA 01938
 TEL: 978 - 356 -1585 FAX: 978 - 356 -1573
 WWW. santron.com E MAIL: santron@santron.com

San-Tron

TITLE: ADAPTER, STRAIGHT, BULKHEAD MOUNT, N (F) TO SMA (F)

MATERIAL: SEE NOTE 2.0 FINISH: SEE NOTE 3.0

CAGE CODE: 50896 DWG NO. OL-0910-20-1 REV. D

SCALE: 4:1