

REV.	DATE	DESCRIPTION
NC	11/29/04	INITIAL RELEASE
A	11/13/07	UPDATE PUSH-ON BODY

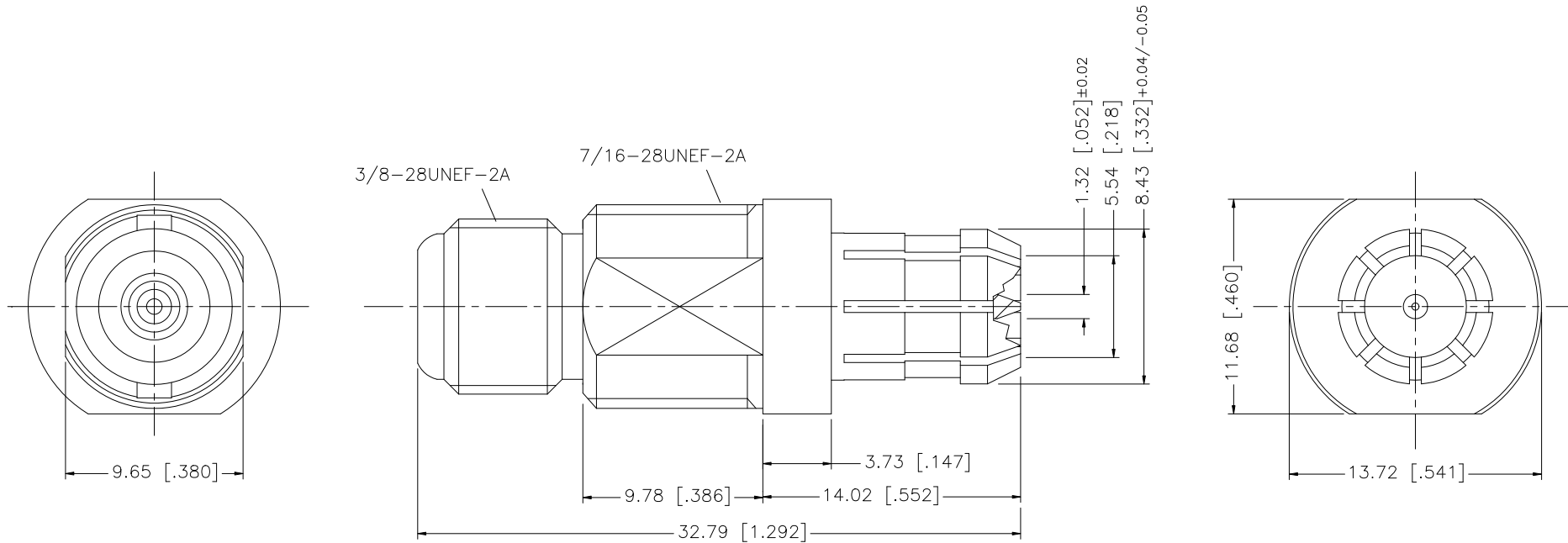

8					<small>UNLESS OTHERWISE SPECIFIED DIMENSIONS ARE IN MILLIMETERS. DIMENSIONS IN [ ] ARE IN INCHES AND FOR CUSTOMER REFERENCE ONLY.</small>  <small>UNLESS OTHERWISE SPECIFIED TOLERANCES FOR MILLIMETERS ARE:  0.5 - 8mm ± 0.20mm  8 - 30mm ± 0.40mm  30 - 120mm ± 0.50mm</small>  <small>UNLESS OTHERWISE SPECIFIED TOLERANCES FOR INCHES ARE:  .020 - .315 = ± 0.007"  .315 - 1.180 = ± 0.015"  1.180 - 4.724 = ± 0.020"</small>	APPROVALS	DATE	<h1 style="color: blue;">Amphenol Connex</h1>						
7				DRAWN		G.R.S.	11/13/07							
6				CHECKED				<b>PART DESCRIPTION</b>  <b>F JACK TO BNC PLUG THROUGH ADAPTER</b>						
5				ISSUED										
4				SHEET	1 OF 1		<b>PART NO.</b>  <b>112532-14</b>							
3	CONTACT PIN	BER. COPPER	GOLD	1										
2	INSULATOR	TEFLON	NATURAL	1			<b>DWG. NO.</b> 112532-14.DWG							
1	BODY	BRASS	NICKEL	1										
	DESCRIPTION	MATERIAL	FINISH	QTY	DO NOT SCALE DRAWING		CAD FILE	C:/112/112532-14.DWG	REV.	A	SIZE	A	SCALE	NA