

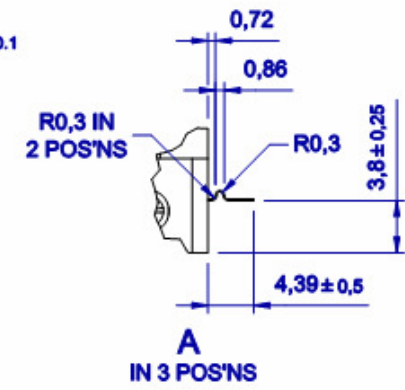

SCALE: ACTUAL SIZE

ELECTRICAL SPECIFICATION:

FREQUENCY RANGE: 1930 to 1990MHz
 INSERTION LOSS: 0.15dB Max. -10°C ~ 60°C
 0.25dB Max. -40°C ~ -10°C & 60°C ~ 100°C
 ISOLATION: 23dB Min. -10°C ~ 60°C
 21dB Min. -40°C ~ -10°C & 60°C ~ 100°C
 RETURN LOSS: 22dB Min
 IMD: -75dBc Max @ all temp. 2°35W spacing
 2M or 5M anywhere in the band
 OPERATING TEMP RANGE: -40°C ~ 100°C
 FORWARD POWER: 120W
 REVERSE POWER: 100W
 ATTENUATION: 30(+/-1)dB

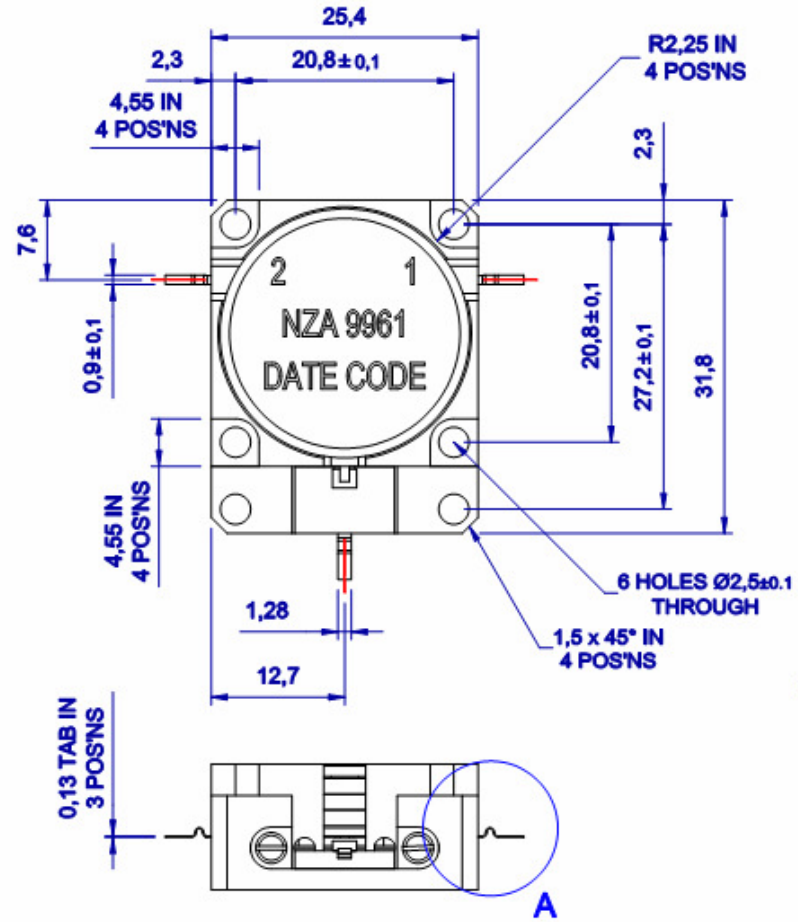
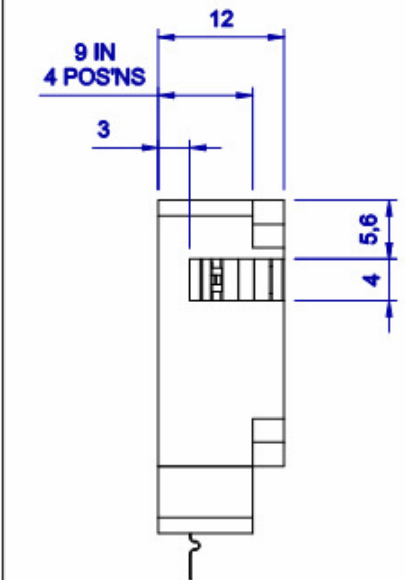

NOTES:

THIS UNIT IS ROHS COMPLIANT BY DESIGN.

LIGHTLY REMOVE ALL BURRS AND SHARP EDGES U.O.S.

Q.A.
DATE
PROD.REL.
DATE
ENG.APP.
DATE
MECH. ENG.
DATE
DRAWN AB.
DATE

ORIGINAL SCALE	N.T.S.	MATERIAL	SPECIFICATION
DO NOT SCALE PRINT			
DIMENSION IN	mm	FINISH	SPECIFICATION
CERTIFIED AT ISSUE		BODY: SILVER PLATED	

REF	DESCRIPTION	No OFF	CHAR.	POS.TOL	ISSUE	DATE	MOD NUMBER
RED (Fully Released)							A 3
GENERAL TOLERANCE UNLESS OTHERWISE STATED ± 0,25					CONTRACTOR		SECURITY CLASSIFICATION
FINISH TO BE 1.6 ✓ UNLESS OTHERWISE STATED					RESPONSIBLE AUTHORITY		CONTRACTORS DRAWING NUMBER
TITLE					SERVICE DRAWING NUMBER		SHEET No 1 OFF 1

B	DRN 9961
---	----------

MESL MICROWAVE

1930-1990 MHz ISO-ATTEN.
OUTLINE TYPE NZA 9961

9961-000-OL