

**Key Features:**

- Frequency range: 170~400MHz, up to 16% bandwidth
- Drop-in configuration
- Small size, low cost
- Power handling up to 200 Watts
- Operating temperature -20~+65°C
- Customer specify center frequency and bandwidth

**Electrical Specifications**

Part No.	Freq Range MHz	Insertion Loss, dB	Reverse Isolation, dB	VSWR	Forward Power, Watts	Temp. Range, °C
F1518-0185-16	170-200	0.5 Max	≥ 20	≤ 1.2	≥ 200	-20 ~ +65
F1518-0215-14	200-230	0.5 Max	≥ 20	≤ 1.2	≥ 200	-20 ~ +65

**Mechanical Structure:**

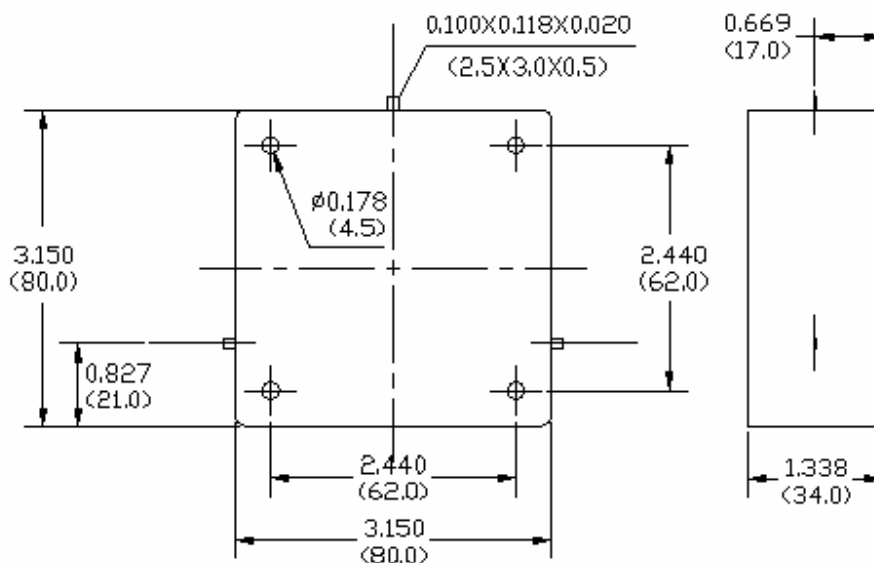

Note: All units in inches (mm).

**Ordering Information:**

