



Parameters Description	Unit	Minimum	Typical	Maximum
Center Frequency (Fo)	MHz	-	1220.0	-
Insertion Loss within 1216 ~ 1224 MHz	dB	-	3.5	4.8
Amplitude Ripple within 1216 ~ 1224 MHz	dBp-p	-	0.4	1.0
Group Delay Ripple within 1216 ~ 1224 MHz	nSp-p	-	40	-
<b>Attenuation:</b>				
Fo-200.0 ~ Fo-68.0 MHz	dB	46	51	-
Fo-88.0 MHz	dB	48	53	-
Fo-72.0 MHz	dB	50	58	-
Fo-44.0 MHz	dB	48	56	-
Fo-36.0 MHz	dB	46	59	-
Fo+70.0 ~ 2000.0 MHz	dB	50	61	-

Parameters Description	Unit	Minimum	Typical	Maximum
Operation Temperature Range	°C	-30	-	+80
Maximum DC Voltage	V	-	-	3
Maximum Input Power	dBm	-	-	0
Source Impedance (Balanced Ended) <sub>1</sub>	Ω	-	200	-
Load Impedance (Balanced Ended) <sub>1</sub>	Ω	-	200	-
Package Size and Type	3.0 x 3.0 x 1.3 mm		M	

**Note:** (1) With Matching Network ns



### Outline Drawing:

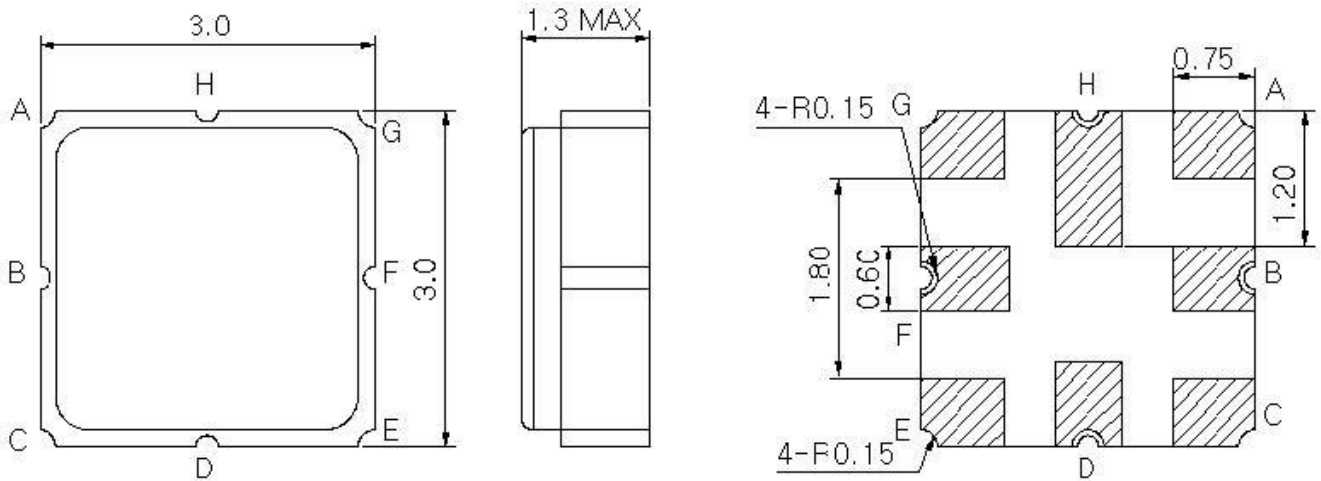

**PIN Descriptions: Balanced IN – A,B, Balanced OUT – E,F, GROUND – C,D,G,H**

### Testing Environment:

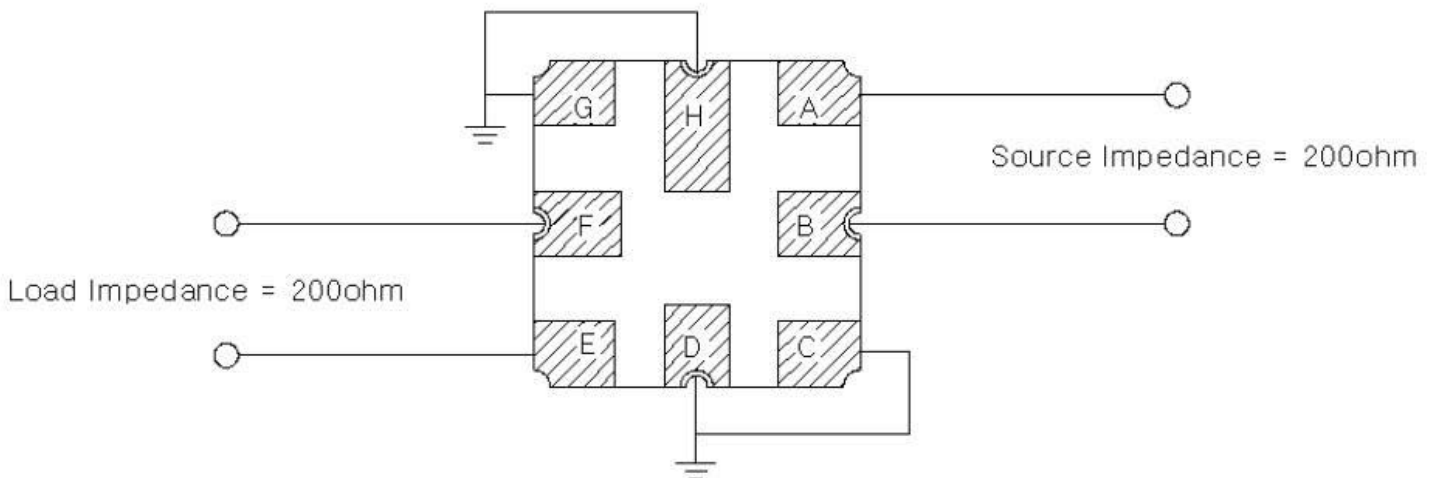



### Response Plot:

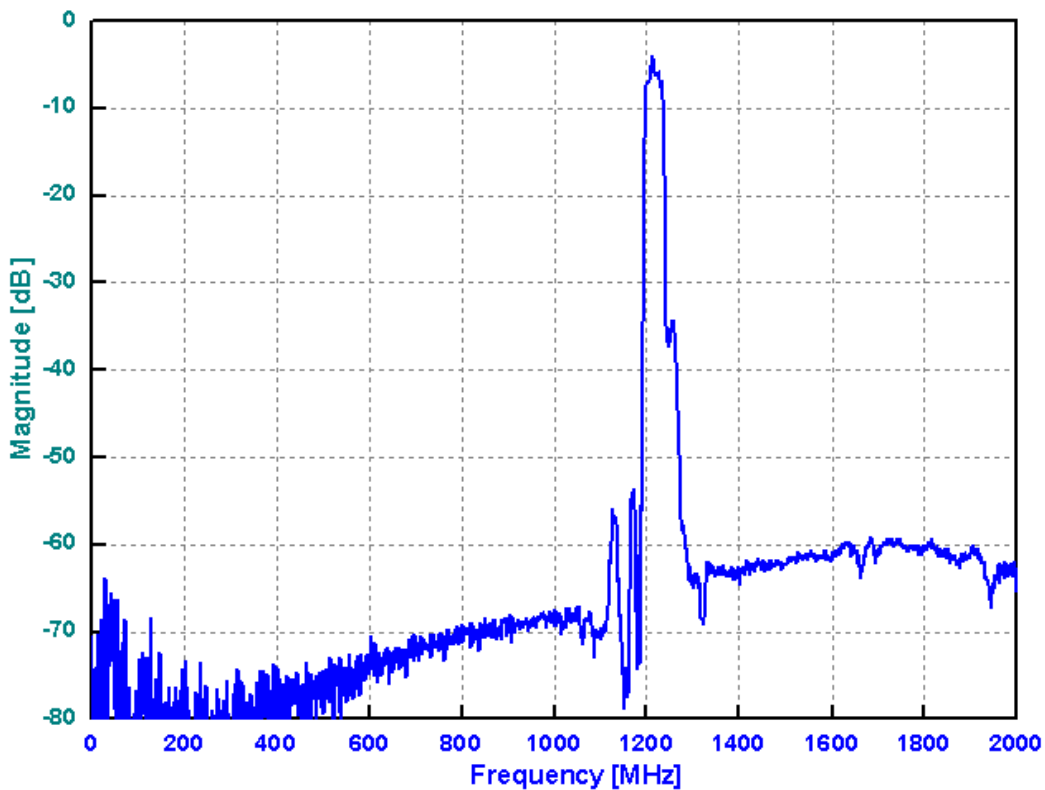
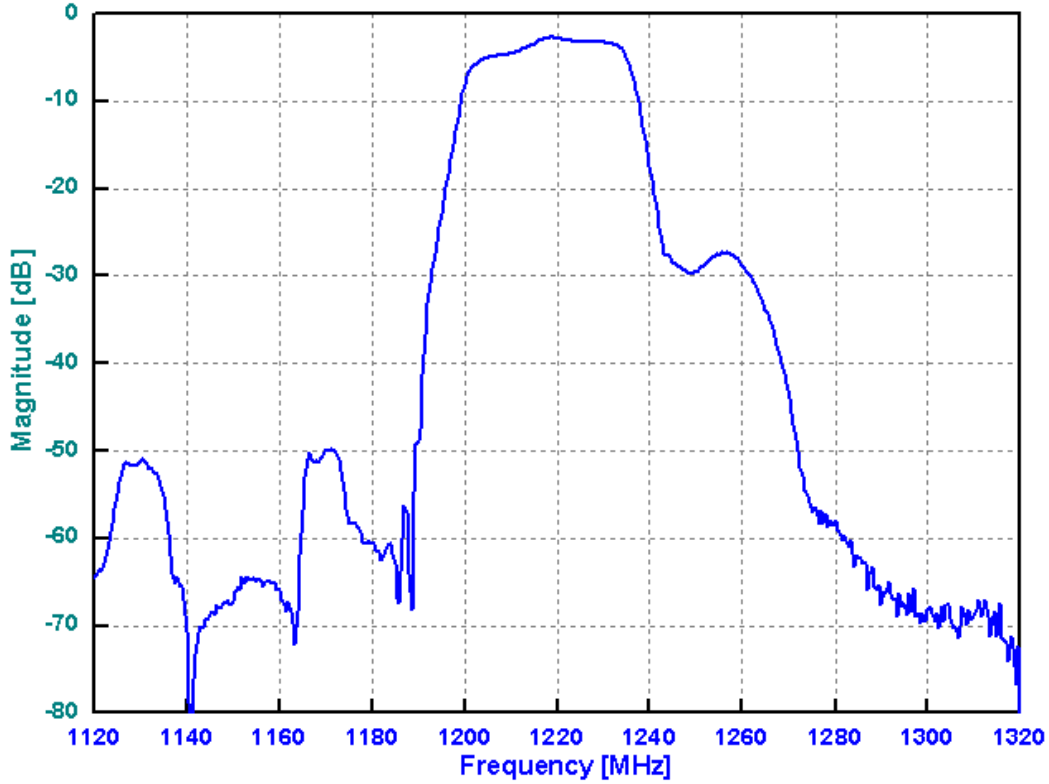



### VSWR

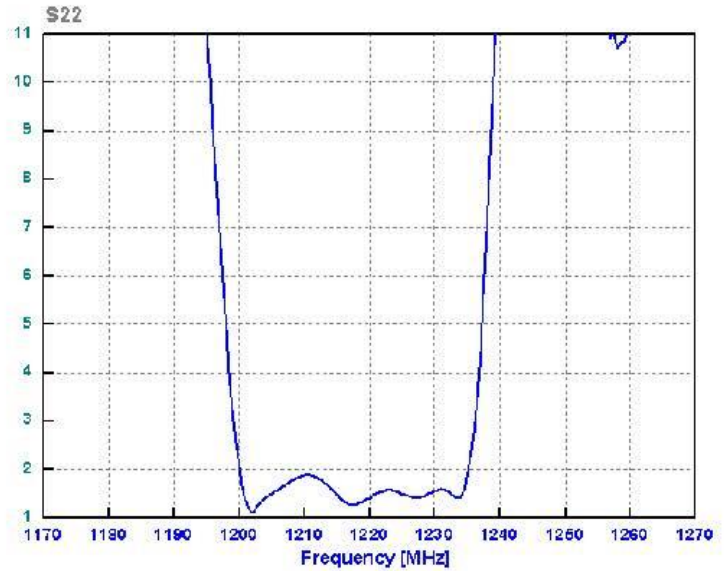
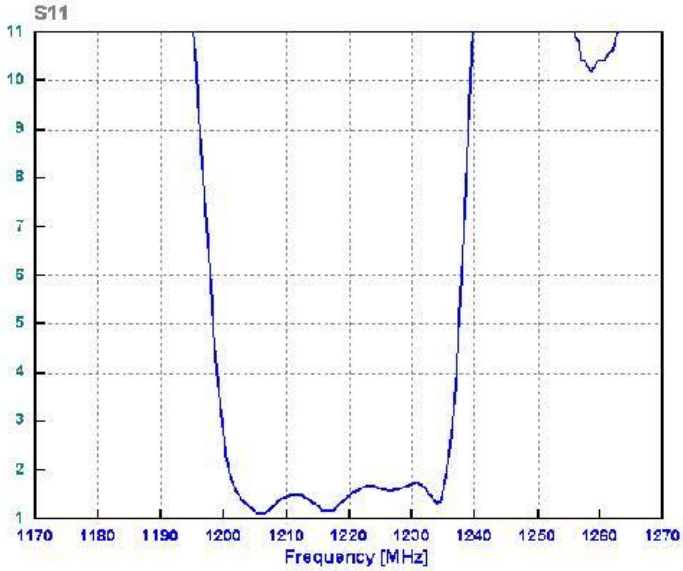

### SMITH CHART

