

**Key Features:**

- Center frequency range: 500~1200MHz, bandwidth up to 10%.
- Drop-in configuration
- Small size, low cost
- Power handling +400 Watts
- Operating temperature -10~+60°C
- Customer specify center frequency and bandwidth

**Electrical Specifications**

| Part No.      | Freq Range MHz | Insertion Loss, dB | Reverse Isolation, dB | VSWR  | Forward Power, Watts | Temp. Range, °C |
|---------------|----------------|--------------------|-----------------------|-------|----------------------|-----------------|
| F1535-0520-05 | 500~525        | 0.3 Max            | ≥ 20                  | ≤ 1.2 | 400                  | -10 ~ +60       |
| F1535-0915-03 | 900-930        | 0.3 Max            | ≥ 20                  | ≤ 1.2 | 400                  | -10 ~ +60       |
| F1535-1000-05 | 975~1025       | 0.3 Max            | ≥ 20                  | ≤ 1.2 | 400                  | -10 ~ +60       |

**Mechanical Structure:**

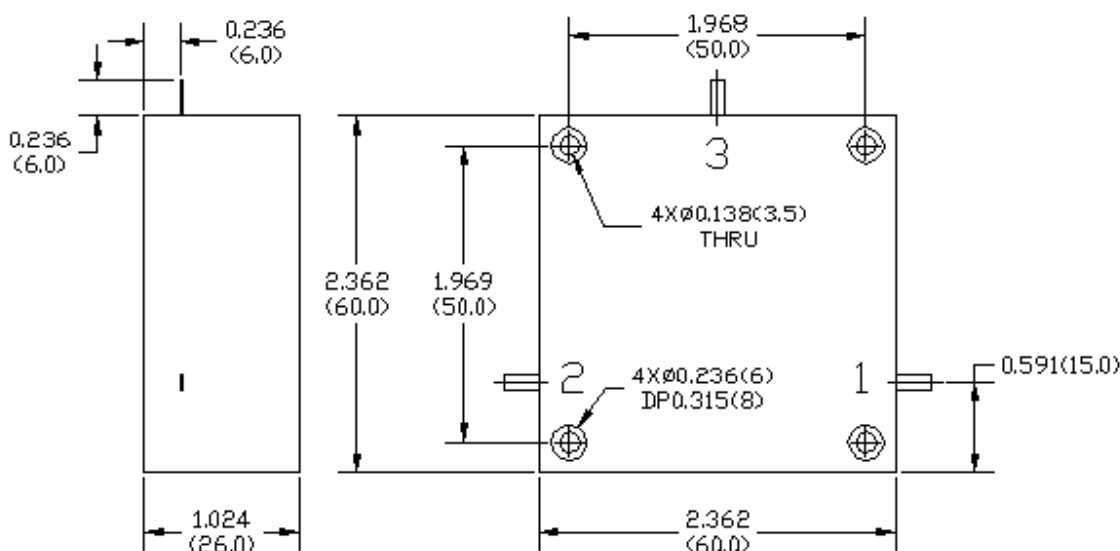

**Ordering Information:**

Note: All units in inches (mm).

