



ANATECH ELECTRONICS INC
RF & Microwave Filters & Products

GPS Ceramic BPF

Part Number: AM1575B446



Electrical specifications

Center Frequency: 1575 MHz
Bandwidth: 20 MHz
Input / Output Impedance: 50 Ohms
Passband: 1565.4-1585.4 MHz
Passband Insertion Loss: 1565.4-1585.4 MHz 1.0 dB
Passband Ripple: 1.0 dB max
Passband Return Loss: 1565.4-1585.4 MHz 29.0 dB
Rejection: 1500.4 MHz 29.0 dB min
Rejection 2: 1650.4 MHz
Power Handling: 1 W

Mechanical

Mounting Method: SMT
Dimensions: 38.60 x 11.75 x 5.70 mm

Environmental

Operating Temperature: -40°C to +85°C
Storage Temperature: -50°C to +90°C

This product is RoHs compliant.



Outline Drawing:

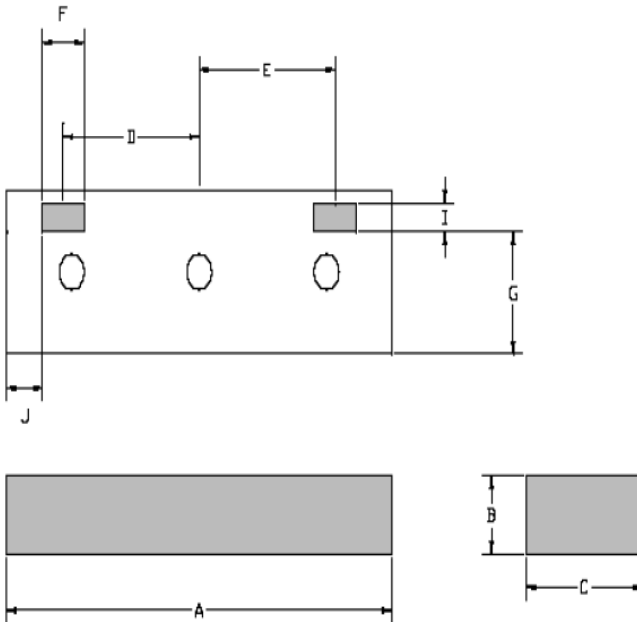

Dim	Nominal (mm)	Tolerance (mm) +/- or max
A	38.60	max
B	5.70	max
C	11.75	max
D	13.63	0.127
E	13.63	0.127
F	4.2	0.127
G	8.64	0.254
I	2.02	0.127
J	3.36	0.254



Response Plot:

