

# SMP-MALE PCB R/A FULL DETENTE

## SC5355

### SPECIFICATIONS

#### ELECTRICAL:

FREQUENCY: 0-18 GHZ

IMPEDANCE: 50 OHMS

OP. TEMP RANGE: -55C- +155C

#### MECHANICAL:

MATERIAL BODY: BeCu

CENTER CONTACT: BeCu

PLATING: Au MIL-G-45204

INSULATOR: TEFLON

INTERFACE: DESC 94007

FULL DETENTE

FORCE TO ENGAGE: 15 LBS MAX

FORCE TO DISENGAGE: 5 LBS MIN

ROHS COMPLIANT

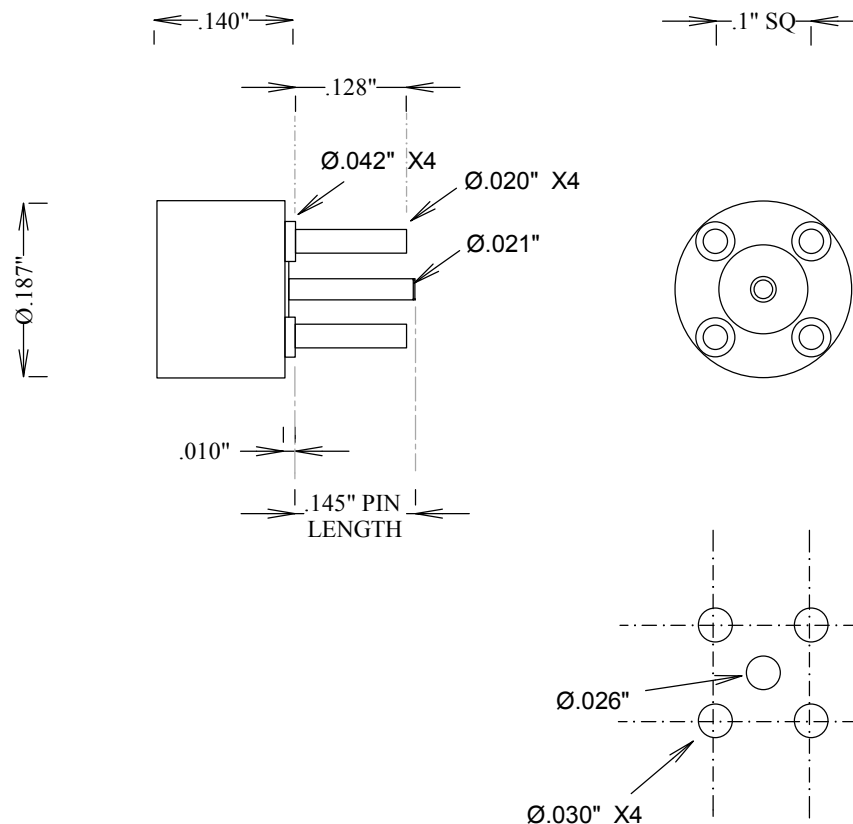

# FAIRVIEW MICROWAVE INC.

ALLEN, TX 75013 WWW.FAIRVIEWMICROWAVE.COM

TITLE

## SMP-MALE PCB R/A FULL DETENTE

SIZE

**A**

CAGE CODE

**3FKR5**

DWG NO

**SC5355**

REV

--

SCALE

SHEET