

ELECTRICAL SPECIFICATIONS

VSWR:	DC TO 4 GHz	<1.10
	4 TO 12.4 GHz	<1.20
	12.4 - 27 GHz	<1.35
IMPEDANCE		50 OHMS
TEMPERATURE RANGE (°C)		-55 TO +125
POWER (AVG)		2 WATTS**
POWER (PEAK)	($<5 \mu$ SEC PW, $<1\%$ DUTY CYCLE)	500 WATTS

**POWER DERATES LINEARLY FROM +45°C TO 10% @+125°C

MATERIALS

INNER CONDUCTOR: BERYLLIUM COPPER PER ASTM B196 & B197.

OUTER CONDUCTOR: STEEL, CORROSION RESISTANT PER ASTM A484 & A582, CLASS 303, COND. A.

DIELECTRIC: TEFLON PER ASTM D1710.

FINISH

INNER CONDUCTOR: GOLD PLATED PER MIL-PRF-39012.
HOUSING/COUPLING NUT FINISH PER SUFFIX (REPLACING -0X IN PN)

- 00 OUTER CONDUCTOR/NUT GOLD PLATED
- 02 OUTER CONDUCTOR/NUT PASSIVATED SS
- 01 OUTER CONDUCTOR GOLD PLATED, NUT PASSIVATED SS
- ADD C25 FOR 2-2.5" CHAIN ATTACHED

CONNECTOR INTERFACE COMPLIES WITH MIL-PRF-39012 AND MIL-STD-348 FOR SMA MATING CHARACTERISTICS. HIGH FREQUENCY (27 GHz) DESIGN.

PRODUCTION RELEASE

NOTE:
THIS DRAWING INCORPORATES THIRD ANGLE PROJECTION.
INTERPRET IAW ANSI Y14.5-1995

REVISIONS

REV	DESCRIPTION	APPROVED
B	ADDED .093 CHAIN AND INCREASED FREQ. TO 27 GHz	04/27/2011 D. Saunders

2001-7028-0X-C25

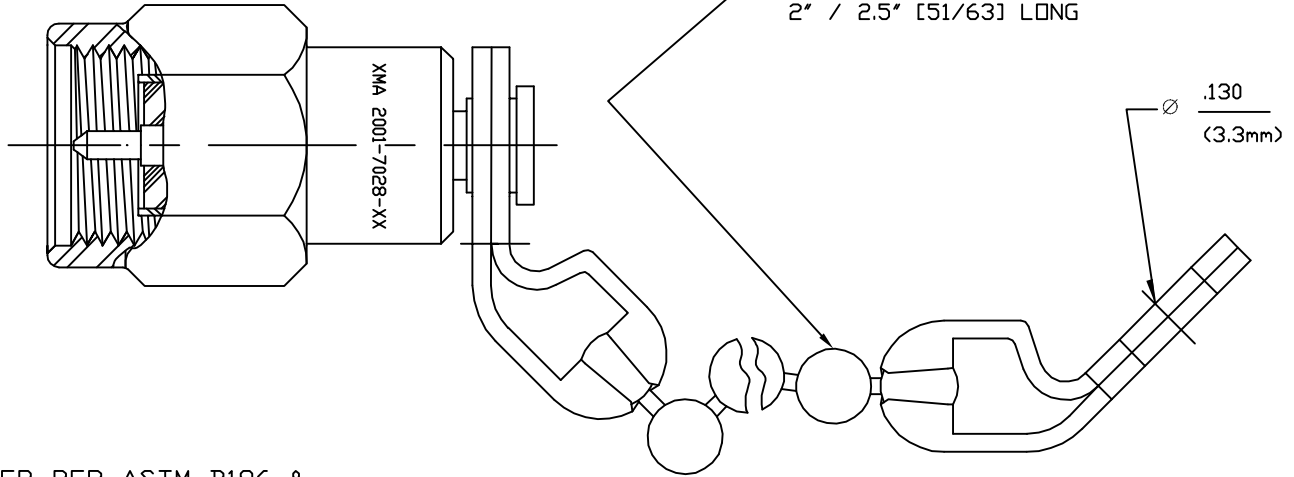

2001-7028-0X

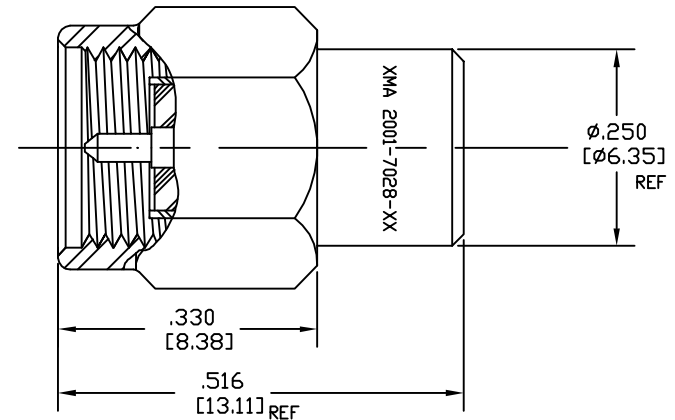

WWW.XMACorp.com Sales@XMACorp.com

XMA Powered by: **Omni Spectra®**

XMA Corp. 150 Dow St. Manchester, NH 03045 (603) 222-2256 fax 222-2259

TITLE
SMA Termination
27 GHz

SIZE	CAGE CODE	DWG NO.
C	3HT76	2001-7028-XX
SCALE	8:1	SHEET 1 OF 1

DRAWING PRACTICES PER ANSI Y14.5 MIL-STD-883 & 1000	UNLESS OTHERWISE SPECIFIED TOLERANCES IN DECIMALS INCH MM	DRAWN D. SAUNDERS	DATE 01/14/2010
DIMENSIONS ARE IN INCHES AND APPLY BEFORE/AFTER PROCESSING	.XX" .1" [2.6]	CHECKED	DATE
SURFACE ROUGHNESS	.XXX" .050" [1.3]	ENG. D. SAUNDERS	DATE 01/14/2010
FINISH	.XXXX" .03 [.76]	THESE DRAWINGS AND SPECIFICATIONS ARE THE PROPERTY OF XMA CORP. / OMNI SPECTRA AND SHALL NOT BE REPRODUCED, COPIED, NOR USED - IN WHOLE OR IN PART - AS A BASIS FOR THE DESIGN, MANUFACTURE OR SALE OF OTHER ITEMS WITHOUT THE EXPRESS WRITTEN PERMISSION OF XMA CORP. CUSTOMERS AND VENDORS MAY COPY FOR INTERNAL REVIEW USE AS NEEDED	
ANGLES	REMOVE ALL BURRS UNLESS OTHERWISE NOTED. DIA'S CONCENTRIC <.003 T.I.R.		
SEE NOTES			
MATERIAL			
SEE NOTES			