

Coaxial Directional Coupler

ZNDC-15-2G+

50Ω 15dB 800 to 2000 MHz

Maximum Ratings

Operating Temperature	-55°C to 100°C
Storage Temperature	-55°C to 100°C
Power input	3W Max.
Permanent damage may occur if any of these limits are exceeded.	

Coaxial Connections

INPUT	1
OUTPUT	2
COUPLED	3

Outline Drawing

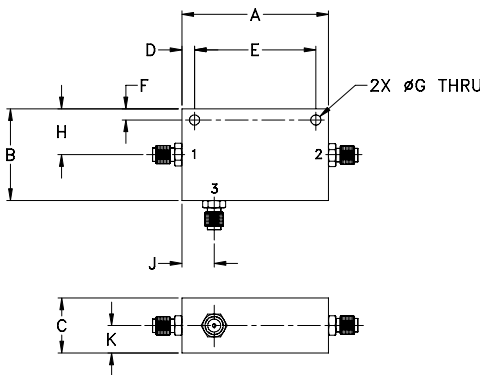

Outline Dimensions (inch/mm)

A	B	C	D	E	F	G	H	J	K	wt
2.00	1.25	0.75	0.17	1.656	0.15	0.14	0.63	0.44	0.38	grams
50.80	31.75	19.05	4.32	42.06	3.81	3.56	16.00	11.18	9.65	57.0

Features

- excellent mainline loss, 0.7 dB typ.
- very flat coupling ± 0.2 dB typ.

Applications

- cellular
- PCS
- ISM



CASE STYLE: FM587

Connectors	Model	Price	Qty.
SMA	ZNDC-15-2G-S+	\$49.95	(1-9)

+RoHS Compliant

The +Suffix identifies RoHS Compliance. See our web site for RoHS Compliance methodologies and qualifications

Directional Coupler Electrical Specifications

FREQ. RANGE (MHz)	COUPLING (dB)		MAINLINE LOSS (dB)		DIRECTIVITY (dB)		VSWR (:1)	POWER INPUT (W)
	Nom.	Max. Flatness	Typ.	Max.	Typ.	Min.		
800-2000								
800-1000	15.2 \pm 0.5	\pm 0.3	0.6	0.9	25	17	1.2	3
1000-1700	15 \pm 0.5	\pm 0.3	0.8	1.2	22	17	1.2	3
1700-2000	15 \pm 0.5	\pm 0.3	0.8	1.3	18	14	1.3	3

Typical Performance Data

Frequency (MHz)	Mainline Loss (dB) In-Out	Coupling (dB) In-Cpl	Directivity (dB)	Return Loss (dB)		
				In	Out	Cpl
800.00	0.61	15.05	21.82	16.76	16.78	17.94
900.00	0.61	15.02	24.69	17.99	18.24	19.75
1000.00	0.62	14.98	28.62	19.41	19.78	21.74
1100.00	0.65	14.95	35.07	20.93	21.42	24.05
1300.00	0.70	14.89	35.05	24.28	25.40	30.01
1500.00	0.76	14.85	25.86	27.83	28.00	27.12
1700.00	0.83	14.83	20.93	29.58	26.43	21.76
1800.00	0.93	14.90	18.71	28.87	25.74	19.68
1900.00	0.95	14.89	18.39	29.56	22.52	17.83
2000.00	0.96	14.87	16.73	31.44	22.01	16.30

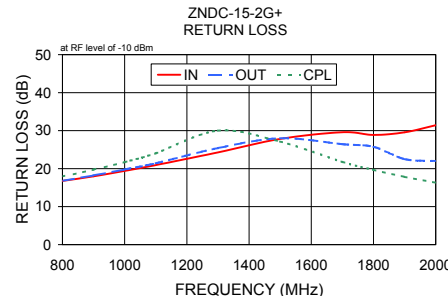
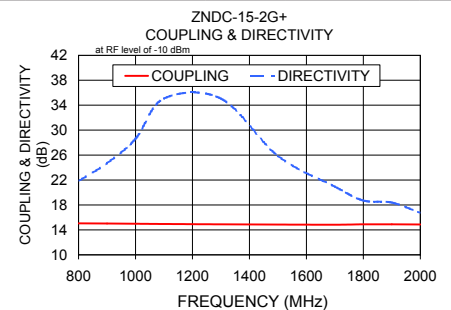
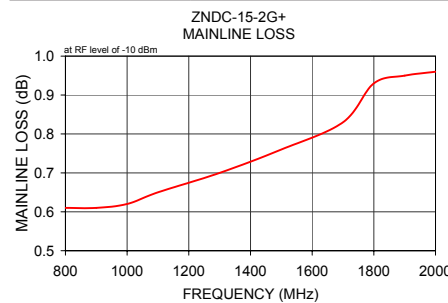

Electrical Schematic

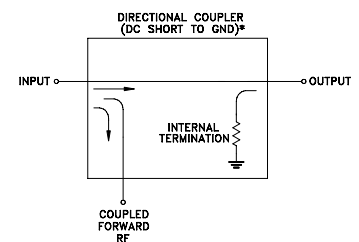

* ELECTRICAL SCHEMATIC IS FOR DIRECTIONAL COUPLER WITH INTERNAL TRANSFORMERS THAT ROUTES DC FROM RF PORTS TO GROUND.

Notes

- Performance and quality attributes and conditions not expressly stated in this specification document are intended to be excluded and do not form a part of this specification document.
- Electrical specifications and performance data contained in this specification document are based on Mini-Circuit's applicable established test performance criteria and measurement instructions.
- The parts covered by this specification document are subject to Mini-Circuits standard limited warranty and terms and conditions (collectively, "Standard Terms"); Purchasers of this part are entitled to the rights and benefits contained therein. For a full statement of the Standard Terms and the exclusive rights and remedies thereunder, please visit Mini-Circuits' website at www.minicircuits.com/WCLStore/terms.jsp

