

ADAPTERS, IN-SERIES

SMA, DC-18 GHz, Bulkhead Mount

SPECIFICATIONS:

Models: 5205, 5205/AU

RoHS
Compliant

Electrical:

Frequency Range _____ DC - 18.0 GHz
VSWR
DC - 4 GHz _____ 1.05:1 Max.
4 - 8 GHz _____ 1.10:1 Max.
8 - 18 GHz _____ 1.15:1 Max.
Nominal Impedance _____ 50 Ohms
Operating Temp Range _____ -55°C to +125°C

Mechanical:

Connectors _____ See Below
Mates with MILSTD-348
Conductors _____ Gold Plated Beryllium Copper
Nut & Washer: _____ Passivated Stainless Steel

AEROFLEX
A passion for performance.

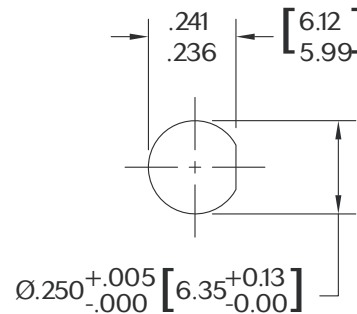

Recommended
Mounting Hole

Model Number: **5205**

Connectors _____ Passivated Stainless Steel

Model Number: **5205/AU**

Connectors _____ Gold Plated Stainless Steel

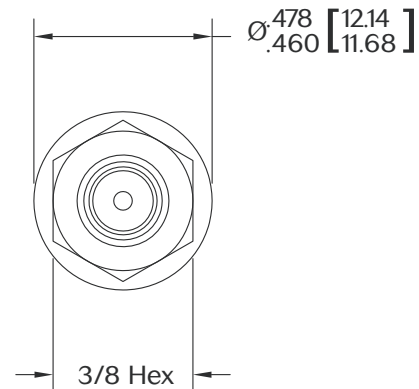
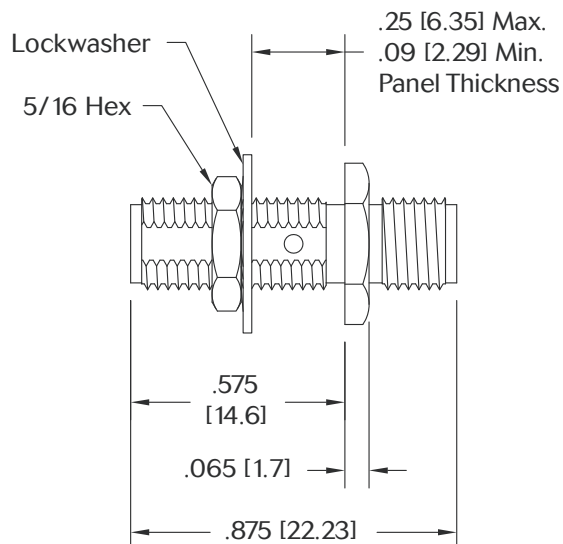

Panel Nut, Lock Washer & O-Ring are Shipped Unassembled

Note: Dimensions in Brackets are Expressed in Millimeters and are for Reference Only.
Design, specifications are subject to change without notice. Contact factory for technical specifications before purchasing and/or use.

5205 REV G

AEROFLEX
INMET

Aeroflex / Inmet, Inc. • 300 Dino Drive, Ann Arbor, MI 48103 • U.S.A.
888-244-6638 or 734-426-5553 • FAX: 734-426-5557
www.aeroflex.com/inmet • inmet@aeroflex.com