

COAXIAL ATTENUATORS

50 and 100 WATTS

FREQUENCY RANGE: DC - 18.0 GHz
ATTENUATION RANGE: 3, 6, 10, 20, 30, 40
ATTENUATION ACCURACY
 3, 6 dB: +/- 0.75 dB
 10, 20 dB: +/- 1.00 dB
 30 dB: +/- 1.25 dB
 40 dB: +/- 1.50 dB
INPUT POWER(@ 25 C): 50 WATTS AVG.
 (@ 125 C): 10 WATTS
PEAK POWER: 500 WATTS MAX.
OPERATING TEMP RANGE: -65 C TO +125 C
CONNECTORS: SMA
CONNECTOR BODY: Passivated
 Stainless Steel
CONDUCTORS: Gold Plated
 Beryllium Copper

MODEL NUMBER	FREQUENCY RANGE	VSWR (MAX.)	INPUT POWER @ 25 C
CS502-X	DC - 2.0 GHz	1.25:1	50 WATTS
CS504-X	DC - 4.0 GHz	1.25:1	50 WATTS
CS508-X	DC - 8.0 GHz	1.35:1	50 WATTS
CS5012-X	DC - 12.0 GHz	1.35:1	50 WATTS
CS5018-X	DC - 18.0 GHz	1.45:1	50 WATTS

REPLACE "X" WITH THE REQUIRED ATTENUATION VALUE.
 ADD "M" FOR SMA MALE CONNECTORS. EX: CS502-30/M
 ADD "F" FOR SMA FEMALE CONNECTORS. EX: CS5012-20/F

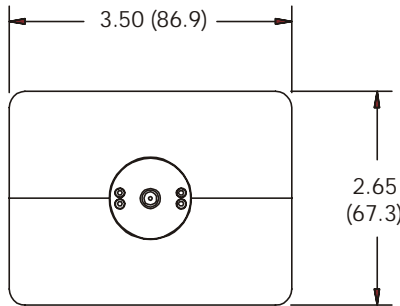

END VIEW

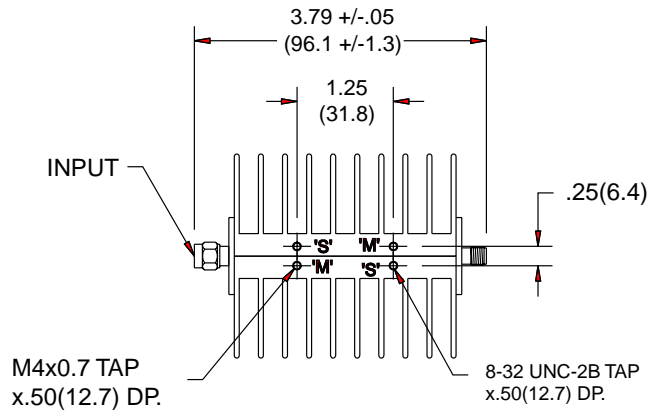

FREQUENCY RANGE: DC - 6.0 GHz
ATTENUATION RANGE: 3, 6, 10, 20, 30, 40 dB
ATTENUATION ACCURACY
 3, 6 dB: +/- 0.75 dB
 10, 20 dB: +/- 1.00 dB
 30, 40 dB: +/- 1.00 dB
INPUT POWER(@ 25 C): 100 WATTS AVG.
 (@ 125 C): 20 WATTS
PEAK POWER: 5 kW MAX.
OPERATING TEMP RANGE: -54 C TO +125 C
CONNECTORS: SMA
CONNECTOR BODY: Passivated
 Stainless Steel
CONDUCTORS: Gold Plated
 Beryllium Copper

MODEL NUMBER	FREQUENCY RANGE	VSWR (MAX.)	INPUT POWER @ 25 C
CS1002-X	DC - 2.0 GHz	1.25:1	100 WATTS
CS1004-X	DC - 4.0 GHz	1.35:1	100 WATTS
CS1006-X	DC - 6.0 GHz	1.35:1	100 WATTS

REPLACE "X" WITH THE REQUIRED ATTENUATION VALUE.
 ADD "M" FOR SMA MALE CONNECTORS. EX: CS2018-30/M
 ADD "F" FOR SMA FEMALE CONNECTORS. EX: CS208-20/F

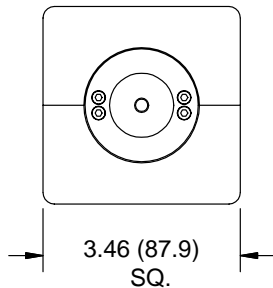

END VIEW

